

THIS COPY IS PROVIDED ON A RESTRICTED BASIS AND IS NOT TO BE USED IN ANY WAY DETRIMENTAL TO THE INTERESTS OF PANDUIT CORP.

PANDUIT PART NUMBER	PACKAGE QUANTITY	MAX BUNDLE DIA [mm]	LENGTH (B) "L" +/- .3 [8]	MARKING "XXX SS"
MS4W75T30-Q6	25	4" [102]	19.6" [498]	316 SS
MS6W75T30-Q6	25	6" [152]	25.9" [658]	316 SS
MS8W75T30-Q6	25	8" [203]	32.1" [815]	316 SS
MS10W75T30-Q6	25	10" [254]	38.4" [975]	316 SS
MS12W75T30-Q6	25	12" [305]	44.7" [1135]	316 SS
MS14W75T30-Q6	25	14" [356]	50.1" [1273]	316 SS

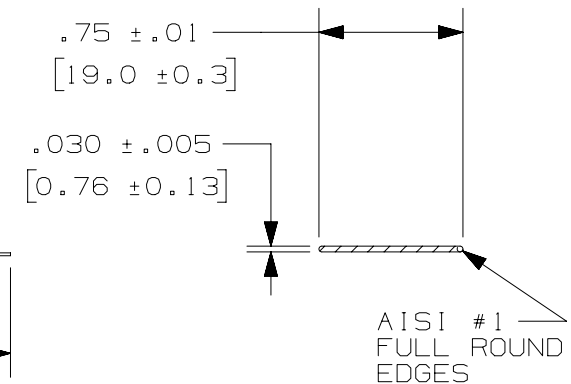
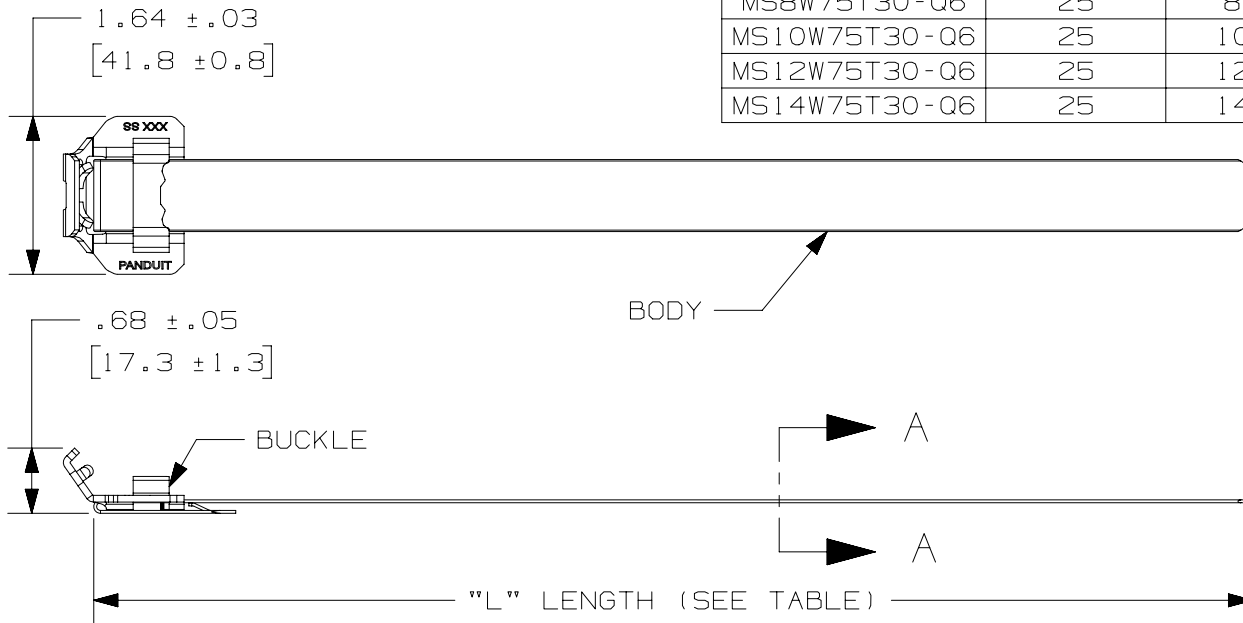

- NOTES:
- APPLICATION TOOLS: BT75SDT, BT2HT1
 - ALL DIMENSIONS IN BRACKETS [] ARE MILLIMETERS
 - MATERIAL: 316L STAINLESS STEEL
 - MAX BUNDLE DIA FOR SINGLE LOOP APPLICATIONS.
FOR DOUBLE LOOP APPLICATIONS, DIVIDE MAX BUNDLE DIA VALUE BY 2
FOR TRIPLE LOOP APPLICATIONS, DIVIDE MAX BUNDLE DIA VALUE BY 3

REV	DATE	BY	CHK	APR	DESCRIPTION	ECN
06A	01-28-20	ACC	GBI	ADAH	C. UPDATED NOTE 3 AND MATERIAL TO "316L STAINLESS STEEL"	131359/00
05A	05-13-19	BWG	JADE	JADE	B. REVISED "L" DIMENSION LEADER LOCATION, CHART AND NOTE 4. REVISED TITLE. SEE ECN DOCUMENT FOR COMPLETE DETAILS.	046621/01
04A	05-10-19	JEH	JADE	JADE	A. CORRECTED THE "L" LENGTH SHOWN IN THE FRONT VIEW	046621
03A	06-19-18	RUMO	RGR0	RGR0	MODIFIED COMPONENT SHAPE; HEIGHT WAS .72 ± .03	037873
02	01-23-17	JBN	SKB	RGR0	ADDED MS14W75T30-Q6 TO THE CHART	N4131BS-DC
01A	08-01-13	ACC	RGR0	RGR0	ADDED MS4W75T30-Q6, MS6W75T30-Q6, MS8W75T30-6, AND MS12W75T30-Q6 TO THE CHART	SSECN1069
00A	02-13-13	ACC	RGR0	RGR0	DRAWING REVISION	XXXXXX

PART NUMBER		SEE TABLE		
TITLE		MS75 DISCRETE LENGTH TIE .75" [19.0] WIDE		
ITEM REVISION NAME		CUSTOMER DRAWING		
DATASET FILE NAME		N4131BS/06		
		N4131BS_DC/06A		
MATERIAL		SEE NOTES		
DRAWING NUMBER		N41311BS_DC		
DRAWN BY	DATE	CHK	SCALE	SIZE
JAMB	02-13-13	SKB	NONE	A
SHEET 1 OF 1				

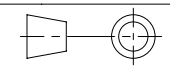

THIRD ANGLE PROJECTION

A-SIZE CUSTOMER