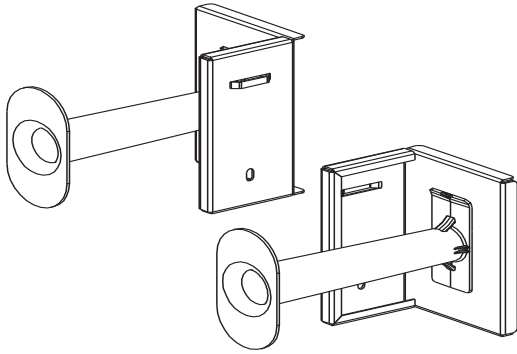
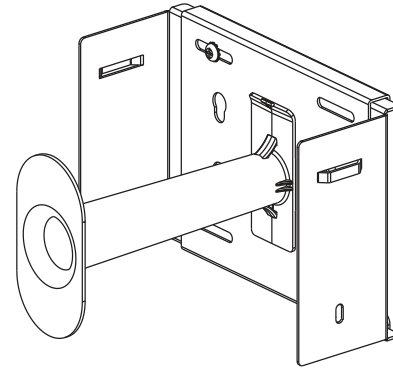

INSTRUCTIONS CM329A

© Panduit Corp. 2008

**CNSPE***NET-ACCESS End Spool Kit*

- (2) Brackets (1 Right, 1 Left)
- (2) Spools
- (1) Pack of Mounting Hardware

**CNSPCA***NET-ACCESS Center Spool Kit*

- (1) Center Bracket
- (1) Spool
- (1) Pack of Mounting Hardware

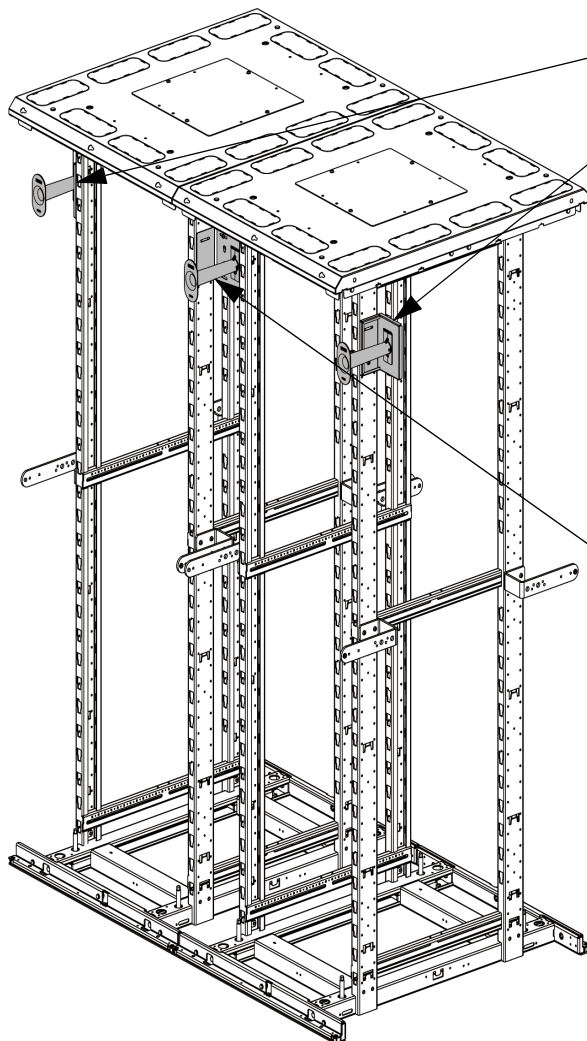
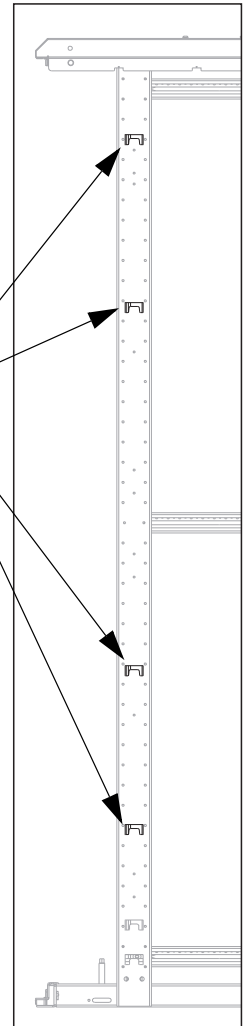
**CNSPE Installed****CNSPCA Installed****Mounting Locations**

Install the **CNSPCA** by choosing mounting location shown on Page 1. Loosen the (2) adjusting screws as shown in Figure 1 and slide the bracket between cabinet posts just above the desired mounting location until bridge lances are aligned in mounting location. Pull down and fasten with (2) #12-24 screws and washers provided as shown in Figure 2. Tighten the (2) adjusting screws on the bracket. Install the **CNSPE** in the desired mounting location by hooking bridge lance over tab and securing with #12-24 screw and washer provided as shown in Figure 3

Adjusting Screws

Bridge Lance

#12-24 Screws and Washers

#12-24 Screw and Washer

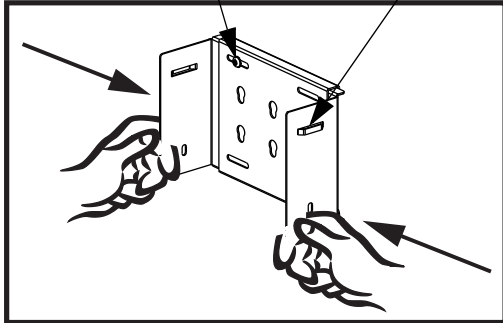

Figure 1

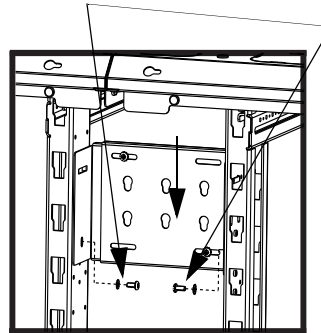

Figure 2

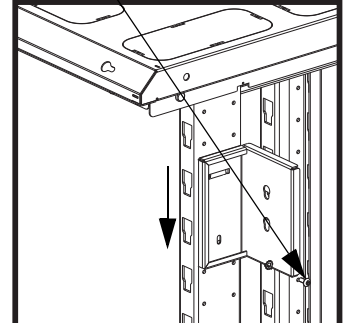
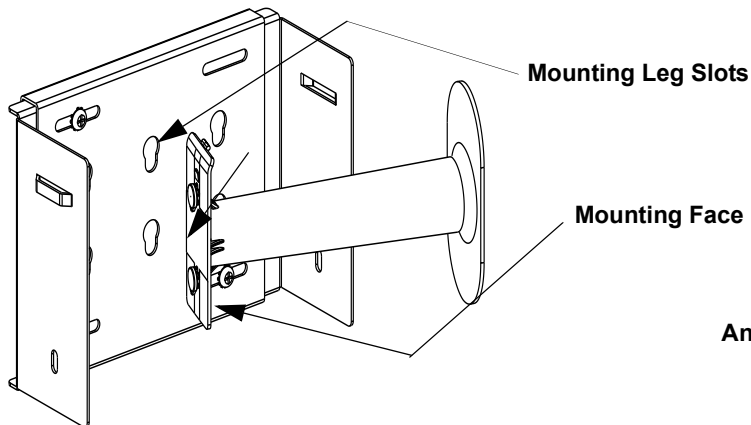

Figure 3

INSTALLATION OF SPOOLS

Step 1

Align buttons with mounting leg slot



Step 2

Push buttons through bracket until mounting face is flush with bracket.

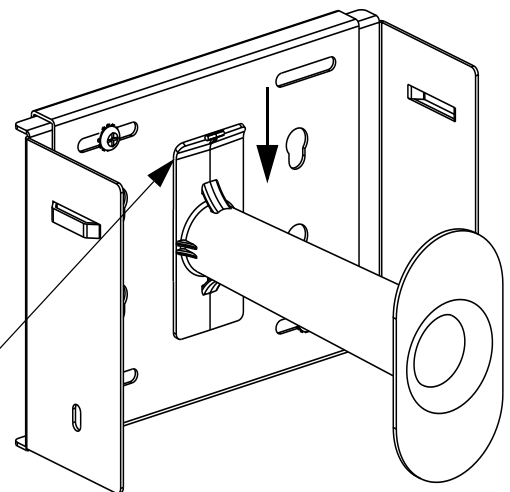
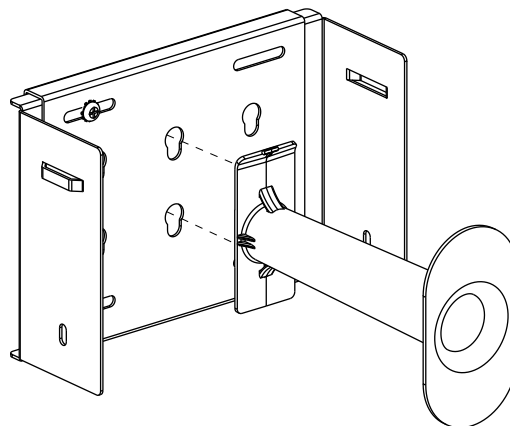

Step 3

Apply downward pressure until plastic spool clicks into place.

Removal/Replacement

Step 4

Pull back on angled flange while applying upward pressure

Step 5

Repeat steps 1-3

For instructions in Local Languages
and Technical Support:

www.panduit.com/resources/install_maintain.asp



www.panduit.com

E-mail:
cs@panduit.com
Fax:
(708)444-6448