

**NEW!** **StructuredGround™ Mechanical Connectors**

The ability to provide a grounding system that is both reliable and economical is dependent upon finding the right connectors for the application. Panduit offers grounding connectors for a wide variety of conductor combinations and mounting configurations in high strength electrolytic copper, aluminum and bronze alloy materials.

Globally distributed StructuredGround™ Mechanical Connectors provide fast and easy terminating of ground conductors to water pipe, ground rods, conduit, iron pipe, and structural steel for highest reliability and lowest installed cost. With the addition of new split bolt quad clamps and lay-in lugs to the existing line of StructuredGround™ Mechanical Connectors, Panduit delivers the breadth of line to supply the right connector for each unique job providing maximum reliability and safety for all critical electrical connections throughout your physical infrastructure.



**Key Features**

**Benefits**

<b>UL/cULus Listed and CSA Certified</b>	Satisfies grounding specification requirements for safety and reliability
<b>Made from high strength electrolytic copper, aluminum or bronze, and available with tin-plating</b>	Creates optimum conductivity resulting in reliable, high quality connections
<b>Broad selection of grounding connectors</b>	Allows consolidation to one supplier, lowering procurement costs
<b>Local product support available on a global basis</b>	Provides worldwide product availability and expertise for consistent, rapid deployment
<b>Wire range-taking capability</b>	Minimizes inventory requirements, saves cost
<b>Installed with standard screwdrivers and hex wrenches</b>	Saves cost on special tooling

**Applications**



Oil and Gas



Industrial Facilities



Solar Power



Construction

# StructuredGround™ Mechanical Connectors



## Split Bolt Quad Clamp, Bronze

- Split bolt design allows easy insertion of perpendicular conductors to speed installation
- UL 467 Listed and CSA Certified for direct burial in earth or concrete
- UL Listed and CSA Certified for use up to 600 V and temperature rated 90°C
- Each clamp accepts up to two conductors for a high performance bond with faster installation
- Wire range-taking capability minimizes inventory requirements, saves cost
- Made from high strength, electrolytic bronze to provide reliable grounding connections

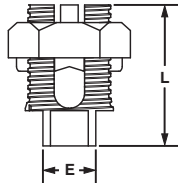
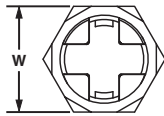

Part Number	Conductor Size Range	Figure Dimensions In.			Tightening Torque In.-Lbs.	Std. Pkg. Qty.
		E	W	L		
SBQC1/0-X	#6-1/0 AWG	0.75	1.50	2.00	#6 – #4 AWG – 165 #3 – #1 AWG – 275 1/0 AWG – 385	10



## One-Hole Grounding Lay-in Lug

- Used for quick installation of a continuous grounding conductor
- UL 467 Listed for grounding and bonding, copper lugs UL Listed for direct burial in earth or concrete
- UL Listed for use up to 600 V and temperature rated 90°C
- Wire range-taking capability minimizes inventory requirements, saves cost



Copper



Tin-Plated Copper



Aluminum

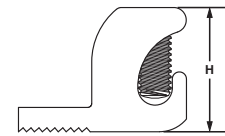
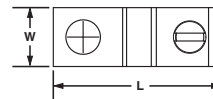

Part Number	Set Screw Material	Conductor Size Range	Stud Hole Size (In.)	Hex Key Size (In.)	Figure Dimensions (In.)			Std. Pkg. Qty.
					L	W	H	
<b>Copper Body</b>								
LICC4-22-C	Stainless Steel	#14 AWG – #4 AWG	0.22	**	1.16	0.39	0.87	100
<b>Tin-Plated Copper Body</b>								
LICC4-22TP-C	Stainless Steel	#14 AWG – #4 AWG	0.22	**	1.16	0.39	0.87	100
<b>Tin-Plated Aluminum Body</b>								
LIAC4-22-C	Stainless Steel	#14 AWG – #4 AWG	0.22	**	1.06	0.39	0.78	100
LIAS1/0-14-L	Zinc Plated Steel	#14 AWG – 1/0 AWG	0.27	**	1.50	0.61	1.10	50
LIAS250-56-Q*	Zinc Plated Steel	#6 AWG – 250 kcmil	0.33	1/4	2.20	0.80	1.70	25

\*UL pending.

\*\*Uses slotted head set screw.

The use of Panduit oxide inhibiting joint compound (CMP) is recommended for pad and conductor connections. For the complete line of StructuredGround™ Mechanical Connectors visit [www.panduit.com/groundingsystem](http://www.panduit.com/groundingsystem)

### WORLDWIDE SUBSIDIARIES AND SALES OFFICES

PANDUIT CANADA  
Markham, Ontario  
cs-cdn@panduit.com  
Phone: 800.777.3300

PANDUIT EUROPE LTD.  
London, UK  
cs-emea@panduit.com  
Phone: 44.20.8601.7200

PANDUIT SINGAPORE PTE. LTD.  
Republic of Singapore  
cs-ap@panduit.com  
Phone: 65.6305.7575

PANDUIT JAPAN  
Tokyo, Japan  
cs-japan@panduit.com  
Phone: 81.3.6863.6000

PANDUIT LATIN AMERICA  
Guadalajara, Mexico  
cs-la@panduit.com  
Phone: 52.33.3777.6000

PANDUIT AUSTRALIA PTY. LTD.  
Victoria, Australia  
cs-aus@panduit.com  
Phone: 61.3.9794.9020

For a copy of Panduit product warranties, log on to [www.panduit.com/warranty](http://www.panduit.com/warranty)

For more information

Visit us at [www.panduit.com](http://www.panduit.com)

Contact Customer Service by email: [cs@panduit.com](mailto:cs@panduit.com)  
or by phone: 800.777.3300 and reference SA-GRCB04



©2011 Panduit Corp.  
ALL RIGHTS RESERVED.  
Printed in the U.S.A.  
Product Bulletin Number SA-GRCB04  
7/2011