

THIS COPY IS PROVIDED ON A RESTRICTED BASIS AND IS NOT TO BE USED IN ANY WAY DETRIMENTAL TO THE INTERESTS OF PANDUIT CORP.

NOTES:

- IDENTIFICATION: VERTICAL, (24) 5-20R, METERED  
120V / 30A / THREE-PHASE WYE POU
- | PART NO.      | COLOR |
|---------------|-------|
| VB1A1P3BN24E1 | BLACK |
- ACCESSORY COMPONENTS:  
(4) #10-32 x 1/2" MOUNTING SCREWS  
(4) #12-24 x 1/2" MOUNTING SCREWS  
(2) #10-32 LOCKING COLLAR SCREWS  
(2) L-BRACKETS
  - DIMENSIONS IN PARENTHESES ARE METRIC (mm).
  - CURRENT METER - RED, 4-DIGIT LED DISPLAY PROVIDES TRUE RMS CURRENT THAT CONTINUOUSLY SCROLLS THROUGH THE THREE DIFFERENT MEASURED CIRCUITS. METER DISPLAYS CIRCUIT NAME FOLLOWED BY THE MEASURED CURRENT (E.G. CR-1 REPRESENTS PHASE 1).
  - RECEPTACLES ARE COLOR CODED PER PHASE FOR EASY IDENTIFICATION AND LOAD BALANCING.
  - UL® & c-UL® LISTED 60950.
  - RoHS COMPLIANT.
  - VISIT OUR ON-LINE CATALOG AT WWW.PANDUIT.COM FOR A CURRENT LIST OF PRODUCTS APPLICABLE FOR USE WITH THIS PART.
  - MAXIMUM AVAILABLE INPUT POWER = 8.6 KW
  - INSTALLATION SHALL COMPLY WITH ALL APPLICABLE NATIONAL, STATE, AND LOCAL CODES.

PANDUIT P/N	WEIGHT
VB1A1P3BN24E1	17 lb (7.7 kg)

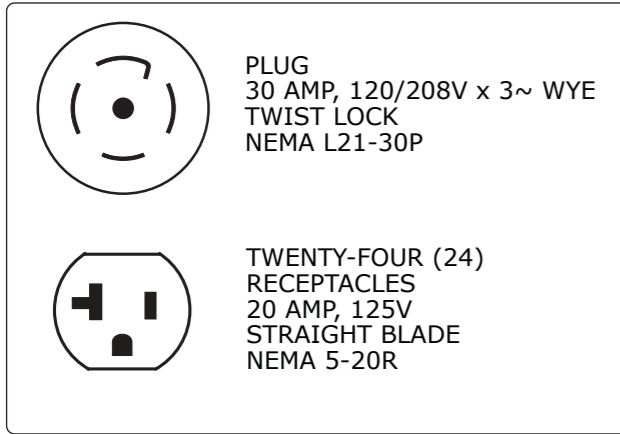
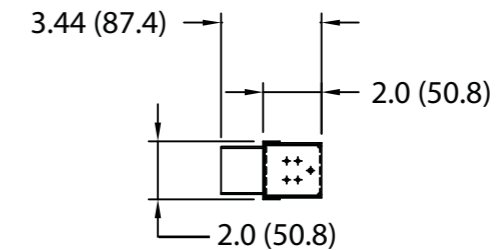
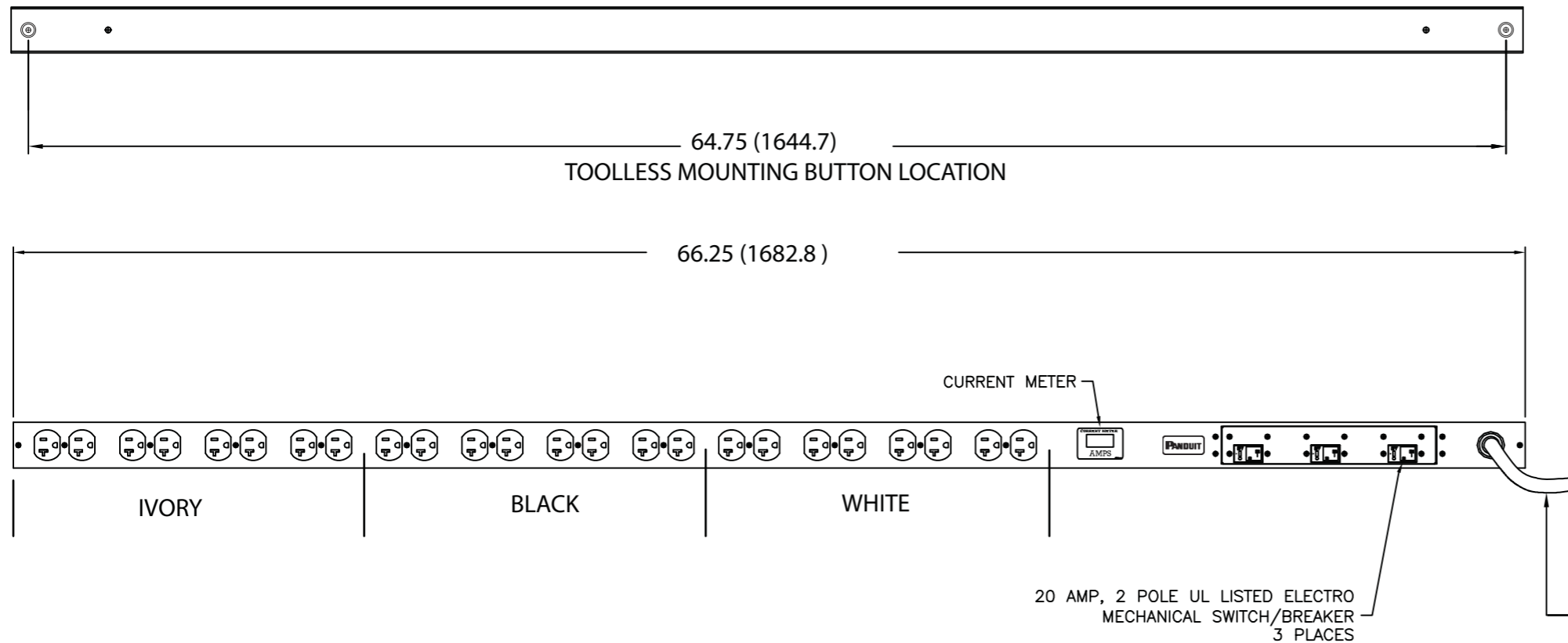

REV	DATE	BY	CHK	DESCRIPTION	ECN	R	CUST	SUP	OTH
01A	8-7-12	PIP	MRWA	B. UPDATED NOTE #9. C. ADDED NOTE #10.	09V098EE				
00B	1-31-11	MAV	KRKE	A. ADDED MAXIMUM AVAILABLE POWER	09V098EE				
00A	10-15-10	MAV	KRKE	RELEASED TO PRODUCTION	09V098EE				

MODEL FILENAME	09V098EE/01.PRT
CAD FILENAME/LAYERS	09V098EE_DC/01A.PRT
<b>PANDUIT</b> CORP TINLEY PARK, ILLINOIS	
VERTICAL, (24) 5-20R, METERED POWER OUTLET UNIT (VB1A1P3BN24E1) CUSTOMER DRAWING	
UNLESS OTHERWISE SPECIFIED, DIMENSIONAL TOLERANCES ARE: INCHES    +/- 0.03    [METRIC - MILLIMETER]    ANGLE X.X       +/- 0.015    X.X       +/- 0.4       +/- 1° X.XXX    +/- 0.005    X.XX      +/- 0.13	
UNLESS OTHERWISE SPECIFIED, ALL DIMENSIONS ARE GIVEN IN INCHES, THIRD ANGLE PROJECTION	SCALE    NONE
DRAWN BY MAV	MAT'L:
DATE 10-15-10	DWG B
CHK'D KRKE	SIZE
DRAWING NO. 09V098EE	