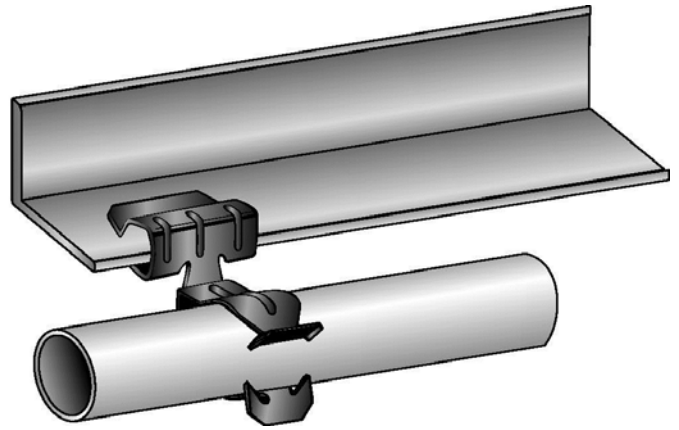
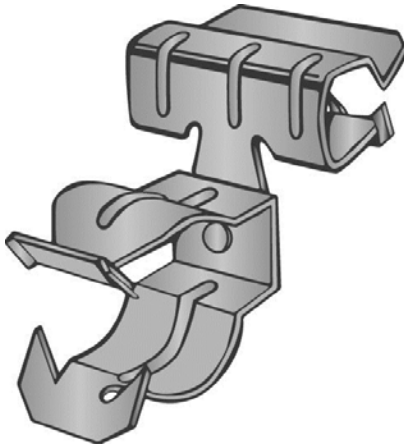

Part Number: P12P58SM

Product Description: BEAM CLAMP FOR 5/16" - 1/2" FLANGE WITH 3/4" PUSH FIT CONDUIT CLIP - SIDE MOUNT

**Material Specifications**

Type: Assembly

Finish: Assembly

Color: Various

Function Specifications**Compatible Wires and Cables**

AC/MC CABLE (OD):

Drop Wire:

Plain Rod (in):

| |
|--|
| |
| |
| |

Threaded Rods and Bolts

Tapped Holes:

Clearance Holes (in):

Threaded Rod Size (in):

| |
|--|
| |
| |
| |

Compatible Conduit

EMT Size (in): 3/4

Rigid/IMC (in): 1/2

| |
|--|
| |
| |

Compatible Flanges and Studs

Flange Size (in): 5/16 to 1/2

Metal Stud Size (ins):

| |
|--|
| |
| |

Static Load Rating

Vertical (lbs): 15

Horizontal (lbs):

| |
|--|
| |
| |

Other

| |
|--|
| |
|--|

Codes and RegulatoryRegulatory
Certifications:

| |
|---|
| - |
|---|

Country of Origin: US

| |
|--|
| |
|--|

Packaging

General Packaging: Cardboard Box

Box Size: 11 X 7.5 X 7.25

| |
|--|
| |
| |

Pieces per Package: 100

Other Box Features:

| |
|--|
| |
| |

Document Information

Created By: DBLA

Checked By: DJW

Approved By: KLN

| |
|--|
| |
| |
| |

Customer Specification #: C11346

Revision Level: 01

ECN #: GAECN01482

Date: 12/10/2013

| |
|--|
| |
| |
| |
| |