

2

1

THIS COPY IS PROVIDED ON A RESTRICTED BASIS AND IS NOT TO BE USED IN ANY WAY DETRIMENTAL TO THE INTERESTS OF PANDUIT CORP.

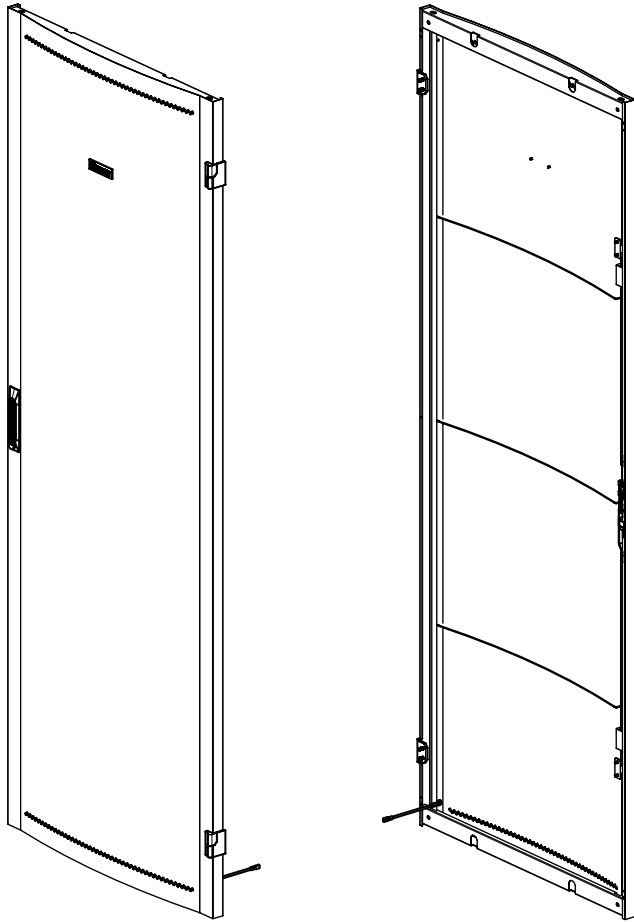

PANDUIT PART NO.	DESCRIPTION	WEIGHT
D62FDE*	D-TYPE FRONT DOOR ENHANCED 600mm WIDE X 42RU	16.5 Kg/EACH (36.38 LBS/EACH)
D65FDE*	D-TYPE FRONT DOOR ENHANCED 600mm WIDE X 45RU	17.0 Kg/EACH (37.48 LBS/EACH)
D68FDE*	D-TYPE FRONT DOOR ENHANCED 600mm WIDE X 48RU	17.5 Kg/EACH (38.58 LBS/EACH)
D82FDE*	D-TYPE FRONT DOOR ENHANCED 800mm WIDE X 42RU	20.5 Kg/EACH (45.19 LBS/EACH)
D85FDE*	D-TYPE FRONT DOOR ENHANCED 800mm WIDE X 45RU	21.0 Kg/EACH (46.30 LBS/EACH)
D88FDE*	D-TYPE FRONT DOOR ENHANCED 800mm WIDE X 48RU	21.5 Kg/EACH (47.40 LBS/EACH)

NOTE:  
 \* DENOTES COLOR - ADD SUFFIX  
 "B" FOR BLACK AND "W" FOR WHITE

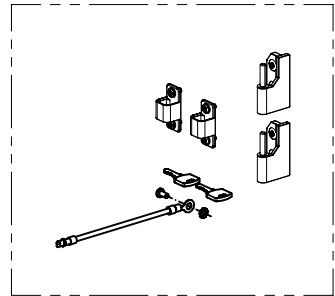

HARDWARE  
(PACKAGED)

- NOTES:
- VISIT OUR ON-LINE CATALOG AT [WWW.PANDUIT.COM](http://WWW.PANDUIT.COM) FOR A LIST OF CURRENT PARTS APPLICABLE FOR USE WITH THIS PRODUCT.
  - PRIMARY DIMENSIONS ARE IN MILLIMETERS (mm).
  - PARTS SUPPLIED:  
 (1) - FRONT DOOR  
 (1) - HARDWARE KIT:  
 HINGES,  
 GROUNDING WHIPS  
 MOUNTING HARDWARE  
 (1) - INSTRUCTION SHEET

B

B

A

A

TITLE		<b>D-TYPE FRONT DOOR ENHANCED D**FDE*</b>	
CUSTOMER DRAWING			
ITEM REVISION NAME	00568EAG/00	<b>PANDUIT</b>	
DATASET FILE NAME	00568EAG_DC/00A		
MATERIAL:		N/A	
DRAWING NUMBER:		00568EAG-DC	
THIRD ANGLE PROJECTION			
DRAWN BY	DATE	CHK	SCALE
MES	11-25-19	PATR	NONE
SHT 1 OF 2		A	

REV	DATE	BY	CHK	APR	DESCRIPTION	ECN
00A	11-25-19	MES	PATR	SJP	RELEASED TO PRODUCTION	V09002DP

2

1

D10.100DA/20

