

THIS COPY IS PROVIDED ON A RESTRICTED BASIS AND IS NOT TO BE USED IN ANY WAY DETRIMENTAL TO THE INTERESTS OF PANDUIT CORP.

NOTES :

1. UL LISTED AFTER HEAT SHRINKING FOR:
 - A. 600 V MAX. VOLTAGE RATING
 - B. TEMPERATURE RATING OF INSULATION: 125°C (257°F)
 - C. STRANDED COPPER WIRE ONLY (SEE CHART FOR WIRE RANGE)
2. MATERIAL :
 - A. CONNECTOR - TIN PLATED COPPER TUBE, BRAZED SEAM BSH10 ONLY
 - B. INSULATOR - HEAT SHRINKABLE POLYOLEFIN WITH HOT MELT SEALANT
3. MINIMUM SHRINK TEMPERATURE: 300°F (150°C)
4. ALL DIMENSIONS SHOWN ARE NOMINAL. DIMENSIONS IN BRACKETS ARE IN MILLIMETERS.
5. INSTALLATION TOOL: CT-310
6. WIRE STRIP LENGTH: 5/16 ^{+1/16}/₀
7. SEE www.panduit.com FOR PART NUMBER SUFFIX DESIGNATION FOR **PACKAGE SIZE**.

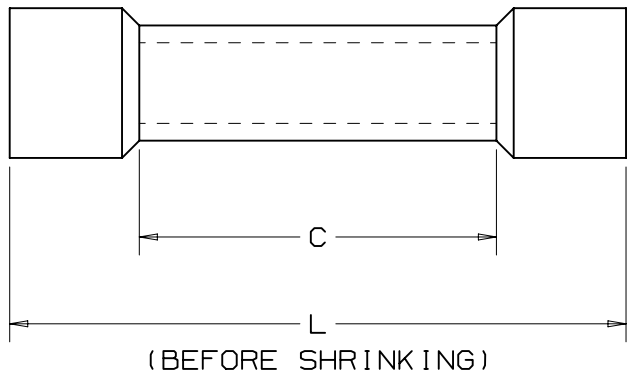

| PANDUIT PART NUMBER | WIRE RANGE (AWG) | DIMENSIONS | | MAX WIRE INSULATION DIA | INSULATION COLOR |
|---------------------|------------------|---------------|----------------|-------------------------|------------------|
| | | C | L | | |
| BSH18 | 22-18 | .58 (14,7) | 1.45 (36,8) | .170 (4,32) | RED |
| BSH14 | 16-14 | .58 (14,7) | 1.45 (36,8) | .190 (4,83) | BLUE |
| BSH10 | 12-10 | .74 (18,8) | 1.64 (41,7) | .240 (6,10) | YELLOW |



| REV | DATE | BY | CHK | APR | DESCRIPTION | ECN |
|-----|----------|------|------|------|--------------------------------------|--------|
| 05A | 7-14-23 | JHNU | JHNU | MRWA | A. REMOVED CSA SYMBOL | 132310 |
| 04 | 04-25-13 | JBN | RTFI | RTFI | UPDATED DRAWING BORDER & TITLE BLOCK | A41454 |

| | | | |
|---|------|------------------------------------|-------|
| TITLE | | HEAT SHRINK INSULATED BUTT SPLICES | |
| CUSTOMER DRAWING | | | |
| ITEM REVISION NAME | | N41454BA/05 | |
| DATASET FILE NAME | | N41454BA_DC/05A | |
| UNLESS OTHERWISE SPECIFIED, DIMENSIONAL TOLERANCES ARE: IN [mm] | | MATERIAL: | |
| .x ± .1 [2.54] .xxx ± .005 [.127] | | SEE NOTES | |
| .xx ± .01 [.25] ANGLES ± 5 ° | | DRAWING NUMBER: | |
| | | A41454 | |
| DRAWN BY | DATE | CHK | SCALE |
| DRL | - | RLS | NONE |
| SHT 1 OF 1 | | | SIZE |
| | | | A |

D10100DA/15