

Installation Guide: Replacement Controller Module – Vertical iPDU's

P/N: MA002 & MAG02

The replacement Controller Module is a hot-swappable unit that works with the Panduit SmartZone G5 iPDU series of intelligent power distribution units. It is the “brain” of the PDU that contains the most complicated and sensitive electronic sub-systems. It is designed for safe removal without disrupting power to the outlets.

Note: The replacement Control Modules are designed to connect to a SmartZone G5 iPDU only. Connecting it to another device may result in damage.

INVENTORY:



INSTALLATION INSTRUCTIONS

1. Remove all connections from the front of the existing Control module (Ethernet, Serial, Sensor, etc.) and document which port each of the RJ45 plugs were connected to as you will need to reconnect the wires to the same ports.
2. Using a T10 screwdriver, loosen the (2) screws securing the Control Module
3. Remove the Control Module from the PDU chassis
4. For Control Module removal – disconnect the Control module ribbon cable from the PDU chassis.

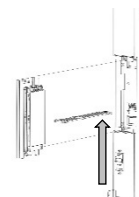
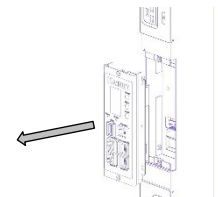
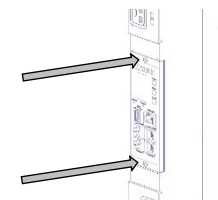
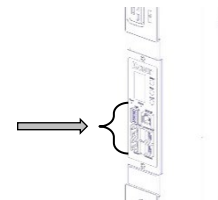

5. Plug the ribbon Cable into the replacement Controller module
6. Plug the replacement Controller module ribbon cable into the PDU
7. Install the replacement Control Module into the PDU chassis, while gently folding the ribbon cable being careful not to strain or kink any of the wires contained in the ribbon.
8. Using a T10 screwdriver, tighten the (2) screws securing the Control Module in place

Recommended tightening torque = 0.25 - 0.35 N m [2.2 – 3.1 Lb-in]

NOTE: Do not over tighten screws as this may cause metal deformation.

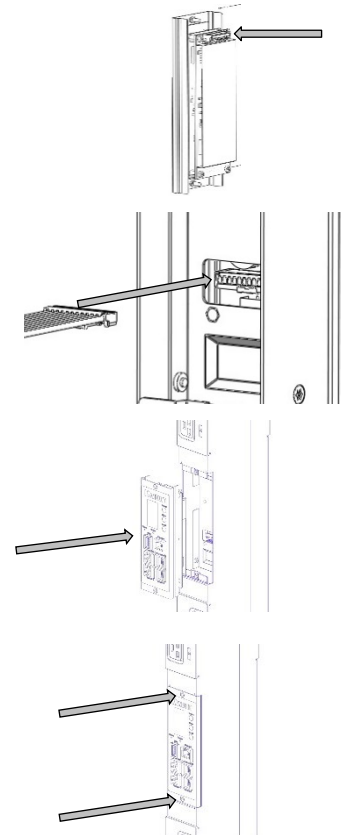

UPDATING THE FIRMWARE:

1. Please visit <http://www.panduit.com/pdu-support> for the most recent firmware version.
2. Options on how to upgrade the firmware can be found in the Panduit G5 iPDU User manual.

The Panduit iPDU Replacement Controller Module is installed, updated, and ready for use. For more information, please go to www.panduit.com