

High Fiber Count Cable Breakout Kit

specifications

The High Fiber Count Cable Breakout Kit shall take the high fiber count cable and allow the cable to be split into manageable sub groups. The expandable sleeve assemblies shall snap into the breakout kit and shall protect, manage, and easily route bare fibers from the high fiber count cable to other areas within cabinets and enclosures for splicing or distribution purposes. The breakout kits shall accept cable with outer diameter between 9mm-17mm and 16mm-28mm, depending on the part number. The box shall provide easy cable/fiber access due to a removable front panel.

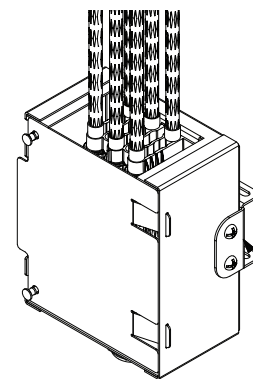

technical information

Dimensions:

Part Number	Accepts Cable within O.D. Range (mm)	Accepts Cable within O.D. Range (in)
FHDBRKOUT17	9mm – 17mm	(0.35" – 0.67")
FHDBRKOUT28	16mm – 28mm	(0.63" – 1.10")
FHDBRKOUT17 Dimension	7.2"H x 5.3"W x 3"D	
FHDBRKOUT28 Dimension	8.1"H x 5.3"W x 3"D	

Mounting options:

Panduit Universal Cable Management (Part Number: FLEX-CM-1UBKIT)
Bonus holes inside a cabinet
Power Distribution Unit Mounting Brackets

Ribbon Fiber:

Up to 2592 fibers (144 fibers per sleeve assembly, possible 18 positions for sleeve assemblies within the kit)

Single Fibers:

Up to 864 fibers (48 single fibers per sleeve assembly, possible 18 positions for sleeve assemblies within kit)

NB: Each breakout kit comes with (6) expandable sleeve assemblies. (6) Additional expandable sleeving assemblies can be ordered under the part number **FBKSL-M03-KIT**.

key features and benefits

Universal

Accept any fiber manufacturer's cable within the range of outer diameter defined above

Robust

Protect, house, and manage the furcation of both bare ribbon fiber and single fiber

Easy to deploy

Fast and easy deployment without need of special equipment

applications

The main application of the Breakout Kit is to serve as a point where high fiber count cables can be broken out into manageable groupings. These groupings are easy to route to splice areas for either ribbon fusion or single fiber splicing, depending on the cable type, within enclosures.

High Fiber Count Cable Breakout Kit

Fiber Breakout Kit 17

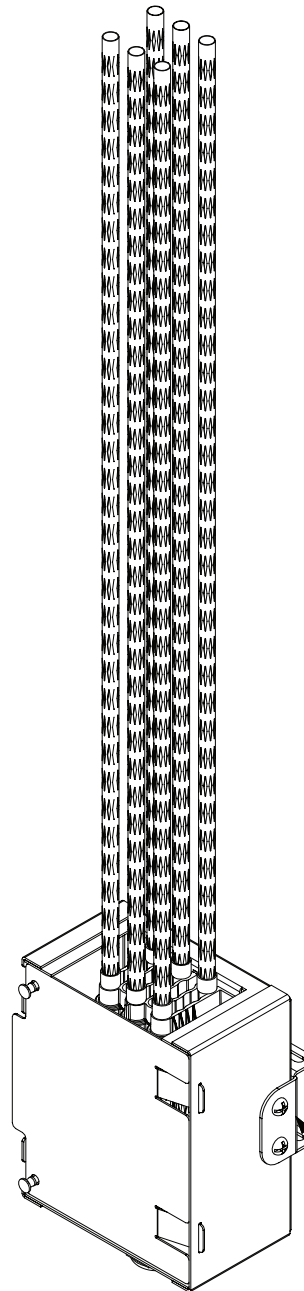
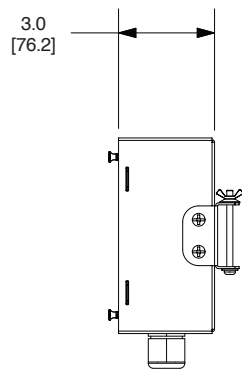
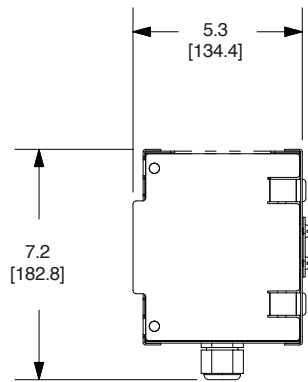

Mounting bracket made specifically for use with FLEX-CM-1UBKIT

Dimensions are in inches. [Dimensions in parenthesis are metric].

High Fiber Count Cable Breakout Kit

Fiber Breakout Kit 28

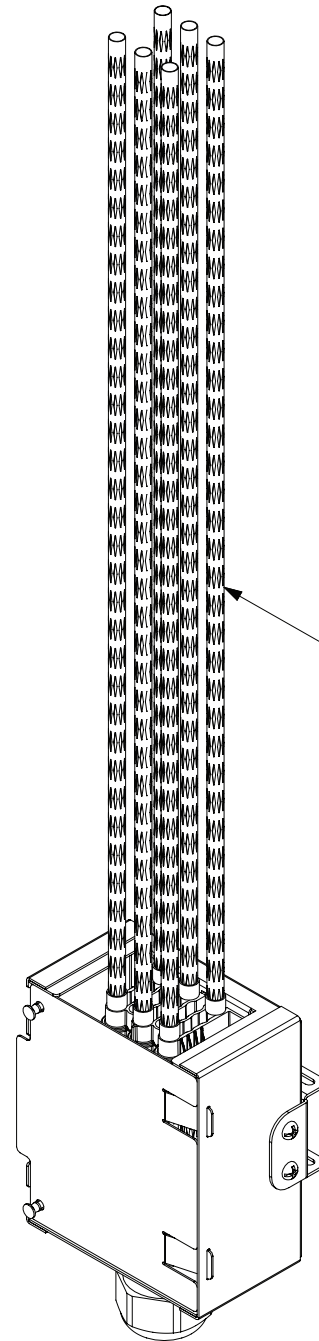
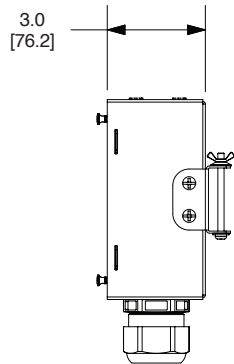
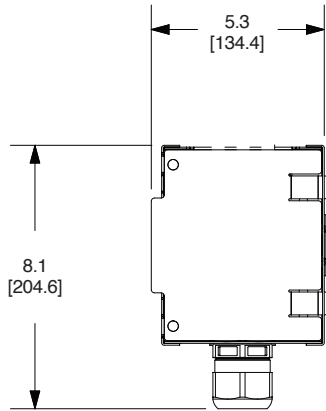

Each sleeve assembly is 3 meters long
(not shown to scale)

Dimensions are in inches. [Dimensions in parenthesis are metric].

WORLDWIDE SUBSIDIARIES AND SALES OFFICES

PANDUIT US/CANADA
Phone: 800.777.3300

PANDUIT EUROPE LTD.
London, UK
cs-emea@panduit.com
Phone: 44.20.8601.7200

PANDUIT SINGAPORE PTE. LTD.
Republic of Singapore
cs-ap@panduit.com
Phone: 65.6305.7575

PANDUIT JAPAN
Tokyo, Japan
cs-japan@panduit.com
Phone: 81.3.6863.6000

PANDUIT LATIN AMERICA
Guadalajara, Mexico
cs-la@panduit.com
Phone: 52.33.3777.6000

PANDUIT AUSTRALIA PTY. LTD.
Victoria, Australia
cs-aus@panduit.com
Phone: 61.3.9794.9020

For a copy of Panduit product warranties, log on to www.panduit.com/warranty

For more information

Visit us at www.panduit.com

Contact Customer Service by email: cs@panduit.com
or by phone: 800.777.3300

PANDUIT[®]

©2019 Panduit Corp.
ALL RIGHTS RESERVED.
RKSP182--WW-ENG
3/2019