

THIS COPY IS PROVIDED ON A RESTRICTED BASIS AND IS NOT TO BE USED IN ANY WAY DETRIMENTAL TO THE INTERESTS OF PANDUIT CORP.

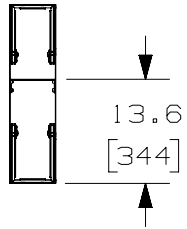

FINGER SECTIONS
FIELD INSTALLED
AND REMOVABLE

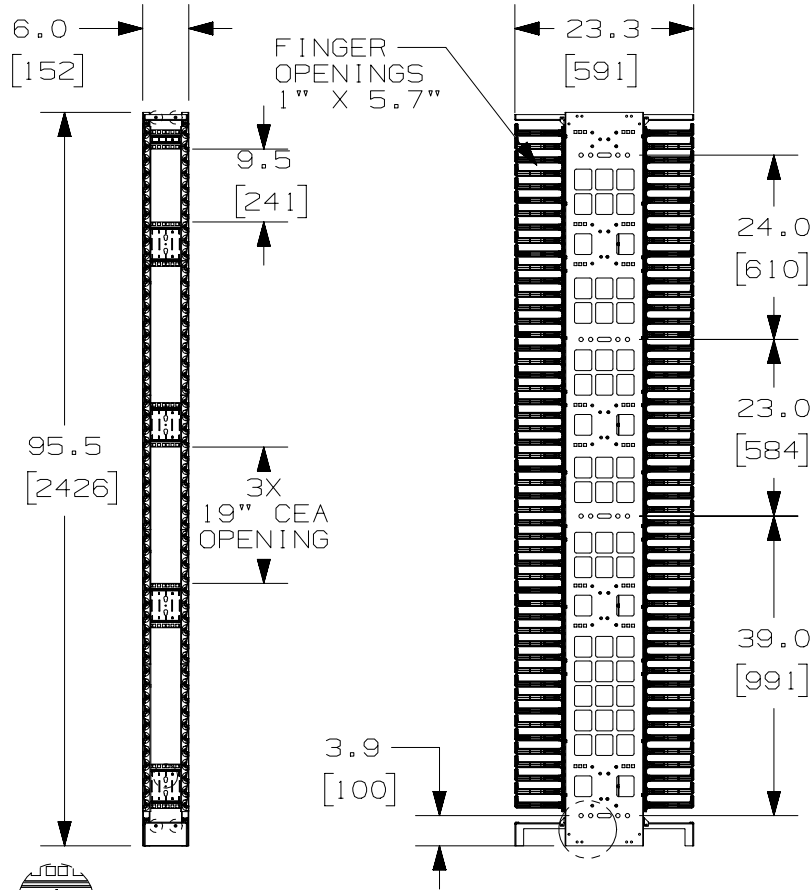
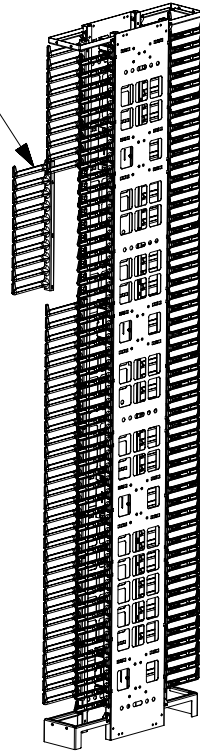

3X
19" CEA
OPENING

3.9
[100]

2.1 [53]

3.3 [85]

4.5 [114]

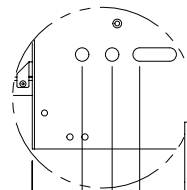

TITLE
PATCHRUNNER HIGH CAPACITY VERTICAL MANAGER
8FT TALL 6" WIDE, DUAL-SIDED (PEV696)
CONTROL DRAWING

ITEM REVISION NAME
10V179AA/05

DATASET FILE NAME
10V179AA_DC/05A

UNLESS OTHERWISE SPECIFIED,
DIMENSIONAL TOLERANCES ARE: IN (mm)

MATERIAL:
BACKBONE- STEEL
FINGERS- ABS

DRAWING NUMBER:
10V179AA-DC

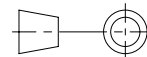

THIRD ANGLE
PROJECTION

| | | | | | |
|------------------|-----------------|------------|---------------|------------|-----------|
| DRAWN BY BAME | DATE 7/13/11 | CHK SRK | SCALE NONE | SHT 1 OF 1 | SIZE A |
|------------------|-----------------|------------|---------------|------------|-----------|

| | |
|-------------|---------------------------------|
| PANDUIT P/N | WEIGHT |
| PEV696 | 59.0 LBS/EACH (26.8 kg/EACH) |

NOTES:

- VISIT OUR ON-LINE CATALOG AT WWW.PANDUIT.COM FOR A CURRENT LIST OF PRODUCTS APPLICABLE FOR USE WITH THIS PART.
- COMPONENTS: (1) 8FT TALL 6" DUAL-SIDE VERTICAL MANAGER
(1) HARDWARE KIT
(2) LEFT PEV96 FINGER KITS
(2) RIGHT PEV96 FINGER KITS
(4) DOOR BRACKET BASES
- CAN BE USED WITH ANY 19 OR 23 INCH EIA STANDARD RACK.
- 3 ROWS OF 2RU 19" CEA OPENINGS (6 TOTAL RU)
- 8FT TALL 6" DOOR SOLD SEPARATELY (P/N: PED696B1)
- DIMENSIONS IN PARENTHESIS ARE METRIC.
- ALL DIMENSIONS ARE REFERENCE ONLY.

RU SPACES NUMBERED

| | | | | | | |
|-----|---------|-----|-----|------|--|-------------|
| REV | DATE | BY | CHK | APR | DESCRIPTION | ECN |
| 05A | 3-2-17 | TWV | KZU | JEFK | REPLACED P/N PED696 WITH PED696B1 IN NOTE #5 | 10V179AA-DC |
| 04A | 7/21/16 | AMF | KZU | KRKE | REMOVED DOOR BRACKETS | 10V179AA-DC |

PANDUIT

D10100DA/15