

THIS COPY IS PROVIDED ON A RESTRICTED BASIS AND IS NOT TO BE USED IN ANY WAY DETRIMENTAL TO THE INTERESTS OF PANDUIT CORP.

PANDUIT P/N	WEIGHT
PWBCB12**	3.5 LBS/EACH (997.9g)/EACH

NOTES:

1. DIMENSIONS IN [] ARE METRIC.
2. PART INCLUDES 1 BRACKET
3. PART WORKS WITH ALL 12" OR SMALLER WIDE WIRE BASKETS.
4. BRACKET ACCEPTS UP TO 5/16" OR 8mm CUSTOMER SUPPLIED MOUNTING HARDWARE
5. BASKETS ARE MOUNTED TO CANTILVER BRACKET WITH 2 PWBHK**. (SOLD SEPARATELY).
6. **= BL (BLACK POWDER COAT), WH (WHITE POWDER COAT), OR EZ (CLEAR ZINC)
7. ALL MATERIALS AND COMPONENTS USED MEET THE MATERIAL RESTRICTIONS OF RoHS (EUROPEAN DIRECTIVE 2011/65/EC ON THE RESTRICTION OF HAZARDOUS SUBSTANCES) AS PROPOSED BY THE RoHS TECHNICAL ADAPTATION COMMITTEE.

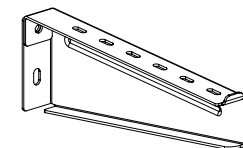
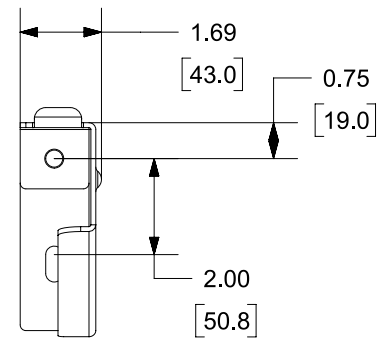
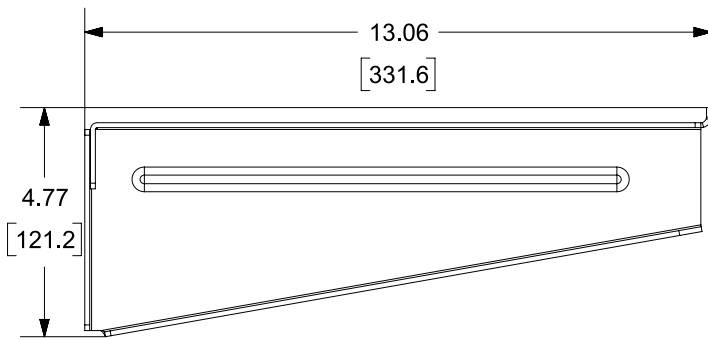
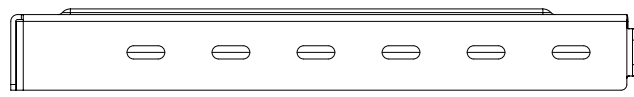

TITLE		WIRE BASKET CANTILEVER BRACKET 12" [300mm]	
ITEM REVISION NAME		CUSTOMER DRAWING	
DATASET FILE NAME		00510EPL/00	
		00510EPL_DC/00C	
MATERIAL		C.R.S.	
DRAWN BY		DATE	CHK
JSP		6/2/21	WJM
SCALE		NONE	
DRAWING NUMBER		00510EPL-DC	
SHEET 1 OF 1		A	

REV	DATE	BY	CHK	APR	DESCRIPTION	ECN
00C	12-14-23	SAT	DWR	EB	B. UPDATED TITLE.	00510EPL-DC
00B	3/7/22	JSP	DWR	ML	A. ADD NOTE 3-7	00510EPL-DC
00A	6/2/21	JSP	WJM	ML	INITIAL RELEASE	00510EPL-DC

A-SIZE CUSTOMER