

THIS COPY IS PROVIDED ON A RESTRICTED BASIS AND IS NOT TO BE USED IN ANY WAY DETRIMENTAL TO THE INTERESTS OF PANDUIT CORP.

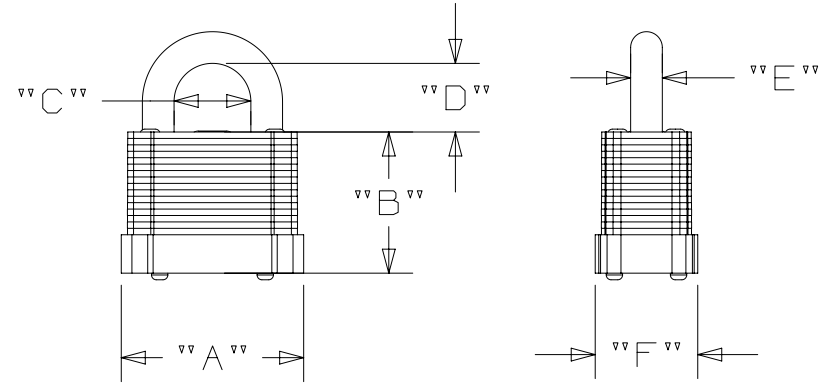

NOTES:

- 1) DIMENSIONS IN [] ARE MILLIMETERS
- 2) 5 PIN CYLINDER
- 3) AVAILABLE WITH CUSTOM KEYING
- 4) SHORT SHACKLE IS STANDARD ADD "-LS" FOR LONG SHACKLE

	DIM "A"	DIM "B"	DIM "C"	DIM "D"	DIM "E"	DIM "F"
PSL-6BU	1.72 [43.7]	1.38 [35.1]	0.73 [18.5]	0.89 [22.7]	0.27 [6.8]	1.02 [25.9]
PSL-6BU-LS	1.72 [43.7]	1.38 [35.1]	0.73 [18.5]	2.13 [54.2]	0.27 [6.8]	1.02 [25.9]
PSL-6ABU	1.40 [35.6]	1.25 [31.8]	0.60 [15.2]	0.69 [17.5]	0.20 [5.1]	0.86 [22.0]
PSL-6ABU-LS	1.40 [35.6]	1.25 [31.8]	0.60 [15.2]	1.89 [48.0]	0.20 [5.1]	0.86 [22.0]
PSL-6CBU	1.90 [48.3]	1.47 [37.3]	0.80 [20.3]	0.86 [25.4]	0.33 [8.4]	1.07 [27.1]
PSL-6CBU-LS	1.90 [48.3]	1.47 [37.3]	0.80 [20.3]	1.95 [49.4]	0.33 [8.4]	1.07 [27.1]
PSL-6DBU	2.10 [53.3]	1.55 [39.4]	0.89 [22.7]	0.97 [25.4]	0.36 [9.1]	1.17 [29.8]
PSL-6DBU-LS	2.10 [53.3]	1.55 [39.4]	0.89 [22.7]	2.00 [50.8]	0.36 [9.1]	1.17 [29.8]

REV	DATE	BY	CHK	APR	DESCRIPTION	ECN	TITLE	MATERIAL:	DRAWING NUMBER:	SIZE
							PSL-6 Series Padlocks	Brass, Steel, & Plastic	C11720	A
							CUSTOMER DRAWING			
							ITEM REVISION NAME			
							00220NCV/00			
							DATASET FILE NAME			
							00220NCV_C11720/00A			
							UNLESS OTHERWISE SPECIFIED, DIMENSIONAL TOLERANCES ARE: IN [mm]			
							.x ± .25 [6.35] .xxx ± .05 [1.27]			
							.xx ± .15 [3.81] ANGLES ± 5 °			
00	02/08/2018	AUMA	DJW	JHAC	Initial Release	GAECN05192	THIRD ANGLE PROJECTION			
							DRAWN BY			
							AUMA			
							DATE			
							1/30/18			
							CHK			
							JHAC			
							SCALE			
							1:2			
							SHT 1 OF 1			