

T568B Wiring Scheme

Pin #	8	7	6	5	4	3	2	1
T568B	BRN	BRN/ WHT	GRN	BLU/ WHT	BLU	GRN/ WHT	ORG	ORG/ WHT

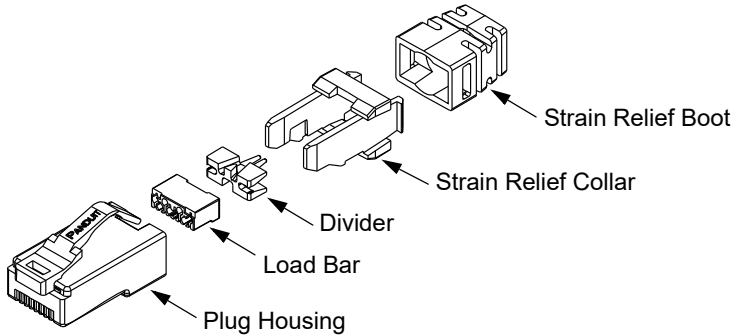

Specifications

- Refer to modular plug specification sheet for cable jacket and conductor insulation compatibility.
- Panduit recommends T568B wiring scheme for use with cable constructed with the brown pair opposing the orange pair.
- Designed and tuned exclusively for Panduit Category 6A UTP cable.

Load Bar

Conductor holes and Contact slots

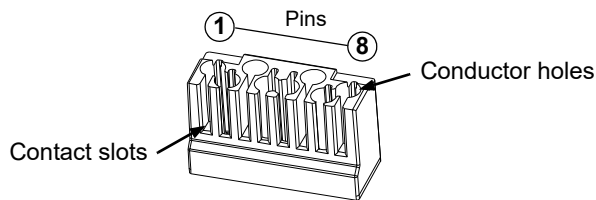

Divider

Conductor slots and "V" channel

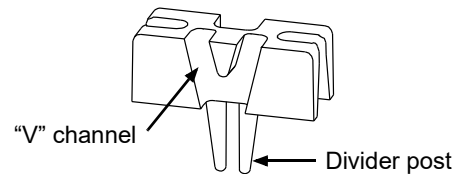

- 1** Thread on boot and collar first!
(Cable ends 1 & 2)

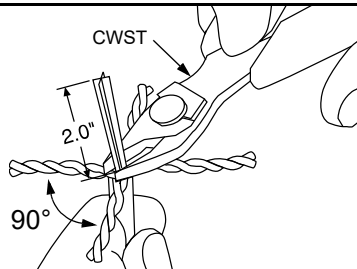
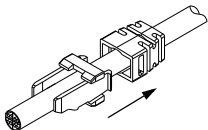

- ◆ Thread boot and collar onto the cable first.
- ◆ Remove 2.5" - 3.0" of the outer jacket from the cable end using wire stripping tool (CJAST).
- ◆ Remove matrix foil to expose twisted pairs.
- ◆ Fan twisted pairs into respective quadrants. The brown pair should be opposite the orange pair.
- ◆ When a cable spline (X-shaped filler) is present, cut spline flush to fanned pairs using wire snipping tool (CWST).

- 2** (Cable end 2)

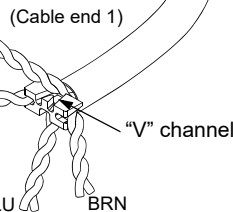
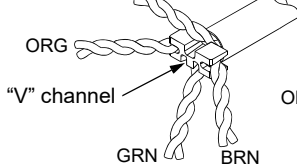

- ◆ Note orientation of the divider depending on cable end 1 or cable end 2. The "V" channel should be aligned with the green pair.
- ◆ Insert divider posts into the cable. If the cable has an internal spline, insert divider posts into the brown and orange quadrants of the spline.

- 3**

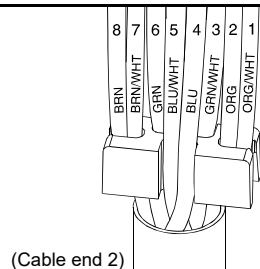
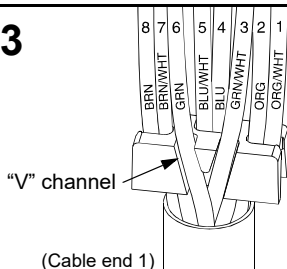

- ◆ Arrange conductors to T568B wiring scheme while minimizing untwist and smooth conductors.
- ◆ Seat conductors into proper divider slots while holding divider near the end of the cable jacket.

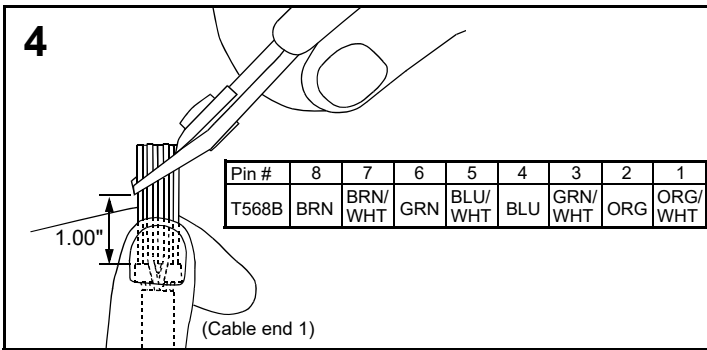

- ◆ While holding conductors in respective divider slots, straighten and align untwisted conductors using a circular motion.
- ◆ Do not release grip of conductors until load bar is applied in order to maintain conductor alignment.
- ◆ Trim conductors on an angle approximately 1.00" from divider leading edge.

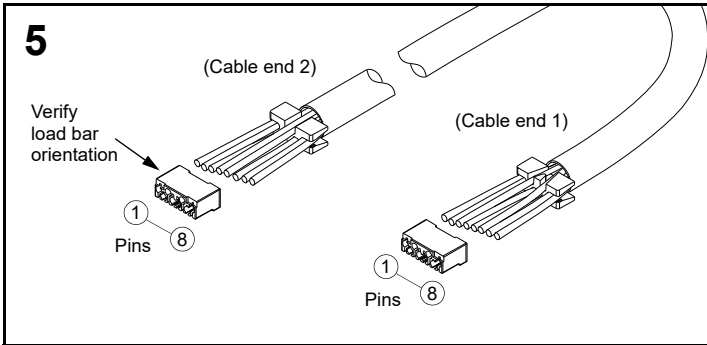

- ◆ Orient load bar with contact slots facing downward.

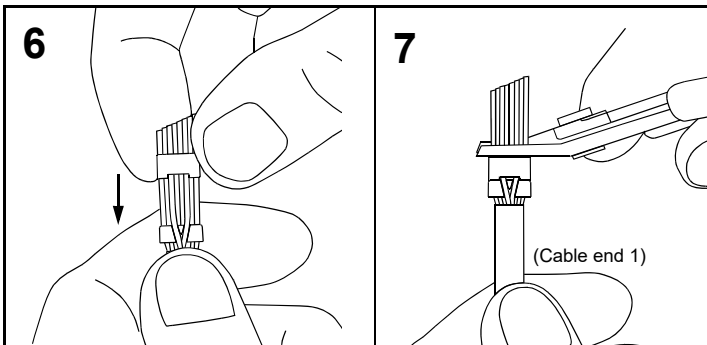

- ◆ Guide conductors into load bar holes while holding conductors in the divider.
- ◆ Slide load bar towards divider until flush.
- ◆ Ensure the divider/load bar is centered and perpendicular to the cable axis.
- ◆ Trim conductors flush with load bar face.

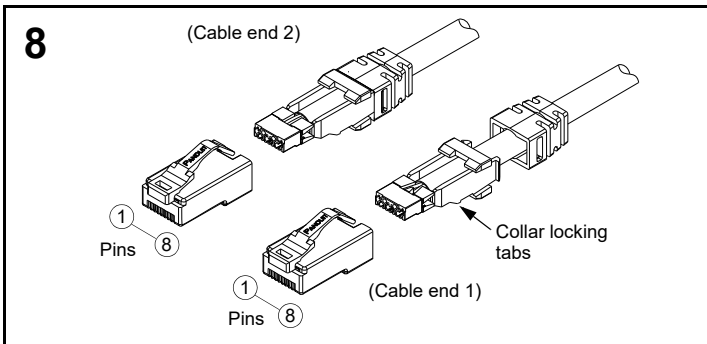

- ◆ While holding load bar and divider stationary, slide collar and boot forward until there is no gap between collar and divider. Do not exert pressure onto divider as collar can push load bar off conductors.
- ◆ Confirm orientation of collar.
- ◆ Align pin #1 of cable sub-assembly with pin #1 of plug housing.

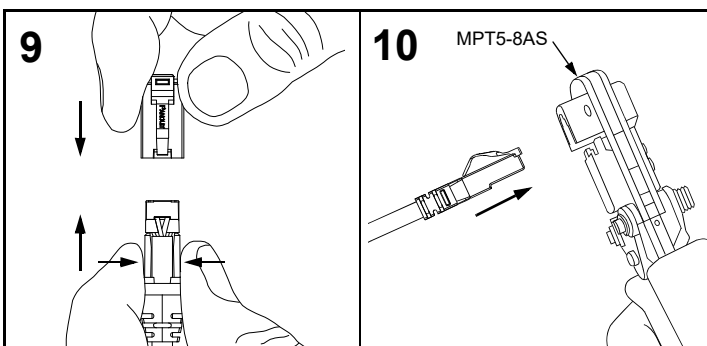

- ◆ Grip and squeeze across collar arms as sub-assembly is inserted into plug housing.
- ◆ Push sub-assembly into housing until collar locking tabs clear the plug housing pocket. Although not required, TX6 PLUS Plug Assembly Tool (CSPT) is available to facilitate this step.
- ◆ Slide boot forward and fully seat onto strain relief collar.
- ◆ Use tool MPT5-8AS to complete termination.
- ◆ Assembly is complete. Visually check plug.

T568A Wiring Scheme

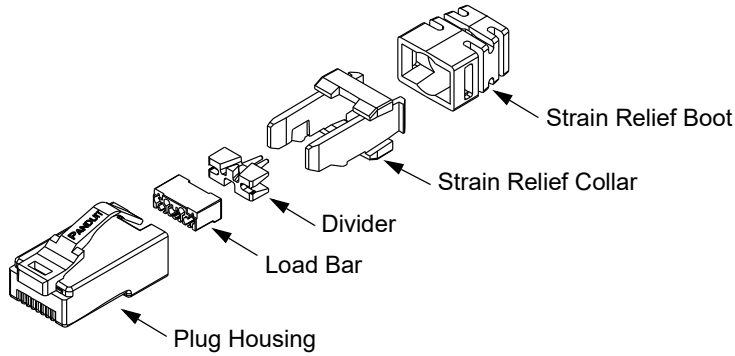

Pin #	8	7	6	5	4	3	2	1
T568A	BRN	BRN/WHT	ORG	BLU/WHT	BLU	ORG/WHT	GRN	GRN/WHT

Specifications

- Refer to modular plug specification sheet for cable jacket and conductor insulation compatibility.
- Panduit recommends T568B wiring scheme for use with cable constructed with the brown pair opposing the orange pair.
- Designed and tuned exclusively for Panduit Category 6A UTP cable.

Load Bar

Conductor holes and Contact slots

Divider

Conductor slots and "V" channel

1 Thread on boot and collar first!
(Cable ends 1 & 2)

- ◆ Thread boot and collar onto the cable first.
- ◆ Remove 2.0" of the outer jacket from the cable end using wire stripping tool (CJAST).
- ◆ Remove matrix foil to expose twisted pairs.
- ◆ Fan twisted pairs into respective quadrants. The brown pair should be opposite the green pair.
- ◆ When a cable spline (X-shaped filler) is present, cut spline flush to fanned pairs using wire snipping tool (CWST).

2

- ◆ Note orientation of the divider depending on cable end 1 or cable end 2. The "V" channel should be aligned with the orange pair.
- ◆ Insert divider posts into the cable. If the cable has an internal spline, insert divider posts into the brown and green quadrants of the spline.

3

- ◆ Arrange conductors to T568A wiring scheme while minimizing untwist and smooth conductors.
- ◆ Seat conductors into proper divider slots while holding divider near the end of the cable jacket.

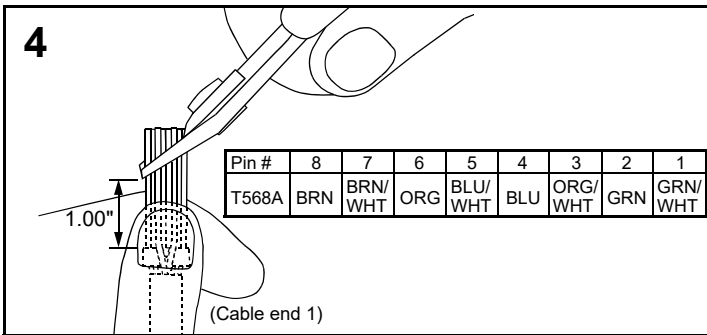

- ◆ While holding conductors in respective divider slots, straighten and align untwisted conductors using a circular motion.
- ◆ Do not release grip of conductors until load bar is applied in order to maintain conductor alignment.
- ◆ Trim conductors on an angle approximately 1.00" from divider leading edge.

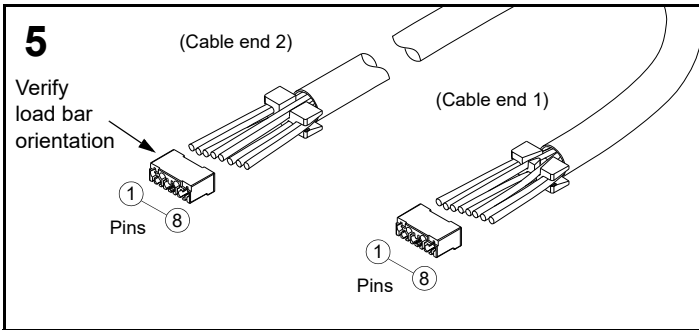

- ◆ Orient load bar with contact slots facing downward.

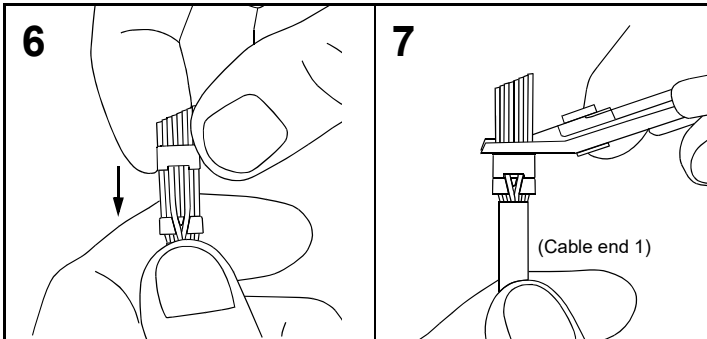

- ◆ Guide conductors into load bar holes while holding conductors in the divider.
- ◆ Slide load bar towards divider until flush.
- ◆ Ensure the divider/load bar is centered and perpendicular to the cable axis.
- ◆ Trim conductors flush with load bar face.

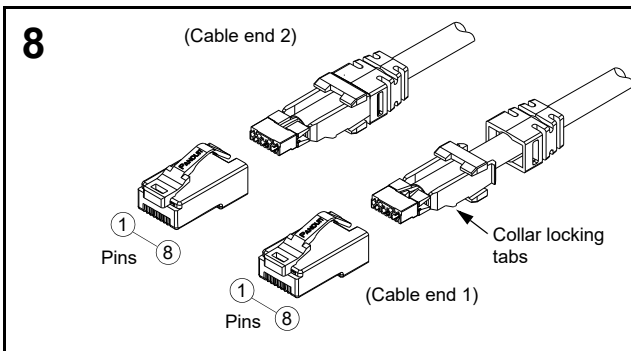

- ◆ While holding load bar and divider stationary, slide collar and boot forward until there is no gap between collar and divider. Do not exert pressure onto divider as collar can push load bar off conductors.
- ◆ Confirm orientation of collar.
- ◆ Align pin #1 of cable sub-assembly with pin #1 of plug housing.

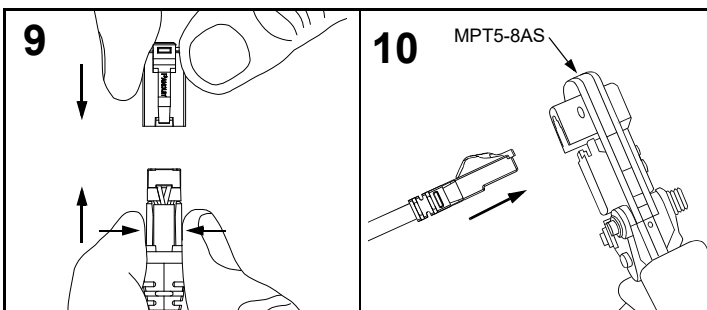

- ◆ Grip and squeeze across collar arms as sub-assembly is inserted into plug housing.
- ◆ Push sub-assembly into housing until collar locking tabs clear the plug housing pocket. Although not required, TX6 PLUS Plug Assembly Tool (CSPT) is available to facilitate this step.
- ◆ Slide boot forward and fully seat onto strain relief collar.
- ◆ Use tool MPT5-8AS to complete termination.
- ◆ Assembly is complete. Visually check plug.

For Instructions in Local Languages
and Technical Support:
www.panduit.com

PANDUIT
www.panduit.com

E-mail:
techsupport@panduit.com
Phone:
866-405-6654