

THIS COPY IS PROVIDED ON A RESTRICTED BASIS AND IS NOT TO BE USED IN ANY WAY DETRIMENTAL TO THE INTERESTS OF PANDUIT CORP.

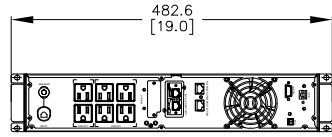

VIEW ROTATED 180°

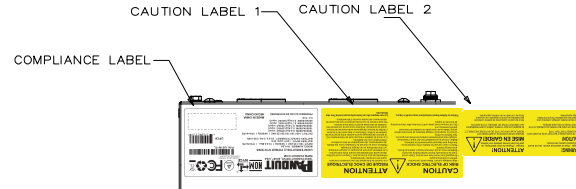

DETAIL A
SCALE 1:3

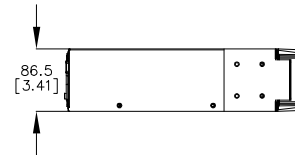
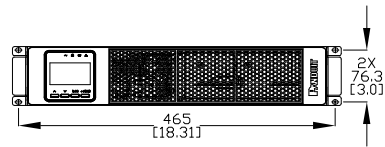
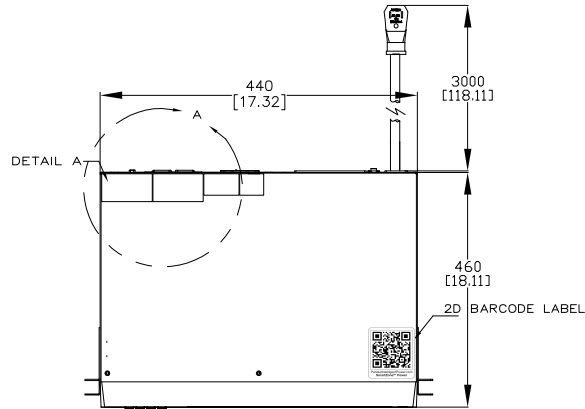

SPECIFICATION:

1. STANDARD:
- | | |
|-------------------------|------------------------|
| UPS TOPOLOGY: | LINE INTERACTIVE |
| KVA: | 1 |
| BATTERY TYPE: | LITHIUM-ION |
| INPUT PLUG: | NEMA 5-15P |
| NOMINAL INPUT VOLTAGE: | 100/110/115/120/125VAC |
| INPUT PHASE: | SINGLE |
| OUTPUT PHASE: | SINGLE |
| NOMINAL OUTPUT VOLTAGE: | 100/110/115/120/125VAC |
| OUTLET TYPE AND QTY: | NEMA 5-15R(6) |
| DISPLAY TYPE: | 2.8 INCH, 4 BUTTON |
| PARALLEL PORT SUPPORT: | NO |
| INPUT BREAKER TYPE: | 16A PUSH BUTTON |
| OUTPUT BREAKER TYPE: | N/A |

2. ADDITIONAL:
NONE

3. ACCESSORY COMPONENTS:
- P/N U01N11L CONTAINS AN INTELLIGENT NETWORK CARD,(INSTALLED)
 - STABILIZER BRACKET, QTY:(4)
 - INSTALLATION EARS, QTY:(2)
 - SAFETY WARNING SHEET,QTY:(1)
 - SELECTION GUIDE(POCKET GUIDE),QTY:(1)
 - DB9/DB9 RS232 1.5M COMMUNICATION CABLE, QTY:(1)
 - USB-A/USB-B 1.2M SERIAL COMMUNICATION CABLE, QTY:(1)
 - INCLUDES P/N:ULC024 INTERNAL BATTERY CARTRIDGE, QTY (1),(INSTALLED)
 - INCLUDES P/N:URMKIT2 INSTALLATION RAIL KIT, QTY (1),(U01N11L ONLY)
 - REFER TO ASSOCIATED DRAWINGS FOR PHYSICAL DIMENSIONS AND SPECIFICATIONS
 - EPO PLUG WITH SHORTING WIRE,QTY:(1),(INSTALLED)

NOTES:

1. PRIMARY DIMENSIONS ARE IN MILLIMETERS. SECONDARY DIMENSIONS ARE IN INCHES.
2. INSTALLATION SHALL COMPLY WITH ALL APPLICABLE NATIONAL, STATE, AND LOCAL CODES.
3. VISIT OUR ON-LINE CATALOG AT WWW.PANDUIT.COM FOR A CURRENT LIST OF PRODUCTS APPLICABLE FOR USE WITH THIS PRODUCT.
4. ALL PURCHASED ITEMS CONFORM TO C2-0834 PANDUIT SPECIFICATION FOR CHEMICAL SUBSTANCES TO BE CONTROLLED IN PRODUCT AND PACKAGING.

IDENTIFICATION:

PART NUMBER	DESCRIPTION	SHIPPING WEIGHT (KG)
U01S11L	SMARTZONE UPS, 1kVA, 2U, 120V, SINGLE PHASE, LITHIUM-ION POWER PROTECTION	17.1
U01N11L	SMARTZONE UPS, 1kVA, 2U, 120V, SINGLE PHASE, LITHIUM-ION POWER PROTECTION WITH INTELLIGENT NETWORK CARD	20.4

REV	DATE	BY	CHK	APR	DESCRIPTION	ECN	DATE	FILE	PRODUCTION	REV
01A	08/01	LS	ZRZ	GLM/D/B	A.UPDATED DESCRIPTION B.KIT WAS URMKIT 1 C.NOTCH REMOVED IN METAL				U01N1L	
00A	01/18	LS	ZRZ	GLM/D/B	RELEASE TO PRODUCTION				U01N1L	
REV	DATE	BY	CHK	APR	DESCRIPTION	ECN	DATE	FILE	PRODUCTION	REV
							08/01/2022	M.D	VARIOUS	SHT 1 OF 2

PLEASE CHECK THAT YOU HAVE THE CORRECT PART NUMBER AND THAT THE PART NUMBER IS THE SAME AS THE PART NUMBER ON THE DRAWING.

SMARTZONE UPS
U01S11L/U01N11L

CUSTOMER DRAWING

U01S11L/U01N11L/01

U01S11L/U01N11L-DA/01A

UNLESS OTHERWISE SPECIFIED,
DIMENSIONAL TOLERANCES ARE: MM (IN)

N/A

U01N11L-DC

1



UNINTERRUPTIBLE POWER SYSTEMS
 MODEL NUMBER: 1A1L2A
 INPUT: 100-125 VAC | 50/60Hz | 10.4 A Max. | 1PH+N+PE
 BATTERY INPUT: 28 VDC | 50 A
 BATTERY CAPACITY/ENERGY: 25.6 V / 9 Ah / 230.4 Wh
 OUTPUT: 100/110/115/120/125 VAC | 50/60Hz | 1PH+N+PE
 1000VA/900W, 8.9 A @ 120VAC input
 1000VA/900W, 8.3 A @ 120VAC input
 1000VA/900W, 8.7 A @ 115VAC input
 950VA/900W, 8.7 A @ 110VAC input
 950VA/900W, 9.0 A @ 100VAC input
 Icc: 3 kA
 PROHIBIDO SU USO EN EXTERIORES **MADE IN CHINA**
 HECHO CHINA

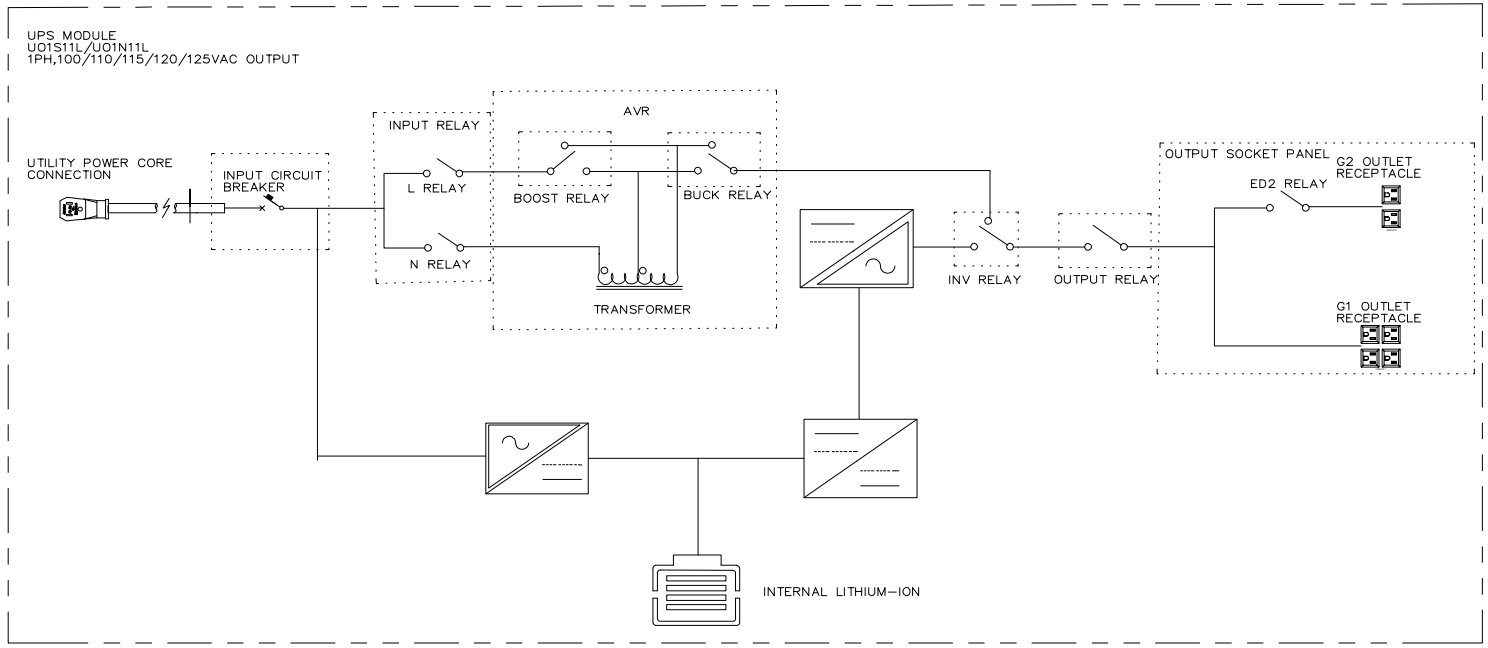

CORE FIRMWARE PART NUMBER: 3040-8860
 CORE FIRMWARE VERSION: V011B000000

LEGEND			
	DESCRIPTION		DESCRIPTION
	CIRCUIT BREAKER		AC-DC CONVERTER
	RELAY		AC-DC CONVERTER
	AC-DC CONVERTER		AC-DC CONVERTER
	BATTERY		

REV	DATE	BY	CHK	APR	DESCRIPTION	ECN	DATE	BY	CHK	APR	DESCRIPTION	ECN
01A	06/01	LS	ZRZ	GLM/DJB	A-UPDATED DESCRIPTION B.KIT WAS URMKIT 1 CATCH REMOVED IN METAL	U01N11L						
00A	01/12	LS	ZRZ	GLM/DJB	RELEASE TO PRODUCTION	U01N11L						
REV	DATE	BY	CHK	APR	DESCRIPTION	ECN	DATE	BY	CHK	APR	DESCRIPTION	ECN
							06/01/2022	MJD	VARIOUS			

WE ARE NOT RESPONSIBLE FOR THE CONSEQUENCES OF THE USE OF THIS DRAWING. THE USER SHALL BE RESPONSIBLE FOR THE PROPER USE OF THE DRAWING. THE USER SHALL BE RESPONSIBLE FOR THE PROPER USE OF THE DRAWING.

SMARTZONE UPS
 U01S11L/U01N11L
 CUSTOMER DRAWING
 U01S11L/U01N11L/01
 U01S11L/U01N11L-DA/01A
 DIMENSIONAL TOLERANCES ARE IN (IN)

PANDUIT

U01N11L-DC

REV: 01A
 DATE: 06/01/2022
 BY: MJD
 CHK: VARIOUS
 SHEET: 1 OF 2