

THIS COPY IS PROVIDED ON A RESTRICTED BASIS AND IS NOT TO BE USED IN ANY WAY DETRIMENTAL TO THE INTERESTS OF PANDUIT CORP.

PANDUIT P/N	WEIGHT
PWBTB6**	.20 LBS/EACH (90.7g)/EACH

NOTES:

1. DIMENSIONS IN [] ARE METRIC.
2. PART INCLUDES 1 BRACKET
3. PART WORKS WITH ALL 6" OR SMALLER WIDE WIRE BASKETS.
4. BRACKET ACCEPTS UP TO 1/2" OR 12mm CUSTOMER SUPPLIED MOUNTING HARDWARE
5. BASKETS ARE MOUNTED TO TRAPEZE BRACKET WITH 2 PWBHK**. (SOLD SEPARATELY).
6. **= BL (BLACK POWDER COAT), WH (WHITE POWDER COAT), OR EZ (CLEAR ZINC)
7. ALL MATERIALS AND COMPONENTS USED MEET THE MATERIAL RESTRICTIONS OF RoHS (EUROPEAN DIRECTIVE 2011/65/EC ON THE RESTRICTION OF HAZARDOUS SUBSTANCES) AS PROPOSED BY THE RoHS TECHNICAL ADAPTATION COMMITTEE.

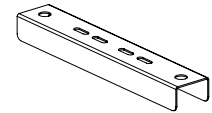
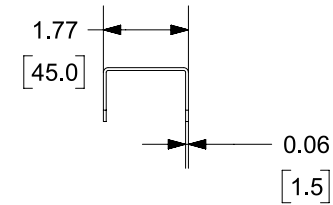
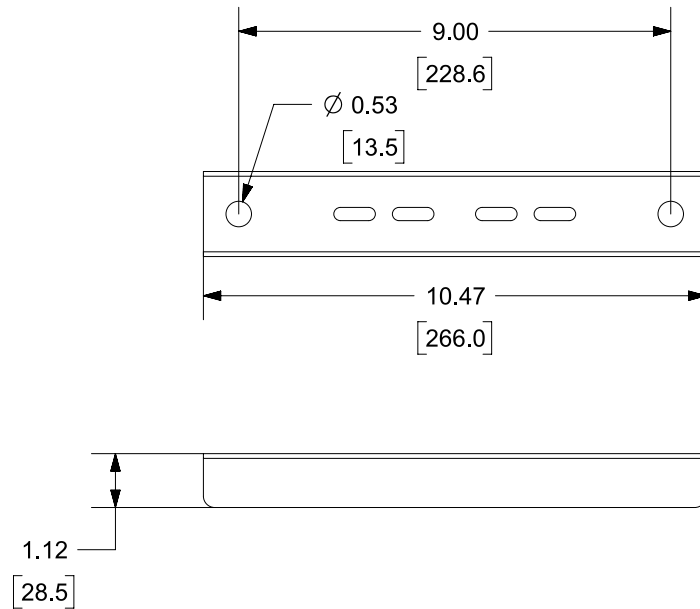

TITLE		WIRE BASKET TRAPEZE BRACKET 6" [150mm] W	
ITEM REVISION NAME		CUSTOMER DRAWING	
00510ERE/02			
DATASET FILE NAME			
00510ERE_DC/02C		THIRD ANGLE PROJECTION	
MATERIAL		DRAWING NUMBER	
C.R.S.		00510ERE-DC	
DRAWN BY	DATE	CHK	SCALE
JSP	6/2/21	WJM	NONE
SHEET 1 OF 1			SIZE
			A

REV	DATE	BY	CHK	APR	DESCRIPTION	ECN
02C	12-15-23	SAT	DWR	EB	B. UPDATED TITLE.	00510ERE-DC
02B	3/7/22	JSP	DWR	ML	A. ADD NOTE 3-7	00510ERE-DC
02A	6/2/21	JSP	WJM	ML	INITIAL RELEASE	00510ERE-DC

A-SIZE CUSTOMER