

THIS COPY IS PROVIDED ON A RESTRICTED BASIS AND IS NOT TO BE USED IN ANY WAY DETRIMENTAL TO THE INTERESTS OF PANDUIT CORP.

PLUG LENGTH CHART	
PORT	PLUG CORD LENGTH +1" / - .5"
1 - 12	23.5" (596.9)

COIL DIAMETER CHART		
PART NUMBER	LENGTH +6" (152.4) / -2" (50.8)	WEIGHT
UTPCH812PP25Y	8' (2438.4)	13.0 LBS./10 PCS. (5909 G/10 PCS)
UTPCH1012PP25Y	10' (3048)	16.25 LBS./10 PCS. (7386 G/10 PCS)
UTPCH1512PP25Y	15' (4572)	24.38 LBS./10 PCS. (11,082 G/10 PCS)
UTPCH2012PP25Y	20' (6096)	31.62 LBS./10 PCS. (14,373 G/10 PCS)
UTPCH612PP25Y	6' (1829)	9.75 LBS./10 PCS. (4423 G/10 PCS)

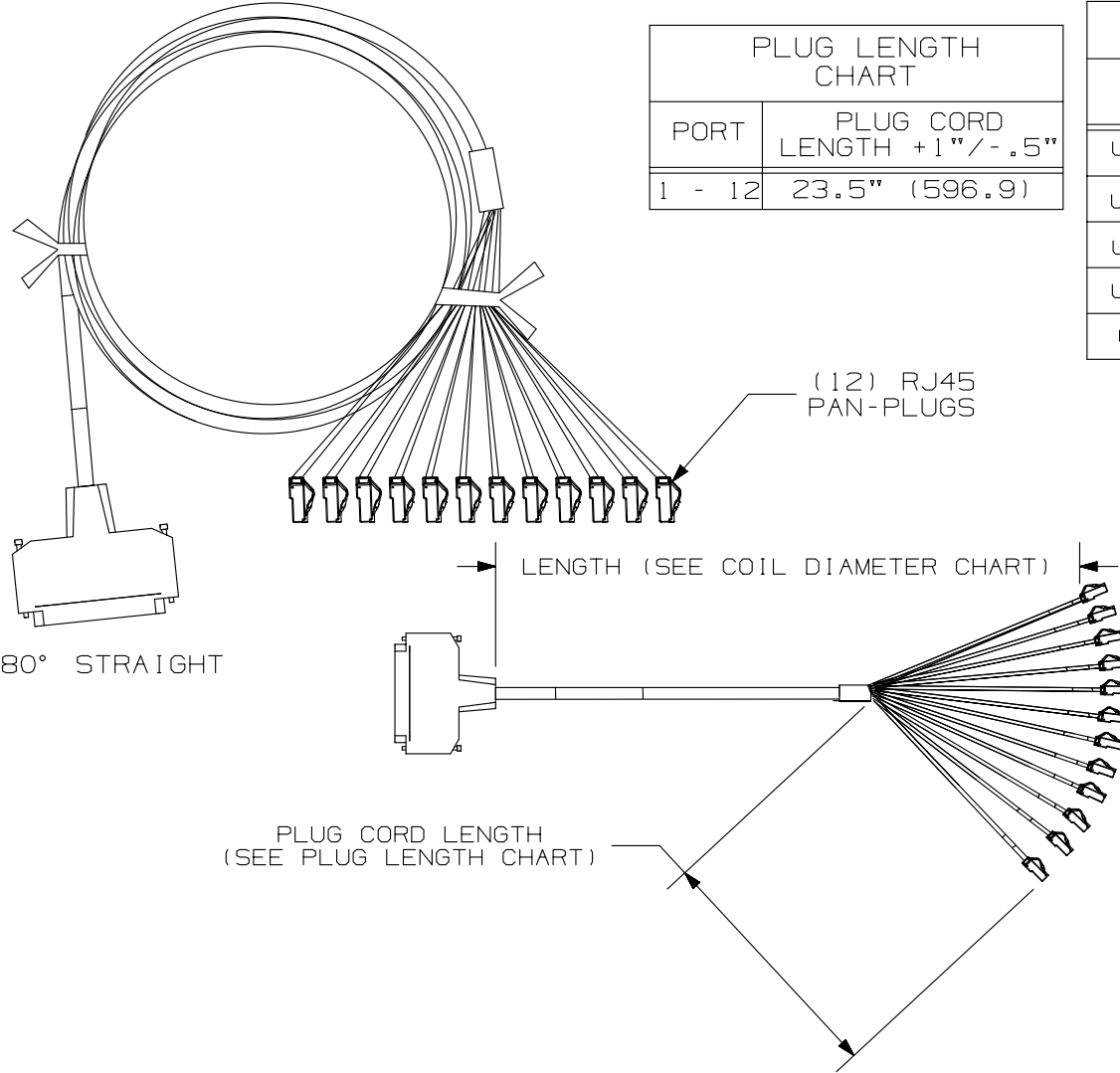

- NOTES:
1. SEE CURRENT CATALOG FOR ADDITIONAL PART NUMBER SUFFIXES TO INDICATE COLOR AND OR PACKAGE QUANTITY.
  2. SEE CATALOG FOR COMPLETE LIST OF PARTS APPLICABLE FOR USE WITH THIS PART.
  3. DIMENSIONS IN PARENTHESES ARE IN METRIC.
  4. MATES WITH FEMALE RJ21 CONNECTOR AND 10/100 BASE T PATCH PANEL CATEGORY 5 AND POWER SUM RATED.

PART NUMBER		UTPCH**12PP25Y	
TITLE			
25 PAIR HYDRA PATCH CORD ASSY ONE 180° RJ21 MALE CONNECTOR TO TWELVE PAN-PLUGS (TAILS ALL ONE LENGTH)			
CUSTOMER DRAWING			
ITEM REVISION NAME		M02479K0/00	
DATASET FILE NAME		M02479K0_DC276/00B	
UNLESS OTHERWISE SPECIFIED, DIMENSIONAL TOLERANCES ARE: IN (mm)		MATERIAL:	
.x ± .xx ± .03 (.8)		CONNECTOR HSG: UL94 V-0 THERMPLASTIC CABLE JACKET: PVC	
ANGLES ±		DRAWING NUMBER:	
THIRD ANGLE PROJECTION		02479-276	
DRAWN BY	DATE	CHK	SCALE
NER	3-20-06	WJC	NNE
SHT 1 OF 1			SIZE
			A

REV	DATE	BY	CHK	APR	DESCRIPTION	ECN
1	4-8-14	BJN	JSP	EJH	REVISED & REDRAWN PREVIOUS REVISIONS REMVD FOR CLARITY	02479-276

D10100DA/14