

CABLE PREPARATION

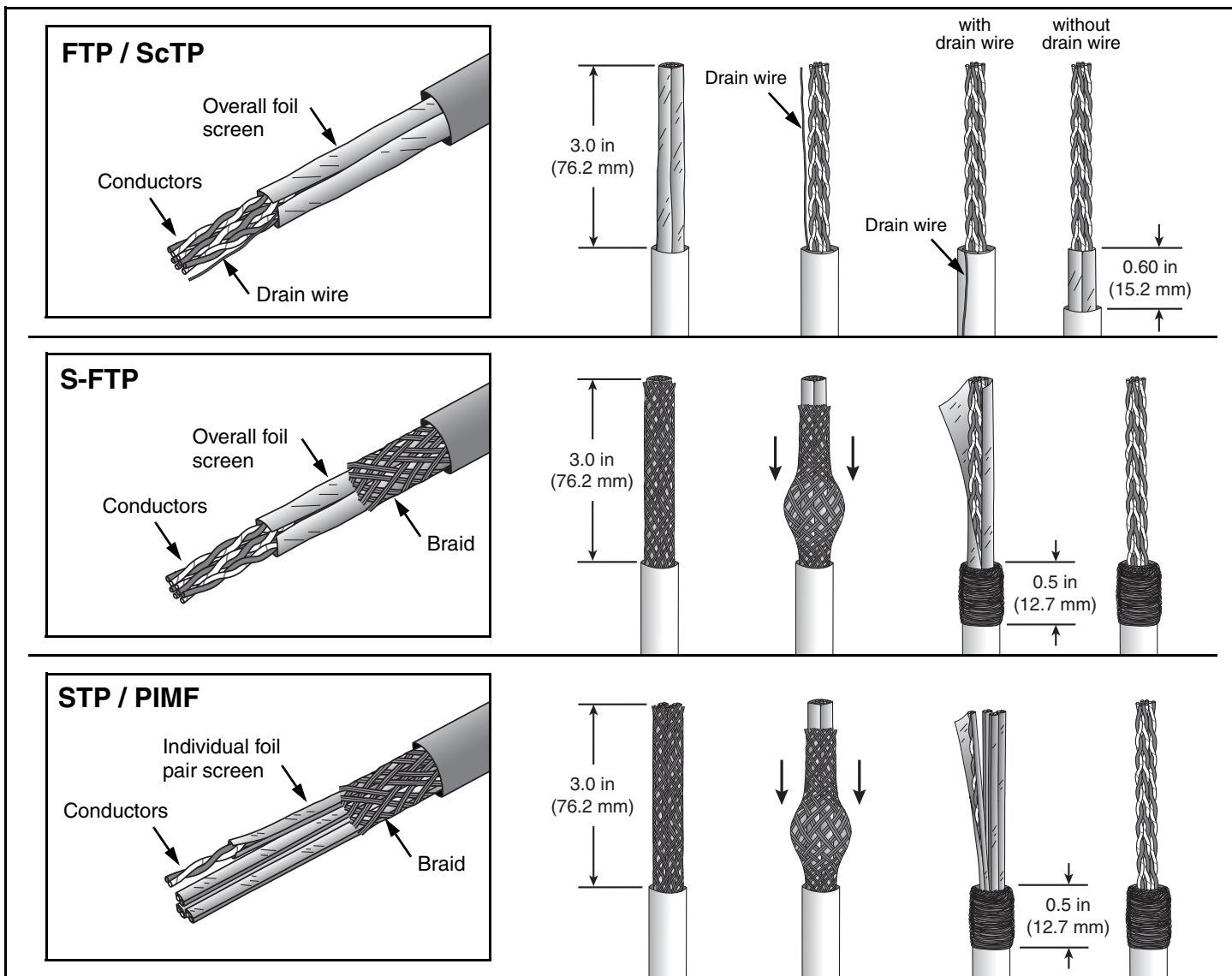

Note: May also use S-STP / PIMF cable type (conductors, individual foil pair screen, overall foil screen, and braid).

TERMINATION

- Remove all but one twist per pair, smooth conductors and arrange in proper color sequence.

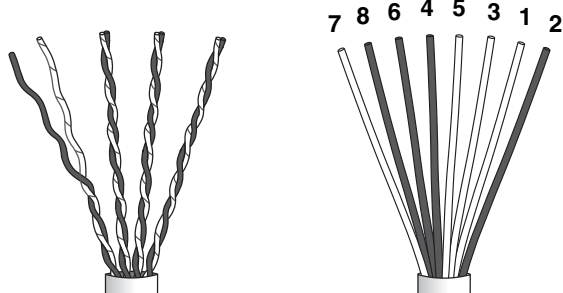

Mini-Com Mini-Jack Color-Coded Wire Positions

T568A			T568B		
2	GREEN	R3	2	ORANGE	R2
1	WHITE/GREEN	T3	1	WHITE/ORANGE	T2
3	WHITE/ORANGE	T2	3	WHITE/GREEN	T3
5	WHITE/BLUE	T1	5	WHITE/BLUE	T1
4	BLUE	R1	4	BLUE	R1
6	ORANGE	R2	6	GREEN	R3
8	BROWN	R4	8	BROWN	R4
7	WHITE/BROWN	T4	7	WHITE/BROWN	T4

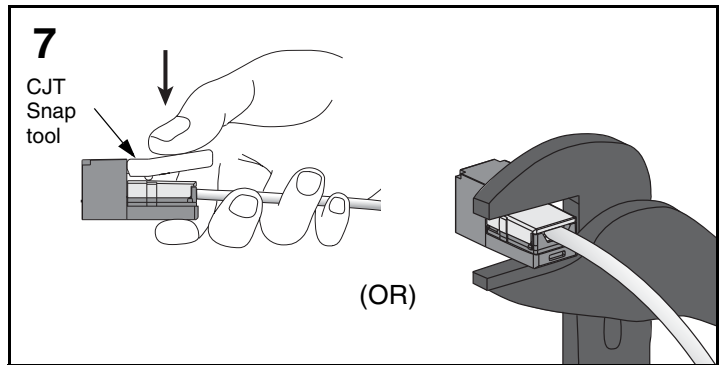
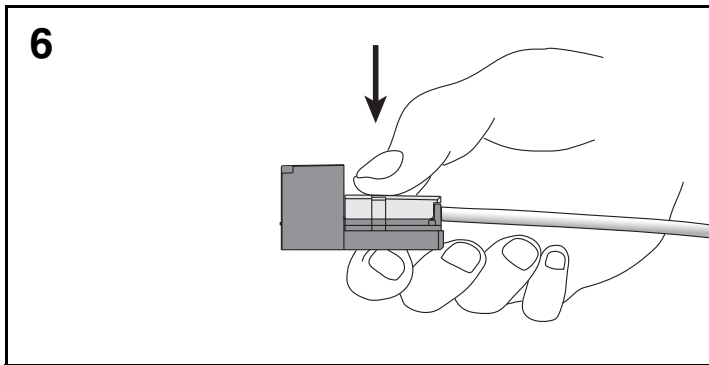
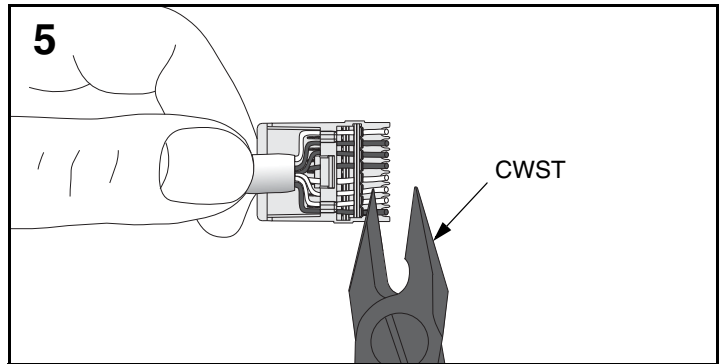
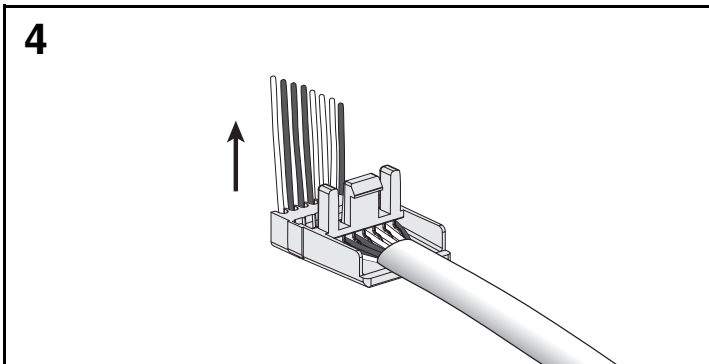
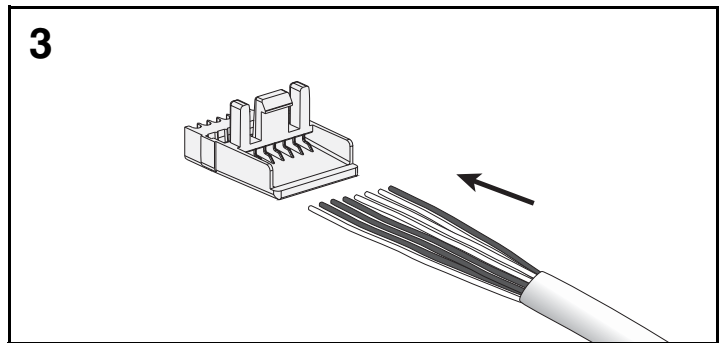
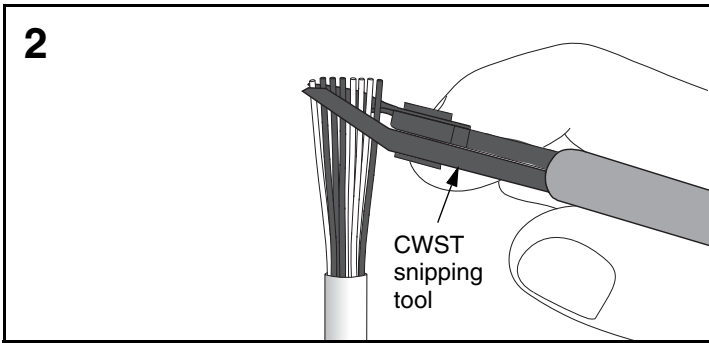

SHIELD INSTALLATION

For FTP / ScTP with drain wire

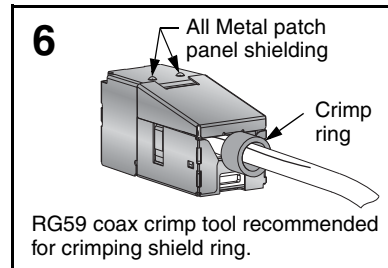
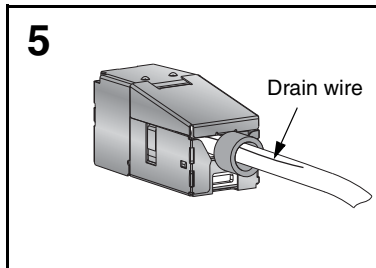
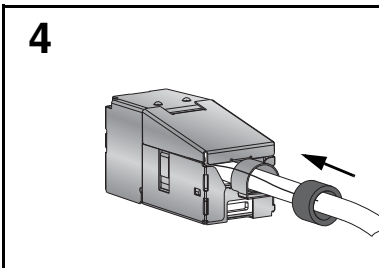
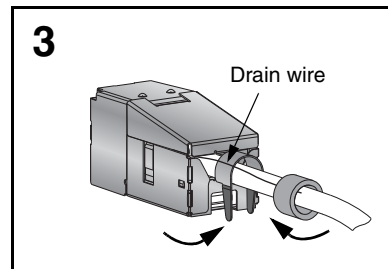
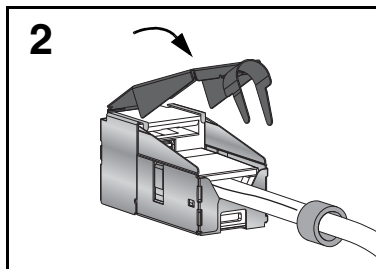
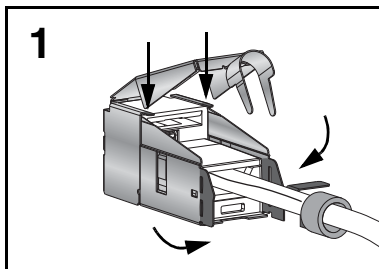

SHIELD INSTALLATION

For FTP / ScTP without drain wire,
S-FTP, STP / PIMF, S-STP / PIMF

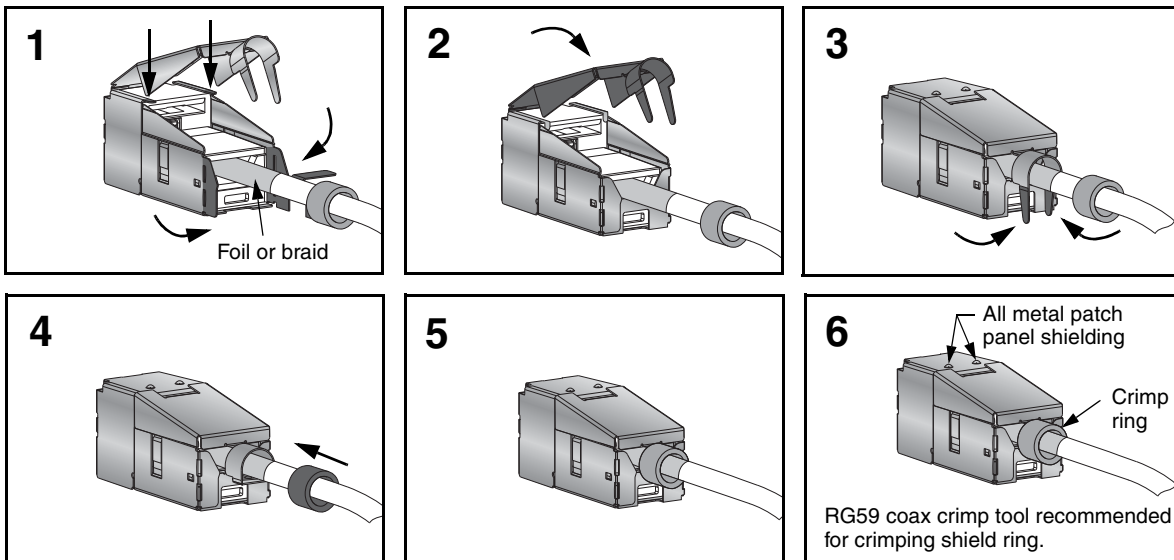

TERMINATION CAP REMOVAL

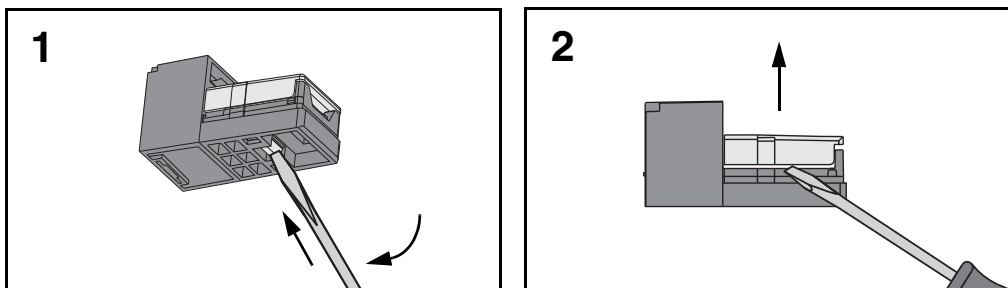

WIRING DIAGRAM	
Part Number - CJS588	
Modular Plug Contacts	Insulation Displacement Contacts
1	2
2	1
3	3
4	5
5	4
6	6
7	8
8	7

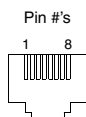

IEC 60708-1					
"A" wire			"B" wire		
2	GREEN	R3	2	ORANGE	R2
1	BLACK	T3	1	RED	T2
3	RED	T2	3	BLACK	T3
5	WHITE	T1	5	WHITE	T1
4	BLUE	R1	4	BLUE	R1
6	ORANGE	R2	6	GREEN	R3
8	BROWN	R4	8	BROWN	R4
7	YELLOW	T4	7	YELLOW	T4

Notes:

1. For specified performance, follow TIA/EIA 568-B installation guidelines.
2. Jack modules can terminate PVC or Plenum rated 22-24 AWG solid or stranded IWC cable with 0.048 in. (1.2 mm) maximum insulated conductor outside diameter.
3. Jack modules may be re-terminated a minimum of 10 times.
4. For technical and performance information, consult Panduit Technical Support.

As with all Wiring Accessories, the following statements apply:

1. Never install communications wiring during a lightning storm.
2. Never install communications wiring in wet locations unless the jack is specifically designed for use in wet locations.
3. Never touch uninsulated communications wiring or terminals unless the communication line has been disconnected at the network interface.
4. Use caution when installing or modifying communication wiring.

For Instructions in Local Languages
and Technical Support:

www.panduit.com/resources/install_maintain.asp



www.panduit.com

E-mail:
techsupport@panduit.com

Phone:
866-405-6654