**PREP, PREP96**

(1) End Panel
(6) Plastic Binding Screws
and Barrels

Assembly:**Step 1:**

Insert binding Screw Barrel
into appropriate hole loca-
tion

Step2:

Place End Panel Retention
Hook over Door Bracket
Lip.

Step 3:

Align barrel holes with End
Panel mounting holes

Step 4:

Fasten Binding Screws

PATCHRUNNER Installation Instructions

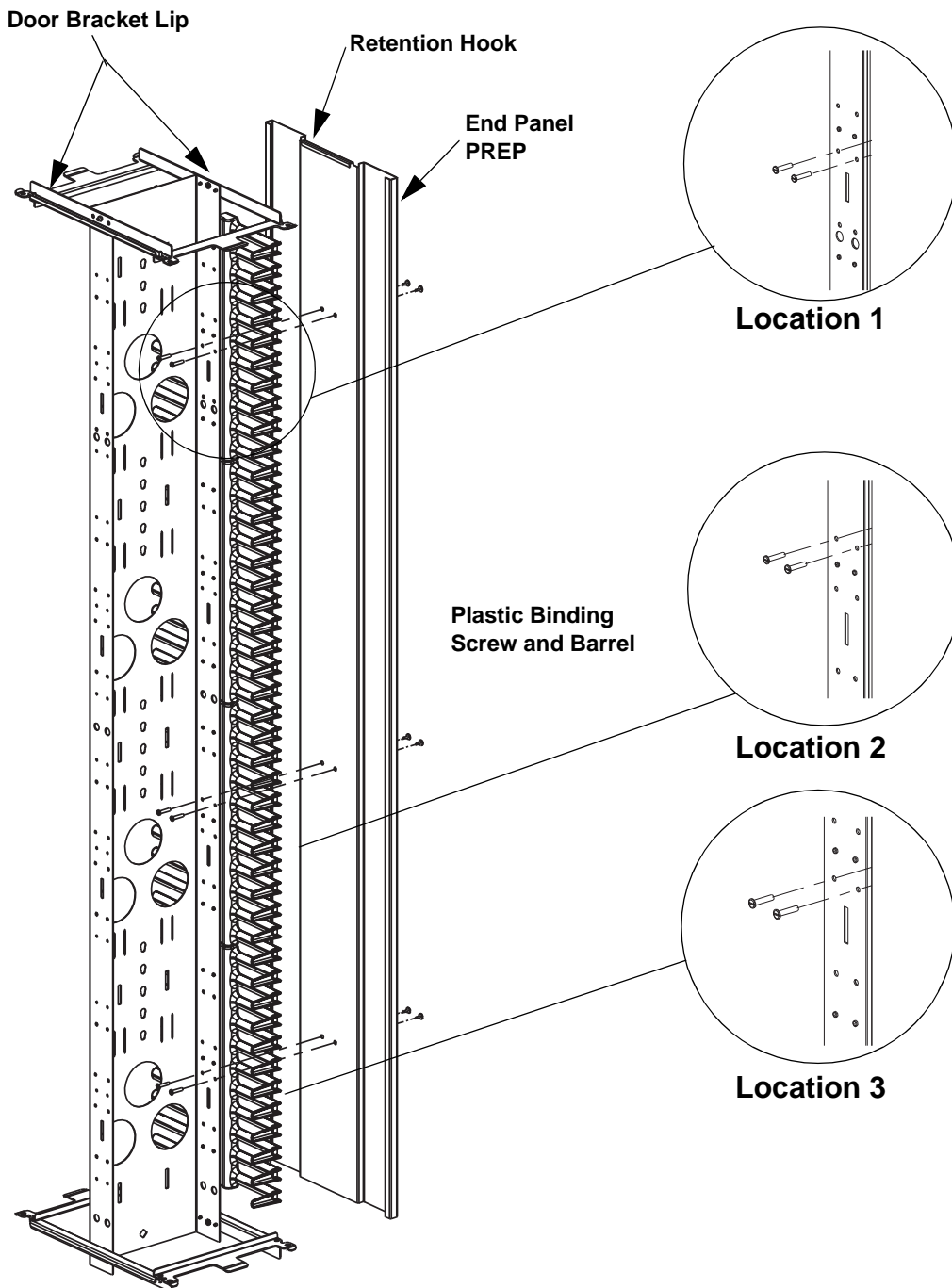

Geometry modified for clarification: Not
all molded fingers are shown

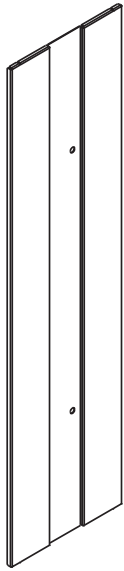
**WMPVHC45EP, WMPV45EP**

- (2) Endpanels
- (4).375-16 Acorn nuts
- (4).375 -16 Bolts

Assembly:**Step 1:**

Insert bolt into mounting location one.

Step 2:

Place End Panel over the bolt and hand tighten nut.

Step 3:

Insert bolt into location two a secure with acorn nut. Tighten acorn nut in location one.

Step 4:

Repeat steps 1-3 for upper end panel

NETRUNNER Installation Instructions

Note: Install lower end panel first when using a stacked configuration.

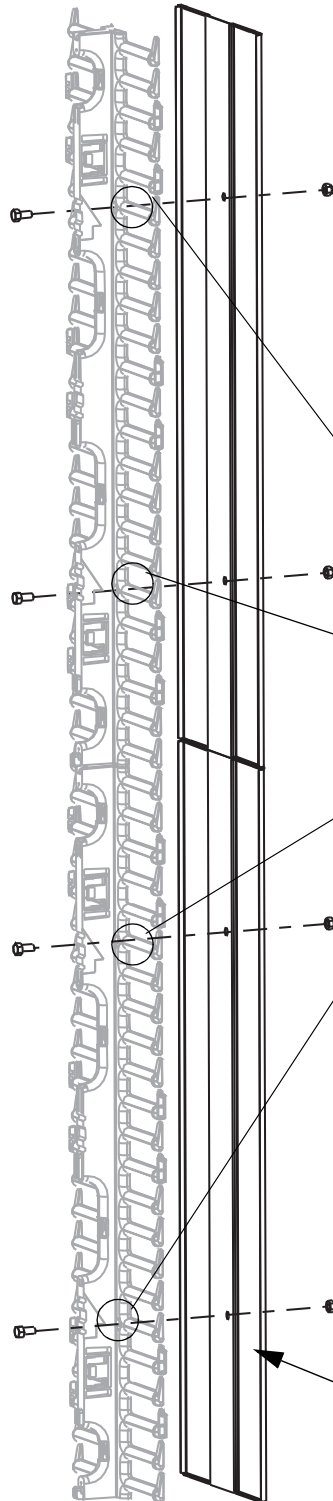
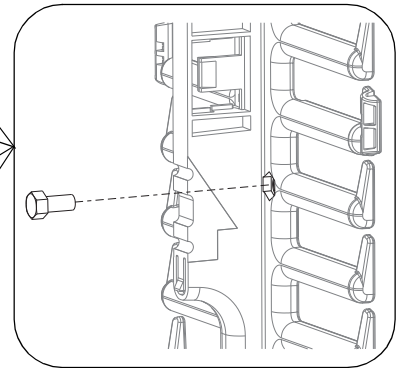
**Mounting Locations**

End Panel
WMPVHC45EP (Shown)

Geometry modified for clarification: Not all molded fingers are shown

For instructions in Local Languages
and Technical Support:

www.panduit.com/resources/install_maintain.asp



E-mail:
cs@panduit.com
Fax:
(708)444-6448