

NKPP48HDY

NKPPA48HDY

Module Installation

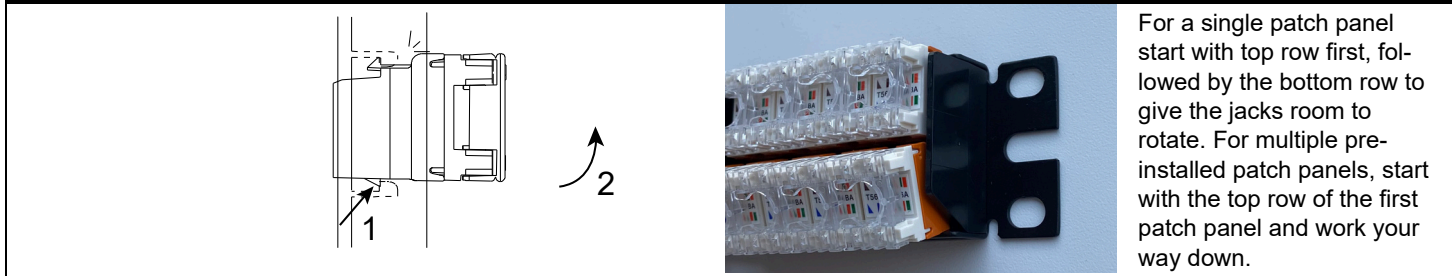

For a single patch panel start with top row first, followed by the bottom row to give the jacks room to rotate. For multiple pre-installed patch panels, start with the top row of the first patch panel and work your way down.

Module Removal

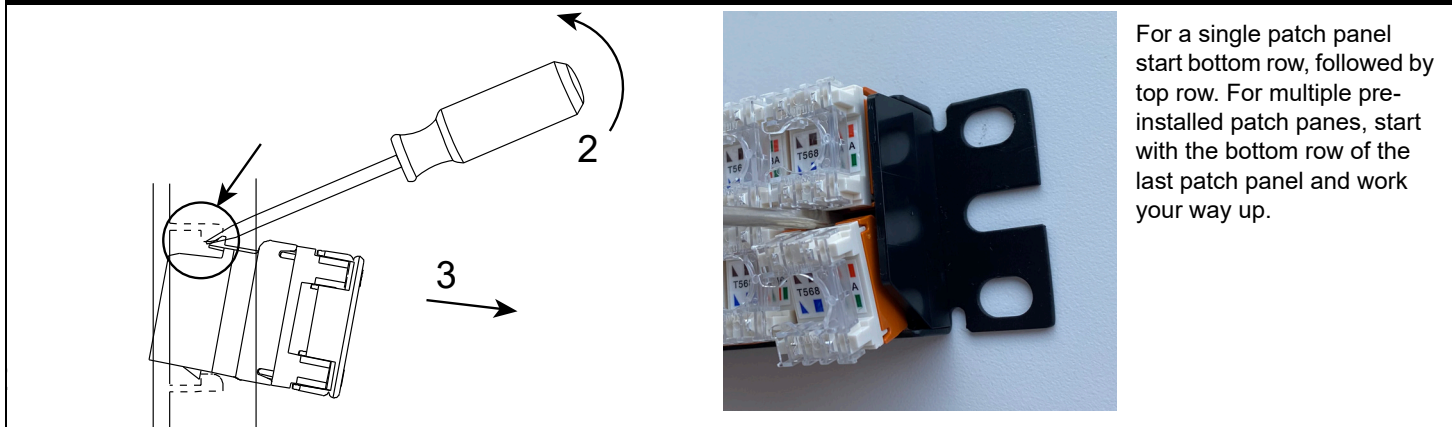

For a single patch panel start bottom row, followed by top row. For multiple pre-installed patch panels, start with the bottom row of the last patch panel and work your way up.

All cables should flow directly into vertical cable managers on the corresponding side of the Angled Panel.

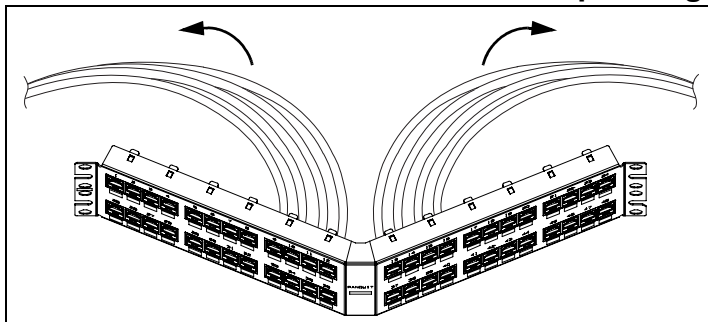

Recommended cable routing for terminated modules.

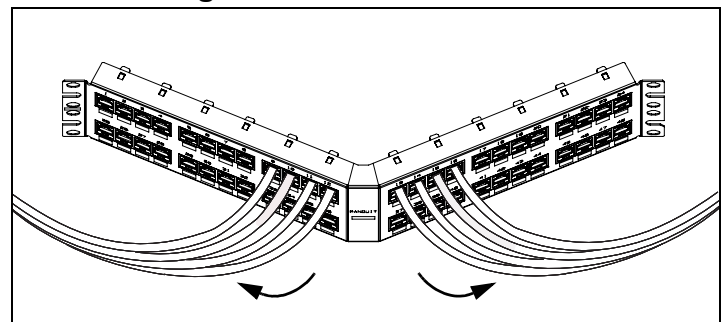

Recommended cable routing for patch cords.