

THIS COPY IS PROVIDED ON A RESTRICTED BASIS AND IS NOT TO BE USED IN ANY WAY DETRIMENTAL TO THE INTERESTS OF PANDUIT CORP.

PANDUIT P/N	WEIGHT
CHD9C**	.29 LB/10 PCS (132.3 g/10 PCS)

- NOTES:
- SEE CURRENT CATALOG FOR ADDITIONAL PART NUMBER SUFFIXES TO INDICATE COLOR AND OR PACKAGE QUANTITY.
 - SEE CATALOG FOR COMPLETE LIST OF PARTS APPLICABLE FOR USE WITH THIS PART.
 - DIMENSIONS IN PARENTHESES ARE IN METRIC.
 - PART TO WORK WITH ALL PANDUIT FACEPLATE FRAMES.

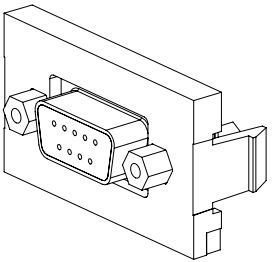
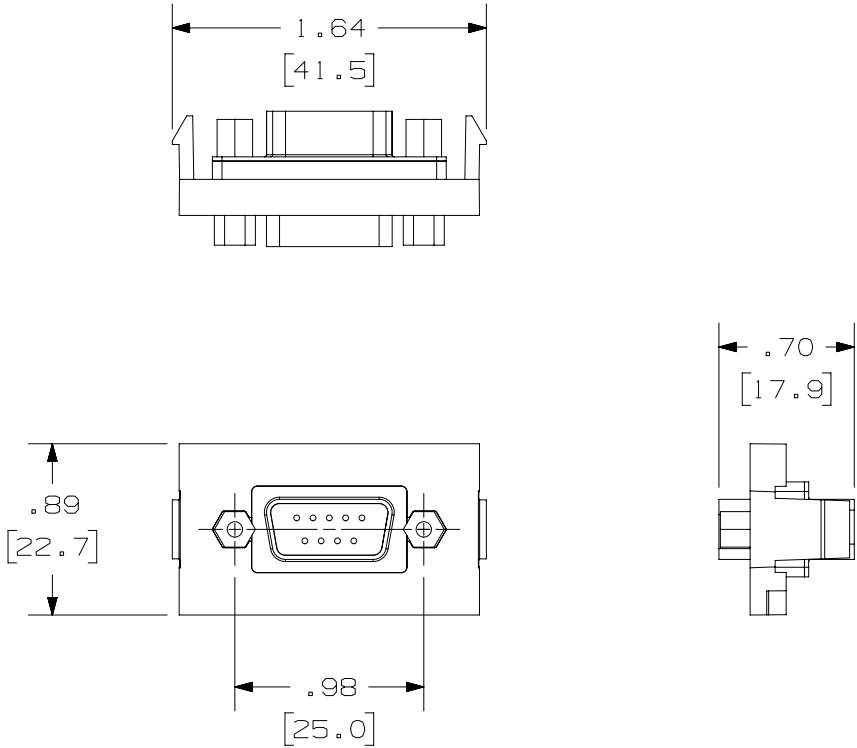

PART NUMBER		SEE TABLE	
TITLE		9 PIN SVGA 1/3 INSERT COUPLER	
		CUSTOMER DRAWING	
ITEM REVISION NAME		M01095AA/04	PANDUIT
DATASET FILE NAME		M01095AA_DC/04A	
UNLESS OTHERWISE SPECIFIED, DIMENSIONAL TOLERANCES ARE: IN (mm)		MATERIAL:	
.x ± .xxx ± .010 (.3)			
.xx ± .03 (.8) ANGLES ±		DRAWING NUMBER:	
THIRD ANGLE PROJECTION		01095-06	
DRAWN BY	DATE	CHK	SCALE
JSP	1-26-01	PBD	NONE
SHT 1 OF 1		SIZE	
		A	

REV	DATE	BY	CHK	APR	DESCRIPTION	ECN
04A	6-28-22	BJN	ROJC	MMR	E. REMVD IAPHD9CWH D. CAD MODEL UPDATED TO REV 04 REVISED & REDRAWN PREVIOUS REVISIONS REMVD FOR CLARITY	01095-06

D10100DA/14

2

1

2

1