

2

1

THIS COPY IS PROVIDED ON A RESTRICTED BASIS AND IS NOT TO BE USED IN ANY WAY DETRIMENTAL TO THE INTERESTS OF PANDUIT CORP.

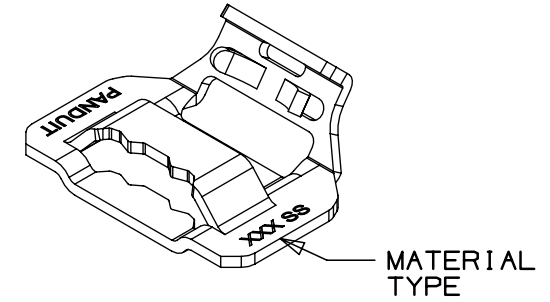
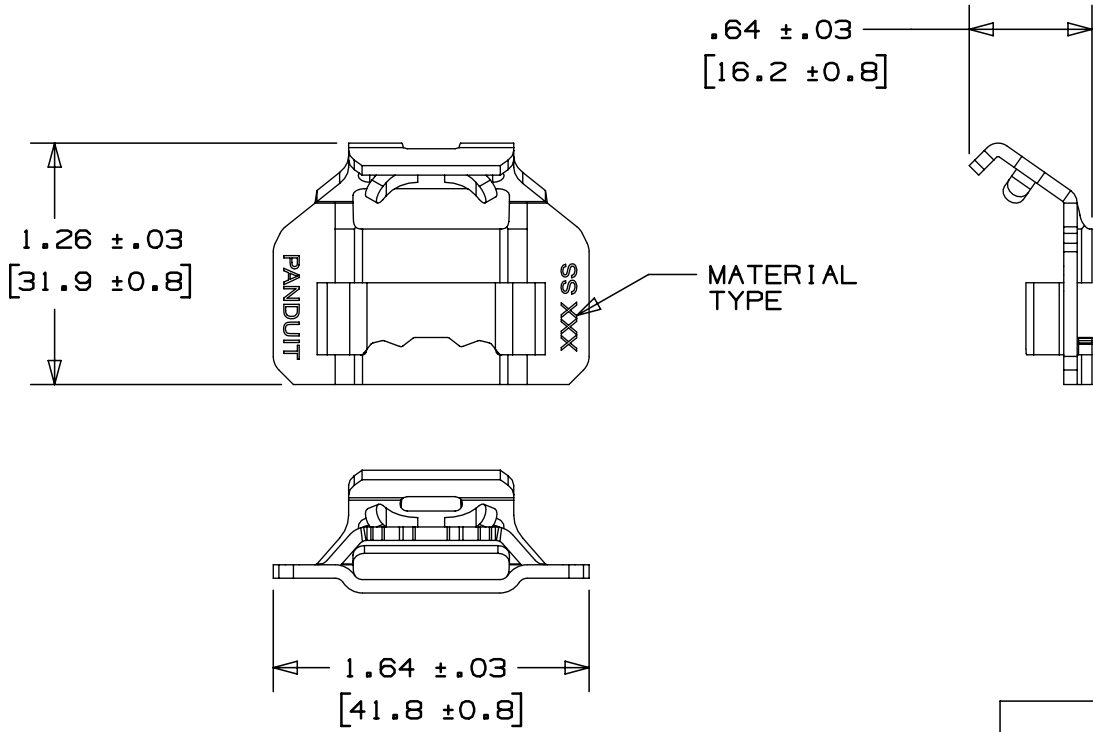

ISOMETRIC VIEW SHOWN FOR REFERENCE ONLY

- NOTES:
1. APPLICATION TOOLS: BT75SDT
 2. BRACKETS [] DENOTES DIMENSIONS ARE IN MILLIMETERS AND ARE FOR REFERENCE ONLY
 3. MATERIAL: STAINLESS STEEL
 4. MATERIAL THICKNESS: .070 ± .005

PANDUIT PART NUMBER	PACKAGE QUANTITY	MATERIAL TYPE	FOR USE WITH PANDUIT CONTINUOUS BANDING
MSBW75-C2	100	201 SS	MSW75T30-CR2
MSBW75-C6	100	316 SS	MSW75T30-CR6

REV	DATE	BY	CHK	APR	DESCRIPTION	ECN
04A	6/25/18	RUMO	RGRO	RGRO	REMOVED BUCKLE CURVATURE; 1.26 ± .03 WAS 1.31 ± .03; .64 ± .03 WAS .55 ± .03	037873
03A	4/13	JAMB	SKB	---	UPDATE DRAWING TO NEW GLOBAL PANDUIT TITLE BLOCK WITH PANDUIT LOGO. ADDED TO NOTE #2: "AND ARE FOR REFERENCE ONLY"	SSECN01057
02A	6/10	JAMB	SKB	---	ADDED PART NUMBER MSBW75-C6 TO TABLE. ADDED "MATERIAL TYPE" TO TABLE. ADDED "FOR USE WITH...ETC" TO TABLE.	-----
01A	5/09	MIM	CCH	---	DRAWING RELEASED	-----

TITLE				MS75 METAL STRAPPING LOOSE PIECE BUCKLES			
				CUSTOMER DRAWING			
ITEM REVISION NAME				N41285BS/04			
DATASET FILE NAME				N41285BS_DC/04A			
UNLESS OTHERWISE SPECIFIED, DIMENSIONAL TOLERANCES ARE: IN [mm]				PANDUIT			
.x ± .1 [2.54] .xxx ± .005 [.127] .xx ± .01 [.25] ANGLES ± 5 °							
				THIRD ANGLE PROJECTION			
DRAWN BY		DATE		CHK		SCALE	
MIM		5/09		SKB		NONE	
DRAWING NUMBER:				N41285BS_DC			
SHT 1 OF 1				SIZE A			

2

1