

NOTA:
Los pasos 1 a 5 muestran el método de preparación para el cable TX6A con tecnología MaTriX; similar para otros cables.

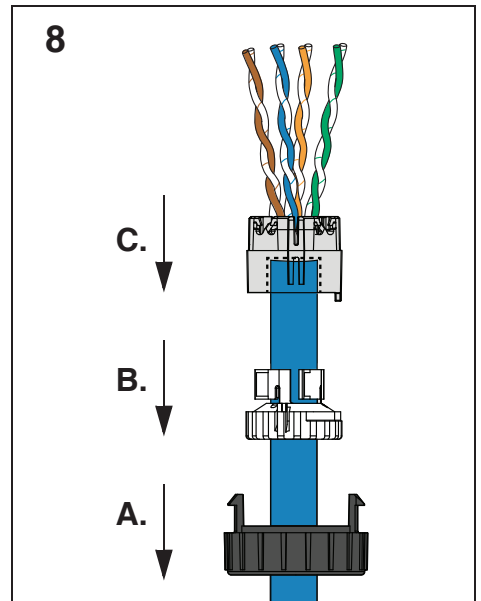

9 Cableado del Lado 1 para Módulo de Empalme*

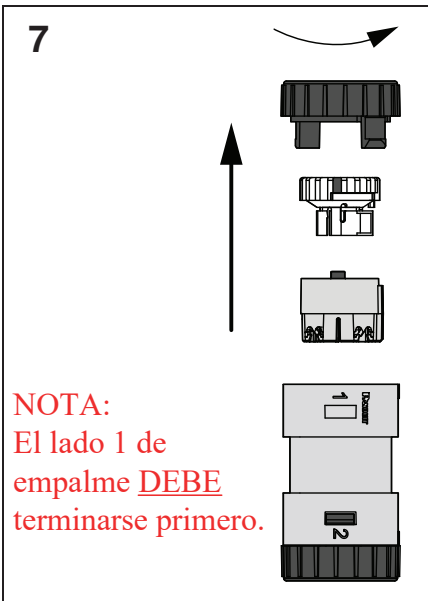
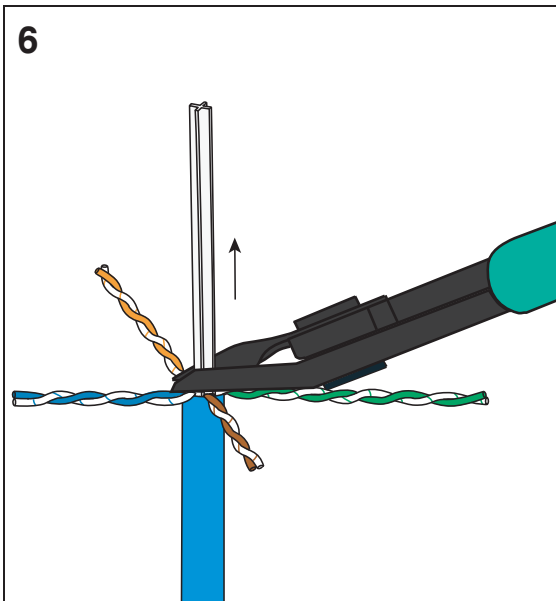
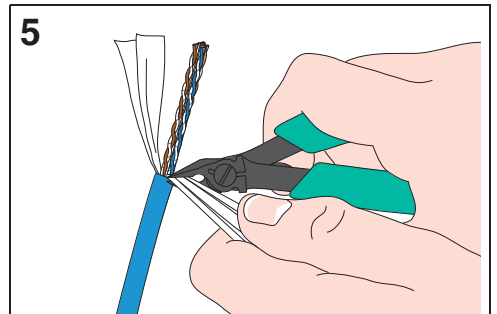
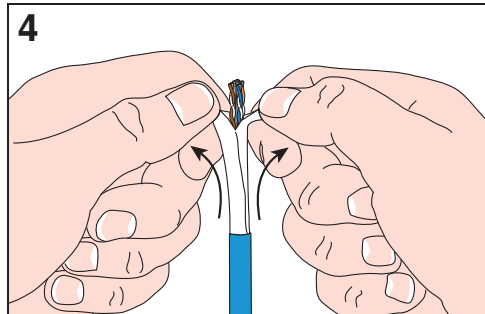
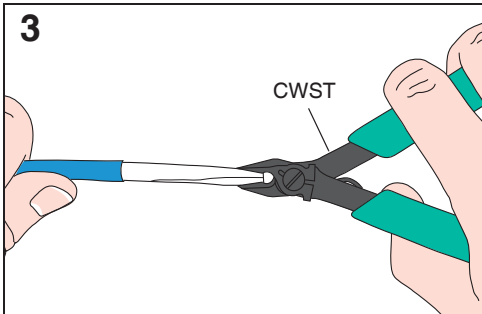
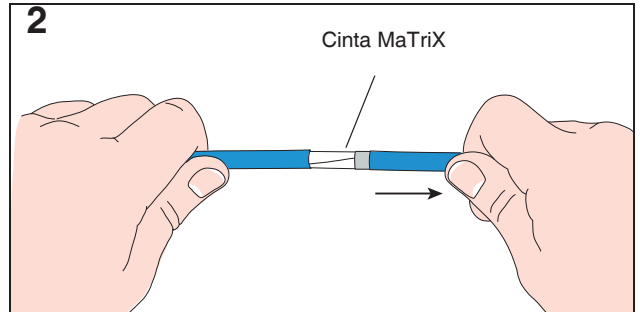
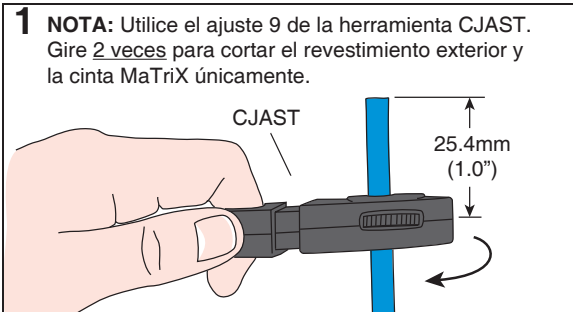
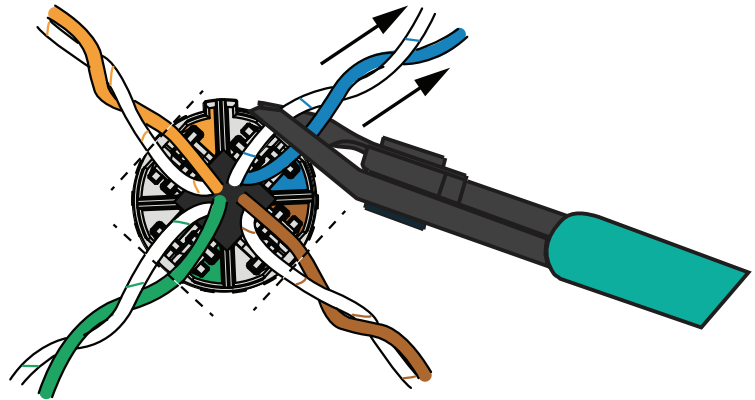
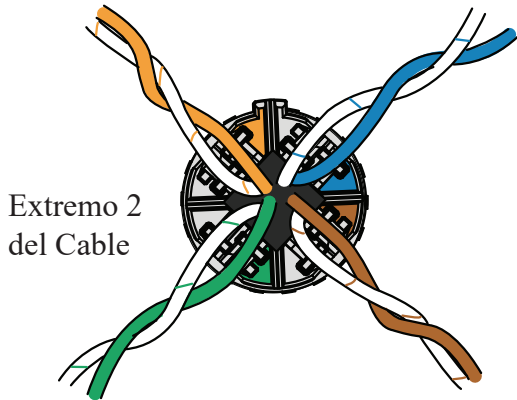
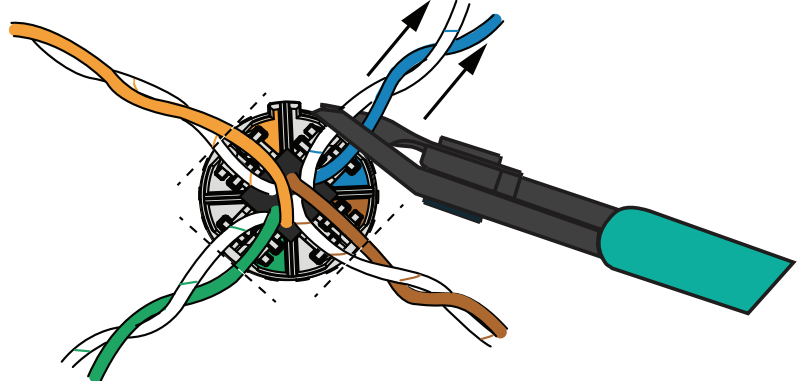
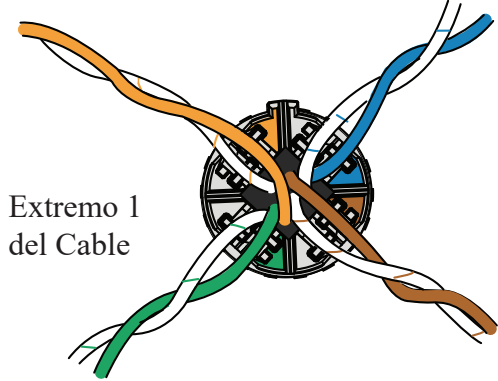

* El cable/plug 6A de Panduit suministrado es cableado T568B

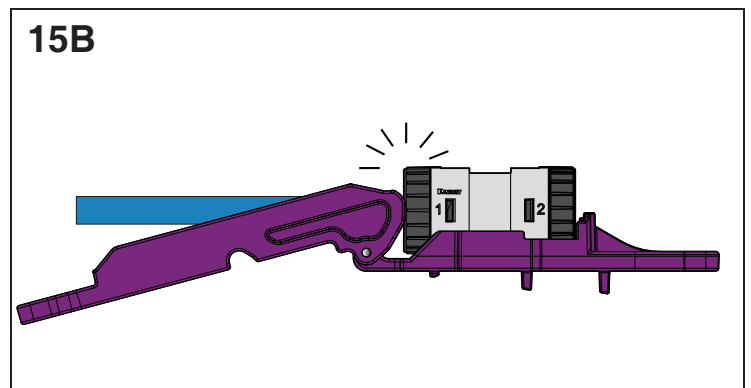
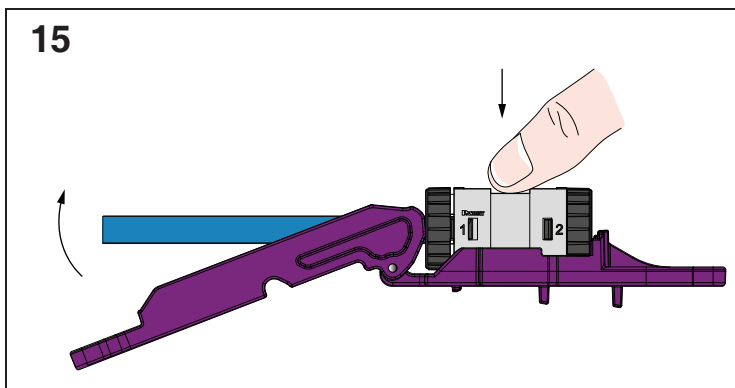
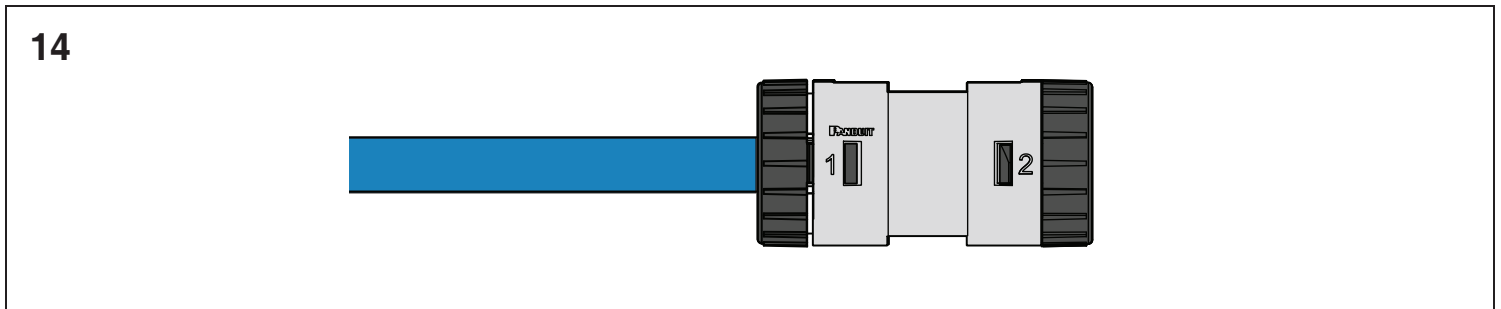
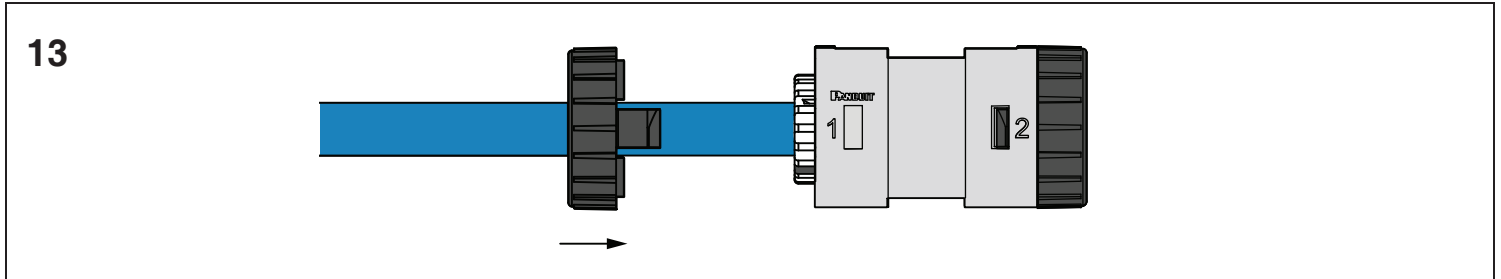
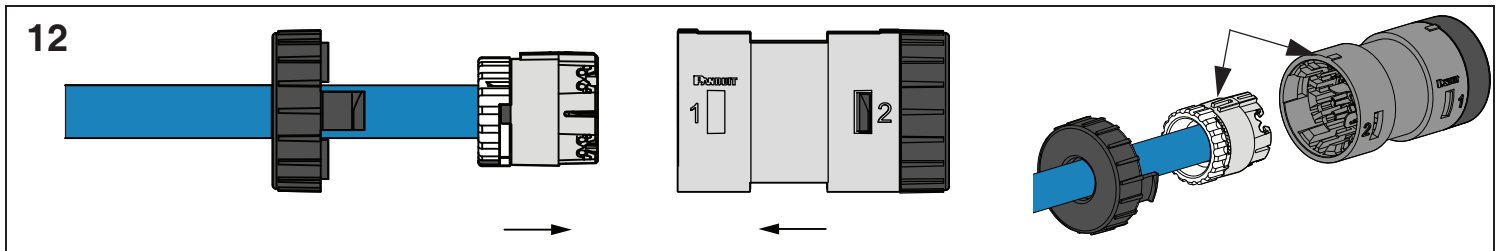
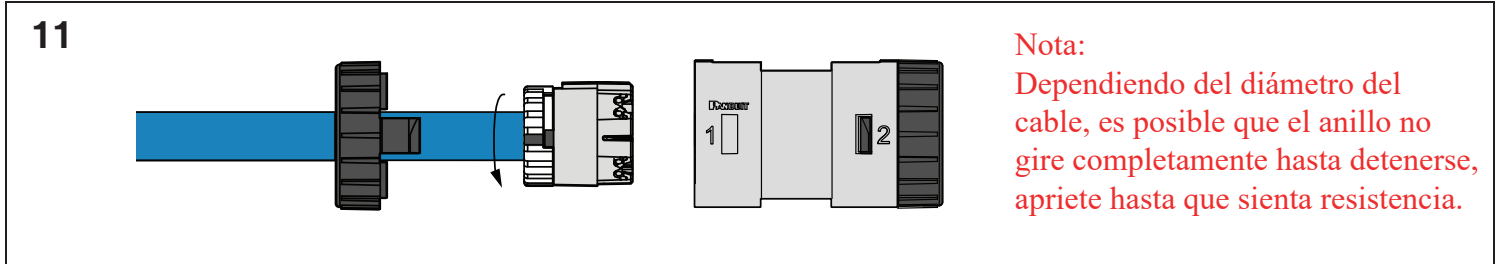
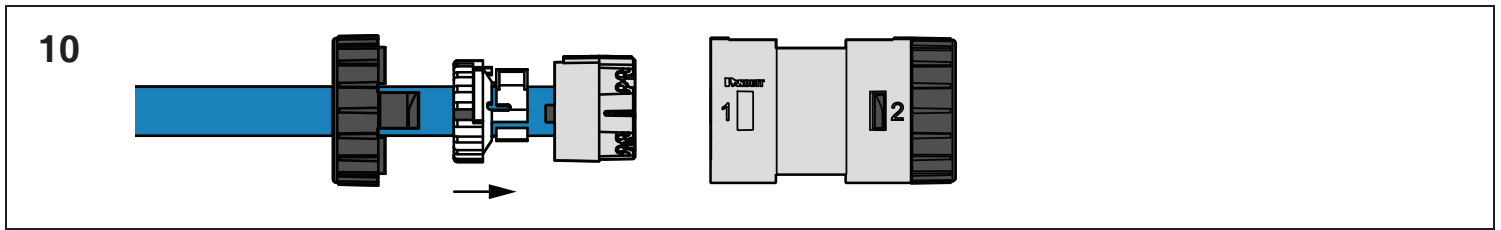

16A Cableado T568B Lado 2

Extremo 1 del Cable

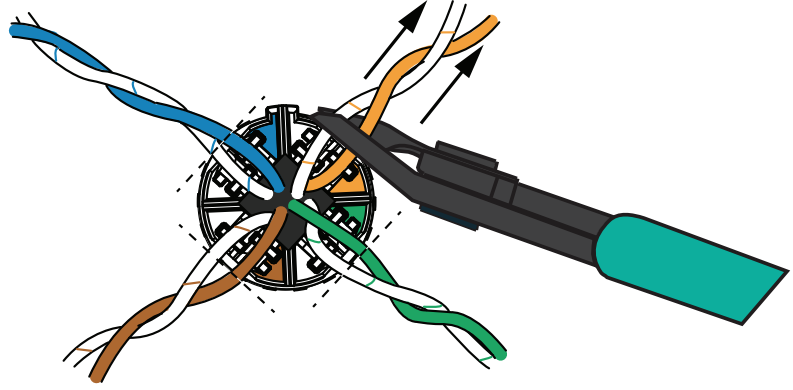
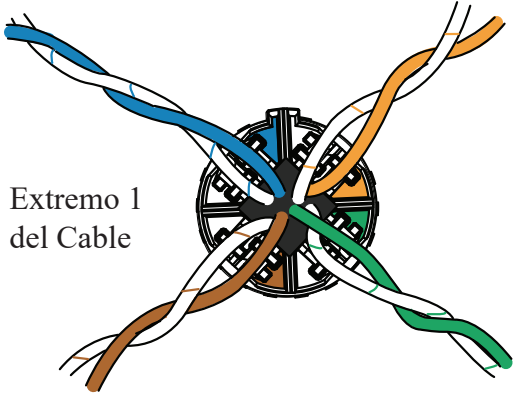

Extremo 2 del Cable

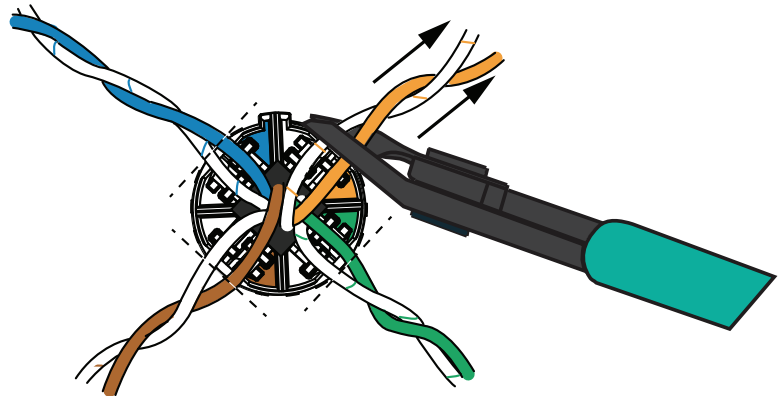
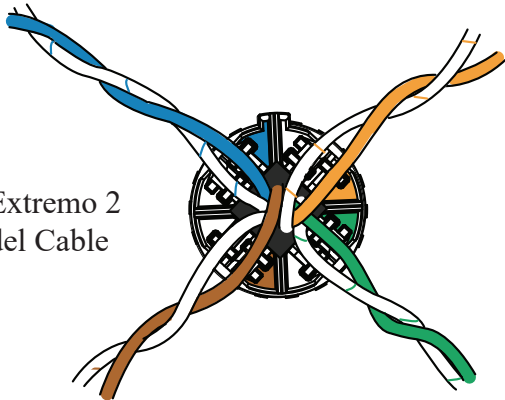

16B Cableado T568A Lado 2

Extremo 1 del Cable

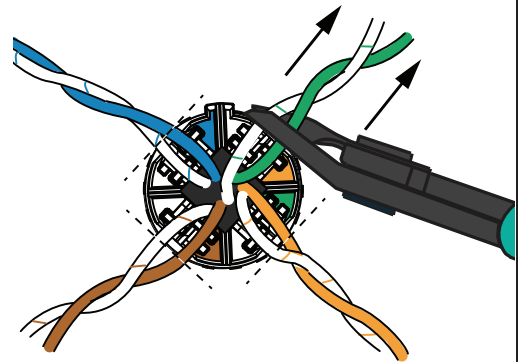
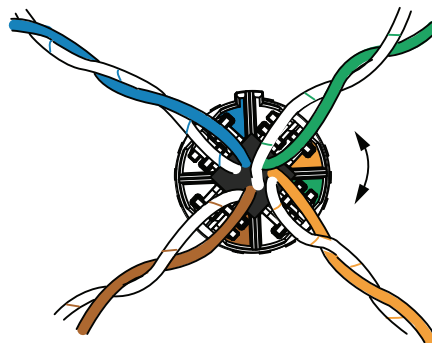
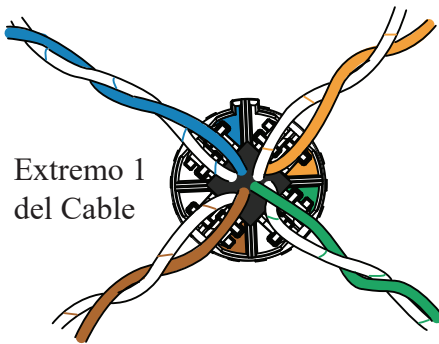

Extremo 2 del Cable

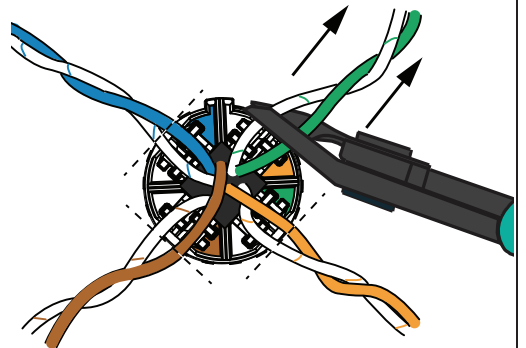
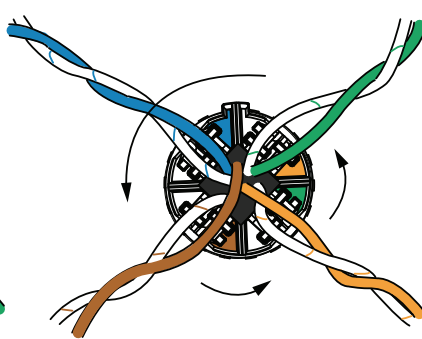
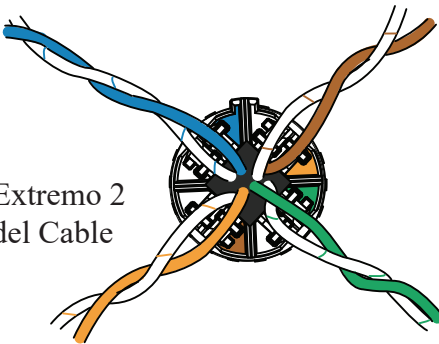

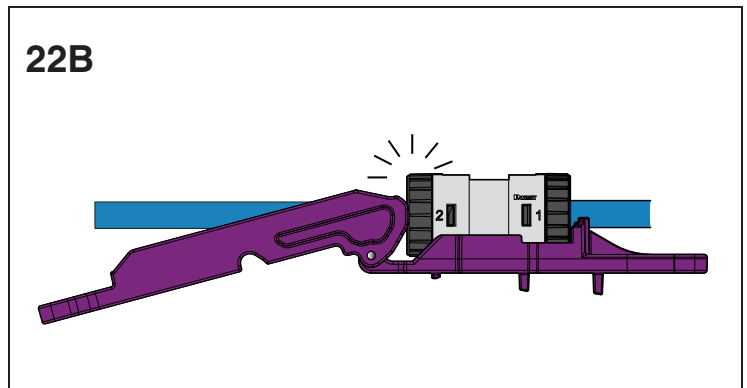
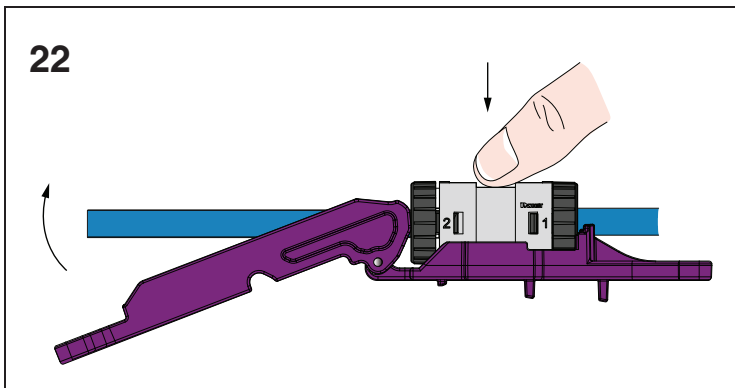
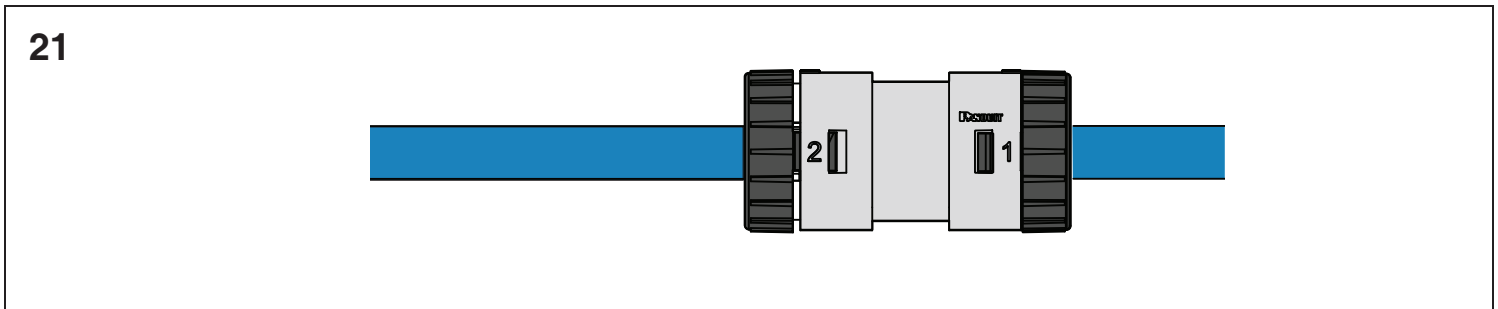
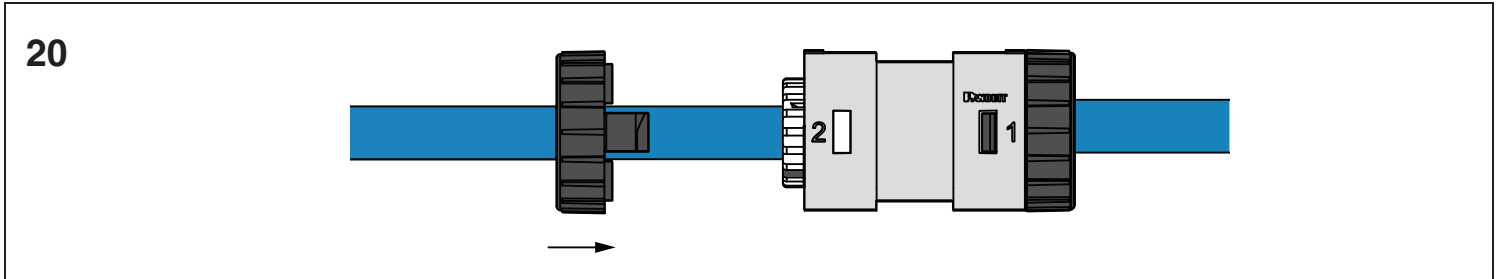
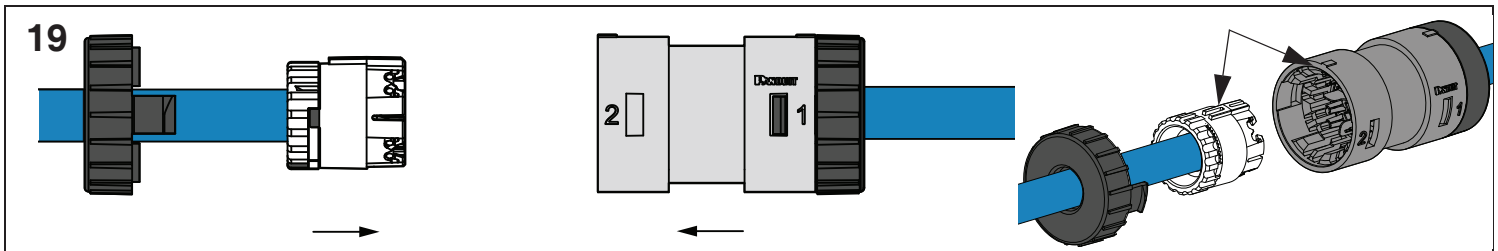
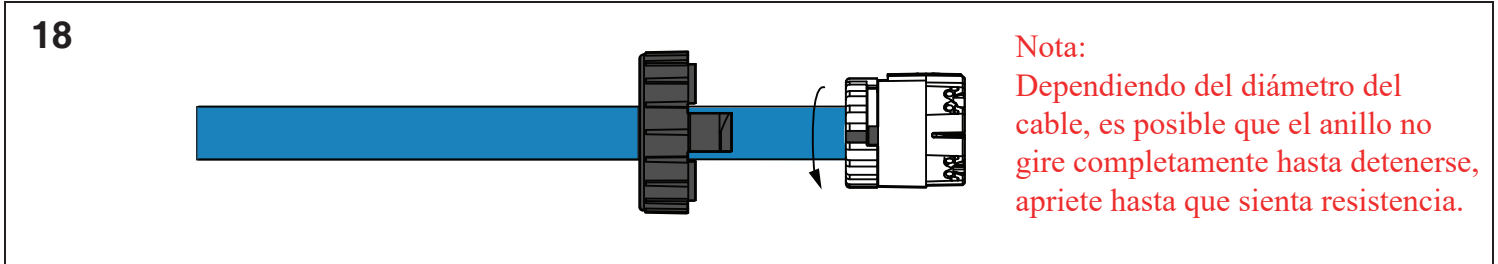
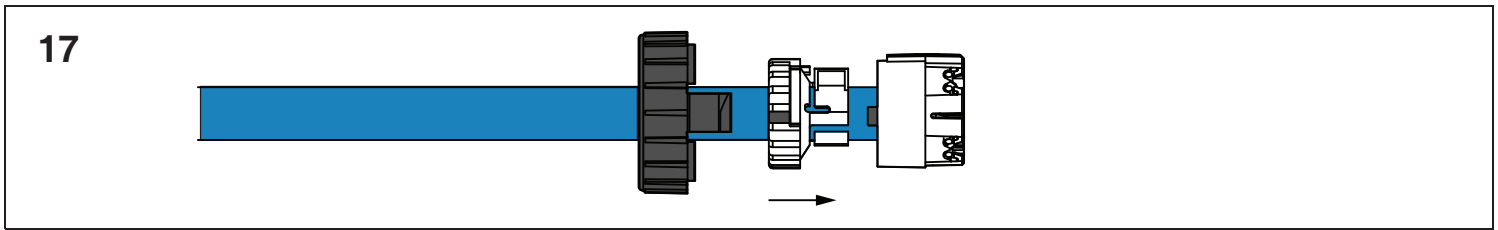

PASOS PARA EXTRACCIÓN

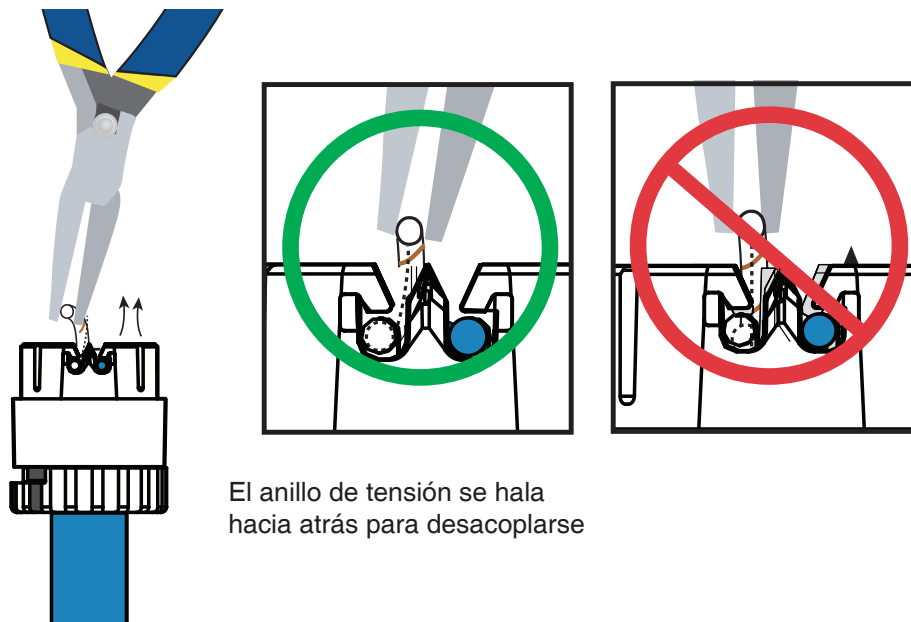

Notes:

1. Para obtener el rendimiento especificado, siga la guía de instalación de TIA/EIA 568.2-D.
2. Los módulos *jack* blindados pueden terminar un cable de datos IWC sólido o multifilar de 22-26 AWG con un diámetro externo de aislamiento de conductor de máximo 1.52mm (0.060").
3. Los módulos *jack* blindados se pueden volver a terminar a un mínimo de 20 veces.
4. Para obtener información técnica y de rendimiento, comuníquese con el Soporte Técnico de Panduit.

Al igual que con todos los accesorios de cableado, se aplican las siguientes declaraciones:

1. Nunca instale cableado de comunicaciones durante una tormenta eléctrica.
2. Nunca instale cableado de comunicaciones en lugares húmedos a menos que el conector esté diseñado específicamente para su uso en lugares húmedos.
3. Nunca toque terminales o cableado de comunicación sin aislamiento a menos que la línea de comunicación haya sido desconectada en la interfaz de red.
4. Tenga cuidado al instalar o modificar el cableado de comunicación



Intertek
5020430

Cumple con UL
STD 1863.

Certificado según CSA
STD C22.2#233

Para Obtener Instrucciones en su Idioma
y Soporte Técnico, consulte:
www.panduit.com/resources/install_maintain.asp

PANDUITTM
www.panduit.com

Correo electrónico:
techsupportlatam@panduit.com
Teléfono:
1-800-969-4200 | Guadalajara - México