

THIS COPY IS PROVIDED ON A RESTRICTED BASIS AND IS NOT TO BE USED IN ANY WAY DETRIMENTAL TO THE INTERESTS OF PANDUIT CORP.

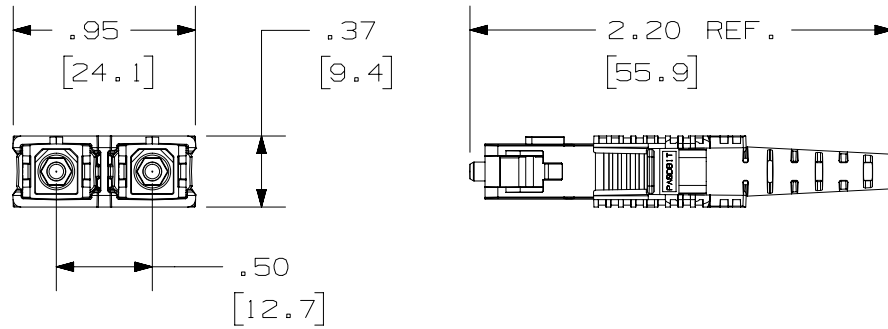

ABOVE VIEWS SHOWN WITHOUT DUSTCAPS

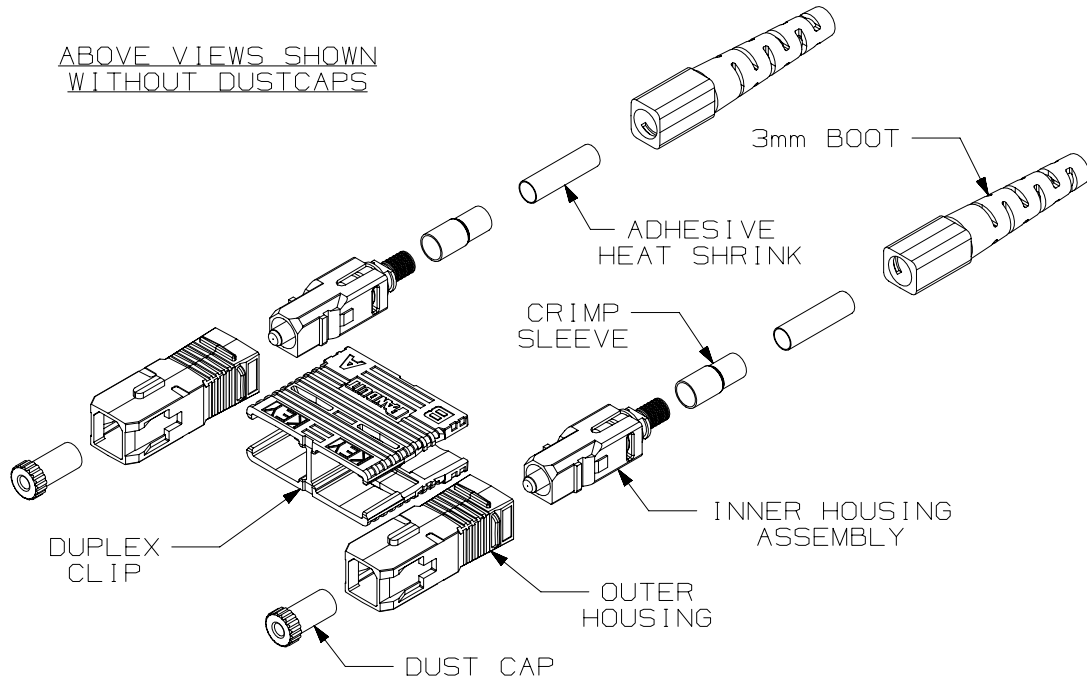

PANDUIT PART NUMBER	ACCEPTS FIBER TYPE	WEIGHT
FSCDM	50/125um MULTIMODE	86.4g/10 pcs [3.05 oz/10 pcs]
	50/125um OM3 MULTIMODE	86.4g/10 pcs [3.05 oz/10 pcs]
	62.5/125um MULTIMODE	86.4g/10 pcs [3.05 oz/10 pcs]

NOTES:

- SEE CATALOG FOR ADDITIONAL PART NUMBER SUFFIXES TO INDICATE COLOR AND/OR PACKAGE QUANTITY.
- ACCEPTS 50/125um, 62.5/125um OR 50/125 OM3 MULTIMODE, 900um BUFFERED GLASS OPTICAL FIBER.
- FULLY COMPLIES WITH THE FIBER OPTIC CONNECTOR PERFORMANCE REQUIREMENTS AS SPECIFIED BY TIA/EIA-568-B.3.
- MATERIAL:
BODY/HARDWARE: PLASTIC
BOOT: THERMOPLASTIC RUBBER
FERRULE: ZIRCONIA CERAMIC
- DIMENSIONS IN BRACKETS ARE METRIC [mm].
- 1.6/2.0mm AND 900um BOOTS ARE AVAILABLE.

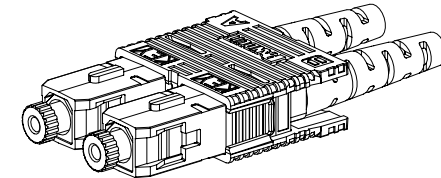

PART NUMBER		FSCDM		
TITLE				
FIBER OPTIC DUPLEX SC CONNECTOR				
CUSTOMER DRAWING				
ITEM REVISION NAME		M01069AF/01		
DATASET FILE NAME		M01069AF_DC/01A		
UNLESS OTHERWISE SPECIFIED, DIMENSIONAL TOLERANCES ARE: IN [mm]				
.X ±		.XXX ±		
.XX ±		ANGLES ±		
				DRAWING NUMBER:
				01069-21
DRAWN BY	DATE	CHK	SCALE	SHT 1 OF 1
MC	6-14-06	GLK	NONE	A

REV	DATE	BY	CHK	APR	DESCRIPTION	ECN
3	02-26-16	SAT	JGD	JGSW	RELEASED TO PRODUCTION	01069-21

D101000DA/14