

THIS COPY IS PROVIDED ON A RESTRICTED BASIS AND IS NOT TO BE USED IN ANY WAY DETRIMENTAL TO THE INTERESTS OF PANDUIT CORP.

PART NO.	MAX. BUNDLE DIA [mm]	LENGTH L±.1 [mm]
MSC2W38T15-L6	2" [51]	11.8" [300]
MSC4W38T15-L6	4" [102]	18.0" [457]
MSC6W38T15-L6	6" [152]	24.4" [620]
MSC8W38T15-L6	8" [203]	30.7" [780]
MSC10W38T15-L6	10" [254]	37.0" [940]

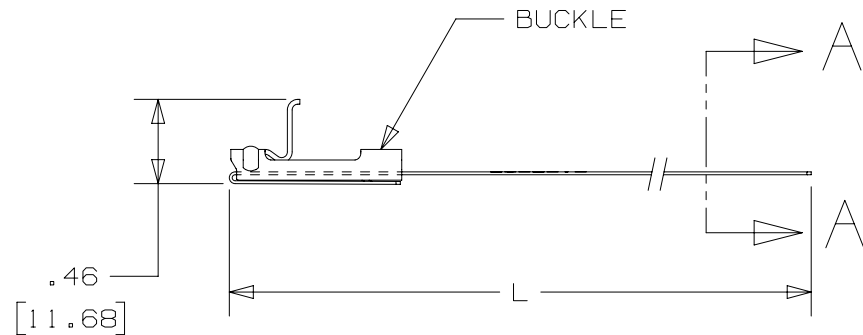
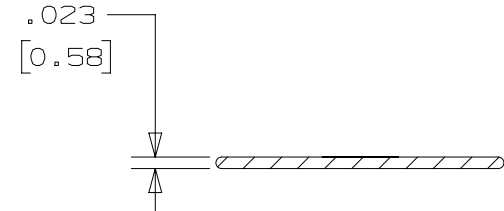
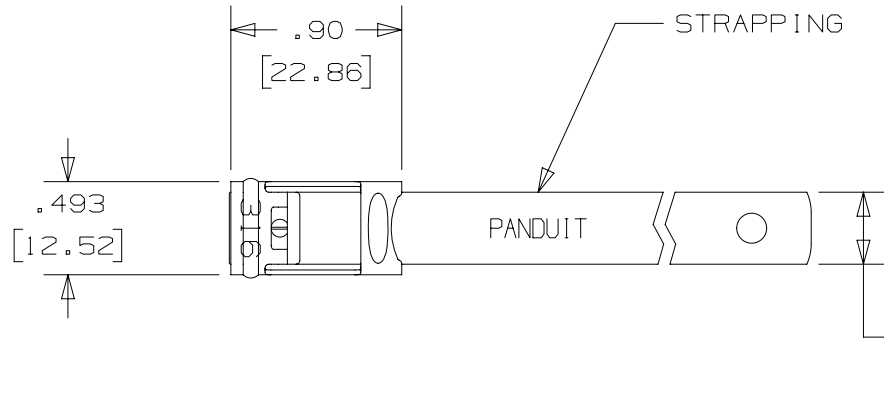

NOTES:

1. APPLICATION TOOLS: BT2HT.
2. ALL DIMENSIONS IN [] ARE mm.
3. BASE MATERIAL: 316 STAINLESS STEEL.
4. 100% COATED WITH BLACK NYLON.
5. COATING THICKNESS: .003/.005 [.076/.127] PER SIDE.
6. TOLERANCES (UNLESS OTHERWISE SPECIFIED):
 .X ± .03 [.8]
 .XX ± .02 [.5]
 .XXX ± .007 [.18]

REV	DATE	BY	CHK	APR	DESCRIPTION	ECN
04A	09-05-23	DPOI	JBN	MRWA	NOTE UPDATE. APPLICATION TOOL FROM BT2MS75, BT1HT TO BTH2T.	132977/01
03A	08-03-23	DPOI	JBN	MRWA	CHANGE NOTE 4: REMOVE "OR POLYESTER".	132977/00
02A	04-13-14	JAMB	MIM	RGRO	UPDATE DRAWING TO NEW GLOBAL PANDUIT TITLE BLOCK WITH PANDUIT LOGO.	SSECN01047
01A	10-08-14	JAMB	SKB	SKB	ORIG CAD FILE SPEC WAS S41167_01.	-----
00	10-03-14	DFTR	ENG	PM	INITIAL RELEASE.	11159

PART NUMBER		COATED METAL STRAPPING .375" [9.52] WIDE		
CUSTOMER DRAWING				
ITEM REVISION NAME		N41167BS/04		
DATASET FILE NAME		N41167BS_DC/04A		
		THIRD ANGLE PROJECTION		
MATERIAL		SEE NOTES		
DRAWN BY		DATE	CHK	SCALE
BRH		10-03-2014	EJD	1:1
DRAWING NUMBER				N41167BS_DC
SHEET 1 OF 1				A

A-SIZE CUSTOMER

2

1

2

1