

THIS COPY IS PROVIDED ON A RESTRICTED BASIS AND IS NOT TO BE USED IN ANY WAY DETRIMENTAL TO THE INTERESTS OF PANDUIT CORP.

PANDUIT P/N	WEIGHT
P36G34M-XXYZ	SEE SHEET 2

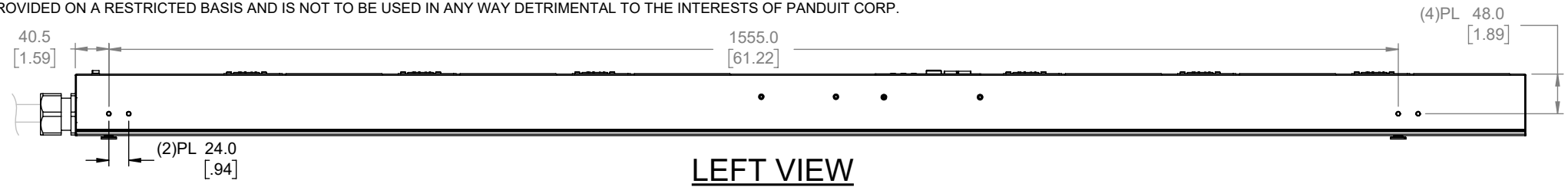

LEFT VIEW

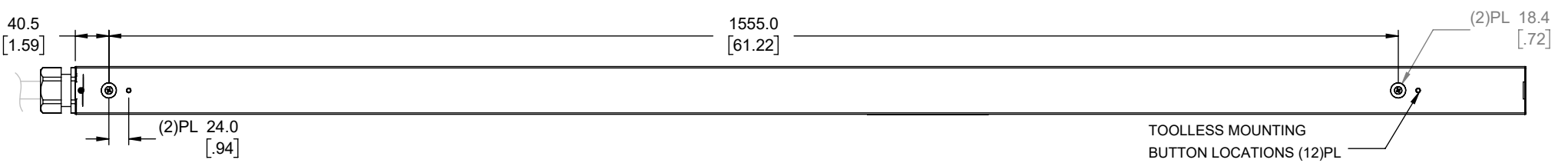

REAR VIEW

TOOLLESS MOUNTING
BUTTON LOCATIONS (12)PL

SPECIFICATION:

- 1. STANDARD
 - UNIT TYPE: MONITORED & SWITCHED PER OUTLET
 - ORIENTATION: VERTICAL, 0U FULL
 - OUTLET QTY & TYPE: (24)C13, (12)C19
 - INPUT VOLTAGE: 415VAC (NAM)
 - INPUT CURRENT: 60A (48A DERATED)
 - BREAKER QTY & TYPE: (12) 20A, SINGLE-POLE 10KAIC
 - INPUT PHASE: THREE-PHASE (WYE)
 - RATED POWER: 34.5kVA (NA ONLY, W-TYPE CORD)
 - INPUT PLUG: SEE TABLE SHEET 2
 - INPUT POWER CORD: SEE TABLE SHEET 2
 - REGULATORY STANDARD: RoHS COMPLIANT
- 2. ADDITIONAL:
 - OUTLET CONTROL RELAY: NORMALLY OPEN 80AMP INRUSH
- 3. ACCESSORIES:
 - (1) QUICK-START GUIDE

NOTES:

- PRIMARY DIMENSIONS ARE IN MILLIMETERS. SECONDARY DIMENSIONS ARE IN [INCHES]
- INSTALLATION SHALL COMPLY WITH ALL APPLICABLE NATIONAL, STATE, AND LOCAL CODES
- VISIT OUR ON-LINE CATALOG AT WWW.PANDUIT.COM FOR A CURRENT LIST OF PRODUCTS APPLICABLE FOR USE WITH THIS PRODUCT
- FOR FULL PRODUCT FUNCTIONALITY REFER TO USER MANUAL
- DRAWING VIEWS SHOW THE INPUT CORD IN THE "TOP END FED" CONFIGURATION

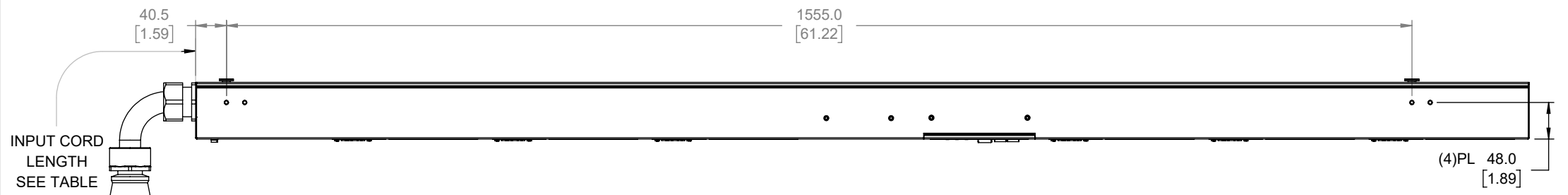

RIGHT VIEW

INPUT CORD LENGTH
SEE TABLE
SHEET 2

20 AMP, SINGLE-POLE, 10KAIC
ELECTRO MECHANICAL SWITCH/
BREAKER (12)PL

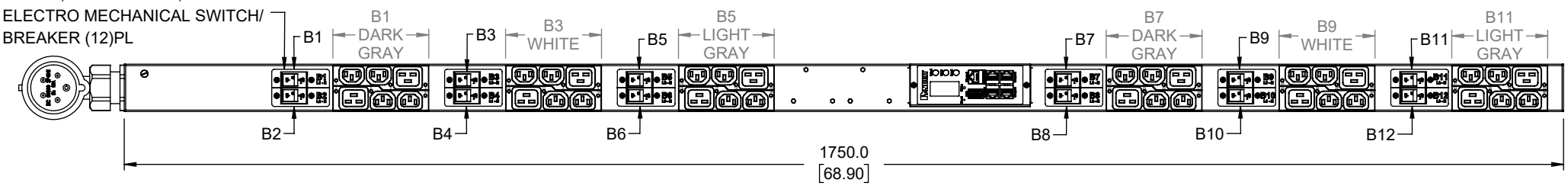

FRONT VIEW

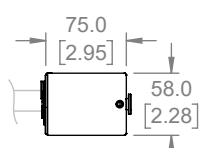

BOTTOM VIEW

IDENTIFICATION

FOR FINISHED GOOD PART NUMBER & DESCRIPTION TABLE SEE SHEET 2 CONFIGURABLE PART NUMBERS: P36G34M-XXYZ

XX: FINISHED GOOD COLOR BL = BLACK YL = YELLOW RD = RED BU = BLUE WH = WHITE GN = GREEN	Y: INPUT FEED TYPE 1 = TOP-END FED 2 = BOTTOM-END FED	Z: INPUT CORD LENGTH A = 1 METER B = 2 METER C = 3 METER
--	---	---

PLUG / RECEPTACLE BLOCK

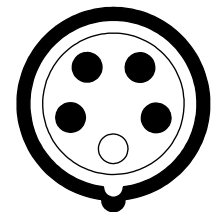

PLUG
IEC 60309, 4P 5W, 6H
IP44 (SPLASHPROOF)
60A/ 63A, 415VAC MAX RATED INPUT
(48A DERATED)



RECEPTACLE
IEC 60320 C13
10A, 250V MAX RATED OUTPUT



RECEPTACLE
IEC 60320 C19
16A, 250V MAX RATED OUTPUT

REV.	DATE	BY	CHK	APR	DESCRIPTION	ECN
03A	08/25/2022	WAC	PJST	MJD	CORRECTED BREAKER LABEL ORIENTATION	P36G34M
02B	04/14/2022	WAC	PJST	MJD	REVISED SPEC TO SHOW (NAM ONLY, W-TYPE CORD)	P36G34M
02A	04/08/2022	WAC	PJST	MJD	CORRECTION MADE TO CHASSIS LENGTH, INCREASED FROM 1679 TO 1750	P36G34M
01A	12/03/2021	WAC	PJST	MJD	INITIAL DC RELEASE	P36G34M

REVISIONS

WE ASK THAT YOU CHECK FULLY THE DIMENSIONS, NOTES, AND SIGN THE CLIENT SIGNATURE BOX. THE JOB WILL NOT PROGRESS WITHOUT SIGNED APPROVAL. PLEASE DO NOT DELAY IN RETURNING PROOF AS IT WILL AFFECT DELIVERY.

SIGN _____
DATE _____
PRINT _____

TITLE
INTELLIGENT SERIES PDU
P36G34M-XXYZ
CUSTOMER DRAWING

ITEM REVISION NAME
DATASET FILE NAME

PANDUIT

MATERIAL: N/A

DRAWING NUMBER: P36G34M_DC

BY: WAC DATE: 11/10/2021 CHK: - SCALE: NTS SHEET 1 OF 2 SIZE: B

THIS COPY IS PROVIDED ON A RESTRICTED BASIS AND IS NOT TO BE USED IN ANY WAY DETRIMENTAL TO THE INTERESTS OF PANDUIT CORP.



FINISHED GOOD PART NUMBER	FINISHED GOOD DESCRIPTION	COLOR	INPUT CORD LENGTH	WEIGHT
P36G34M	MSPO PDU, 60AMP, (24)C13, (12)C19, IEC 60309 3P+E 6H-3M, TOP FED, BLACK	BLACK (9005)	3M (+254MM / -127MM) [10'(+10"/-5")]	12.6kg

B

B

A

A

REV.	DATE	BY	CHK	APR	DESCRIPTION	ECN
03A	08/25/2022	WAC	PJST	MJD	CORRECTED BREAKER LABEL ORIENTATION	P36G34M
02B	04/14/2022	WAC	PJST	MJD	REVISED SPEC TO SHOW (NAM ONLY, W-TYPE CORD)	P36G34M
02A	04/08/2022	WAC	PJST	MJD	CORRECTION MADE TO CHASSIS LENGTH, INCREASED FROM 1679 TO 1750	P36G34M
01A	12/03/2021	WAC	PJST	MJD	INITIAL DC RELEASE	P36G34M
REVISIONS						

WE ASK THAT YOU CHECK FULLY THE DIMENSIONS, NOTES, AND SIGN THE CLIENT SIGNATURE BOX. THE JOB WILL NOT PROGRESS WITHOUT SIGNED APPROVAL. PLEASE DO NOT DELAY IN RETURNING PROOF AS IT WILL AFFECT DELIVERY.

SIGN	
DATE	
PRINT	

TITLE
INTELLIGENT SERIES PDU
P36G34M-XXYZ
 CUSTOMER DRAWING

ITEM REVISION NAME
 DATASET FILE NAME

UNLESS OTHERWISE SPECIFIED, DIMENSIONAL TOLERANCES ARE: mm [IN]

Tolerance (mm)	
0-1.5	+0.5
1.5-3.0	+1.0
3.0-6.0	+1.5
6.0-12.0	+2.0
12.0-25.0	+3.0

MATERIAL:
N/A

DRAWING NUMBER:
P36G34M_DC

BY	DATE	CHK	SCALE	SHEET	SIZE
WAC	11/10/2021	-	NTS	SHEET 2 OF 2	B