

THIS COPY IS PROVIDED ON A RESTRICTED BASIS AND IS NOT TO BE USED IN ANY WAY DETRIMENTAL TO THE INTERESTS OF PANDUIT CORP.

NOTES:

1. DIAMETER DIMENSION SHOWN FOR REFERENCE ONLY.
2. PLENUM-RATED CABLES MEET THE REQUIREMENTS OF NFPA 262. RISER-RATED CABLES MEET THE REQUIREMENTS OF UL 1666.
3. ALL MATERIALS AND COMPONENTS USED MUST MEET THE MATERIAL RESTRICTIONS OF RoHS (EUROPEAN DIRECTIVE 2011/65/EC ON THE RESTRICTION OF HAZARDOUS SUBSTANCES) AS PROPOSED BY THE RoHS TECHNICAL ADAPTATION COMMITTEE.

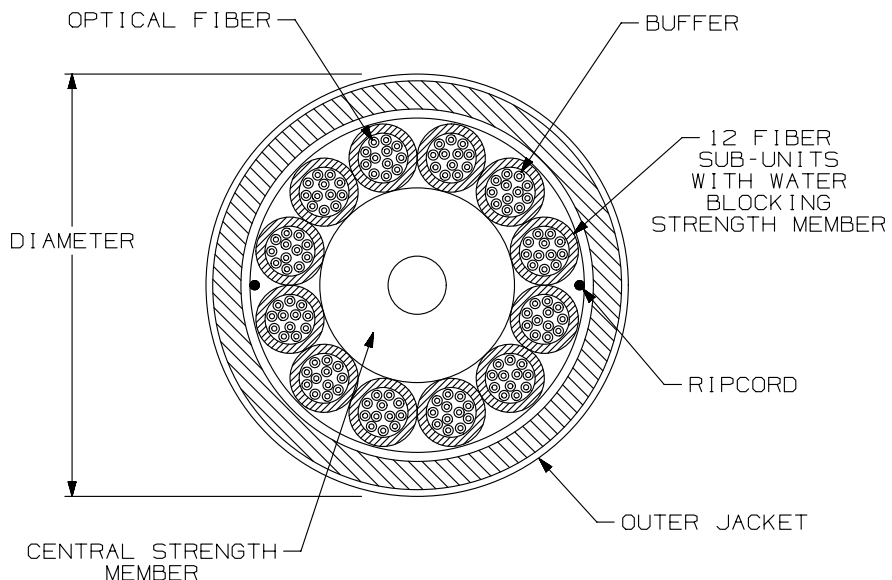

RISER RATED			
TENSILE LOAD		BEND RADIUS	
INSTALLATION	LONG TERM	INSTALLATION	LONG TERM
600 lbs (2670 N)	180 lbs (800 N)	20.4 in (51.9 cm)	10.2 in (25.9 cm)
CABLE DIAMETER (REFERENCE ONLY)	TEMPERATURE		
	STORAGE/OPERATION		INSTALLATION
1.02" [25.9 mm]	-40° F TO +176° F [-40° C TO +80° C]		14° F TO +140° F [-10° C TO +60° C]

00	02-04-14	SAT	WMA	TCB	RELEASED TO PRODUCTION				M02055JC-DC			
REV	DATE	BY	CHK	APR	DESCRIPTION	ECN	DRAWN BY	DATE	CHK	SCALE	SHT 1 OF 2	SIZE

TITLE		
144 FIBER INDOOR/OUTDOOR CABLE WITH 900um BUFFERED FIBERS		
CUSTOMER DRAWING		
ITEM REVISION NAME	M02055JC/00	
DATASET FILE NAME	M02055JC_DC/00A	PART NO. SEE TABLE DRAWING NUMBER: M02055JC-DC
UNLESS OTHERWISE SPECIFIED, DIMENSIONAL TOLERANCES ARE: IN (mm)		
.x ±	.xxx ± .010 (0.3)	
.xx ± .03 (0.8)	ANGLES ±	
THIRD ANGLE PROJECTION		
DRAWN BY	DATE	SCALE
SAT	02-04-14	WMA NONE

2

1

THIS COPY IS PROVIDED ON A RESTRICTED BASIS AND IS NOT TO BE USED IN ANY WAY DETRIMENTAL TO THE INTERESTS OF PANDUIT CORP.

PART NO.	DESCRIPTION	FLAME RATING	CABLE ATTENUATION
FSLR51A	MULTIMODE 50/125 OM2 INDOOR/OUTDOOR CABLE	OFNR	3.5dB/km @ 850nm 1.5dB/km @ 1300nm
FSLR61A	MULTIMODE 62.5/125 OM1 INDOOR/OUTDOOR CABLE	OFNR	3.5dB/km @ 850nm 1.5dB/km @ 1300nm
FOLRX1A	MULTIMODE 50/125 OM3 INDOOR/OUTDOOR CABLE	OFNR	3.5dB/km @ 850nm 1.5dB/km @ 1300nm
FOLRZ1A	MULTIMODE 50/125 OM4 INDOOR/OUTDOOR CABLE	OFNR	3.5dB/km @ 850nm 1.5dB/km @ 1300nm
FSLR91A	SINGLEMODE 9/125 INDOOR/OUTDOOR CABLE	OFNR	0.7dB/km @ 1310nm 0.7dB/km @ 1550nm

B

B

A

A

										TITLE	144 FIBER INDOOR/OUTDOOR CABLE WITH 900 μ m BUFFERED FIBERS CUSTOMER DRAWING			
										ITEM REVISION NAME	M02055JC/00	PANDUIT		
										DATASET FILE NAME	M02055JC_DC/00A			
										UNLESS OTHERWISE SPECIFIED, DIMENSIONAL TOLERANCES ARE: IN (mm)				
										.x \pm .xxx \pm .010 (0.3)	PART NO. SEE TABLE			
										.xx \pm .03 (0.8) ANGLES \pm	DRAWING NUMBER: M02055JC-DC			
00	02-04-14	SAT	WMA	TCB	RELEASED TO PRODUCTION				M02055JC-DC	 THIRD ANGLE PROJECTION				
REV	DATE	BY	CHK	APR	DESCRIPTION				ECN	DRAWN BY	DATE	CHK	SCALE	SIZE
										SAT	02-04-14	WMA	NONE	A

2

1

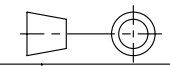

THIRD ANGLE PROJECTION