

RETROFIT KIT INFORMATION				
TOOL	CROSS SECTION AREA AWG (mm ²)	DIN COLOR CODE	KIT PART NUMBER	KIT ORDER #
CP-991	24/22 (0.25/0.34)	yellow/ turquoise	CP-991-KIT025	010799
	20 (0.5)	white		INCLUDED IN CP-991
	18 (0.75)	gray		
	(1)	red		
	16 (1.5)	black		
	14 (2.5)	blue	CP-991-KIT25	010798
	12 (4)	gray	CP-991-KIT4	010801
CP-992	12 (4)	gray	CP-992-KIT4	010797
	10 (6)	yellow	CP-992-KIT6	010802
	8 (10)	red	CP-992-KIT10	010803

NOTES, UNLESS OTHERWISE SPECIFIED:

EACH RETROFIT KIT NEEDS TO BE APPLIED FOR ITS CORRESPONDING GAGE WIRE.
SOME OF THE KITS MIGHT NOT AVAILABLE WITHIN BASIC CP-991 AS THE TABLE SHOWS.
THERE IS NO KIT AVAILABLE WITH BASIC CP-992.

REV	DATE	BY	CHK	APR	DESCRIPTION	ECN	TITLE KITS OF CP-991 & CP-992 BOWL FEEDER FERRULE CRIMP PRESS CUSTOMER DRAWING				
							ITEM REVISION NAME 00090FSA/01				
							DATASET FILE NAME 00090FSA_DC/01A				
01A	7/21/2022	JBN	BRHA	JADE	REVISED KIT ORDER NUMBERS: CP-991-KIT025 TO 010799 WAS 006646; CP-991-KIT25 TO 010798 WAS 006645; CP-991-KIT4 TO 010801 WAS 006650; CP-992-KIT4 TO 010797 WAS 006630; CP-992-KIT6 TO 010802 WAS 006813; CP-992-KIT10 TO 010803 WAS 006814 REMOVED COMPONENT P/N 008092 FROM CP-991-KIT4 (SHT 2 OF 2)	120220	UNLESS OTHERWISE SPECIFIED, DIMENSIONAL TOLERANCES ARE: IN [mm] .x ± .1 [2.54] .xxx ± .005 [.127] .xx ± .01 [.25] ANGLES ± 5 °				
00	11/30/2018	FCHE	TMR	TGS	RELEASED INTO PRODUCTION	041964	THIRD ANGLE PROJECTION				
							DRAWING NUMBER: 00090FSA_DC				
							DRAWN BY FCHE	DATE 11/30/2018	CHK TMR	SCALE N/A	SIZE B

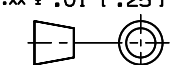

D101000B/17



THIS COPY IS PROVIDED ON A RESTRICTED BASIS AND IS NOT TO BE USED IN ANY WAY DETRIMENTAL TO THE INTERESTS OF PANDUIT CORP.

CP-991-KIT025	
P/N	Description
006602	Feeder bowl 0.25 mm2
004752	Pressure reducer
006653	Separator plate 0.25 mm2
006597	Sleeve receiver 0.25 mm2
006604	Cord-centering funnel 0.25 mm2
004755	Reversing base sleeve 0.25 mm2
008094	Crimping jaws 0.25 mm2

CP-991-KIT25	
P/N	Description
008989	Feeder bowl 2.5 mm2
006655	Separator plate 2.5 mm2
006393	Sleeve receiver 2.5 mm2
006605	Cord-centering funnel 2.5 mm2
004758	Reversing base sleeve 2.5 mm2

CP-991-KIT4	
P/N	Description
006603	Feeder bowl 4 mm2
006656	Separator plate 4 mm2
006598	CP 991 Sleeve receiver 4 mm2
006522	Cord-centering funnel 4 mm2
004758	Reversing base sleeve 4 mm2
003843	CP 992 Blade holder
003371	Blade 4 mm2
008953	Crimping jaws 4 mm2 length 12 mm

CP-992-KIT10	
P/N	Description
006652	Feeder bowl 10 mm2
006658	Separator plate 10 mm2
006515	Sleeve receiver 10 mm2
003835	Cord-centering funnel 10 mm2
006658	Reversing base sleeve 10 mm2
003843	CP 992 Blade holder
003842	Blade 10 mm2
008956	Crimping jaws 10 mm2

CP-992-KIT6	
P/N	Description
006651	Feeder bowl 6 mm2
006657	Separator plate 6 mm2
006414	Sleeve receiver 6 mm2
006659	Cord-centering funnel 6 mm2
004757	Reversing base sleeve 6 mm2
003843	CP 992 Blade holder
003841	Blade 6 mm2
008955	Crimping jaws 6 mm2

CP-992-KIT4	
P/N	Description
006603	Feeder bowl 4 mm2
006656	Separator plate 4 mm2
006513	CP 992 Sleeve receiver 4 mm2
006522	Cord-centering funnel 4 mm2
004758	Reversing base sleeve 4 mm2
003843	CP 992 Blade holder
003371	Blade 4 mm2
008092	Crimping jaws 4 mm2 length 10 mm
008953	Crimping jaws 4 mm2 length 12 mm

NOTES, UNLESS OTHERWISE SPECIFIED:
SEE SHEET 1 FOR REVISION BLOCK.

TITLE					KITS OF CP-991 & CP-992 BOWL FEEDER FERRULE CRIMP PRESS CUSTOMER DRAWING				
ITEM REVISION NAME					00090FSA/01				
DATASET FILE NAME					00090FSA_DC/01A				
UNLESS OTHERWISE SPECIFIED, DIMENSIONAL TOLERANCES ARE: IN [mm]					MATERIAL: N/A				
.x ± .1 [2.54]		.xxx ± .005 [.127]		.xx ± .01 [.25]		ANGLES ± 5 °		DRAWING NUMBER: 00090FSA_DC	
		THIRD ANGLE PROJECTION		SCALE		SHT 2 OF 2		SIZE B	
DRAWN BY	DATE	CHK	SCALE	SHT 2 OF 2		SIZE		B	
FCHE	11/30/2018	TMR	N/A	SHT 2 OF 2		SIZE		B	



D10100DB/17