

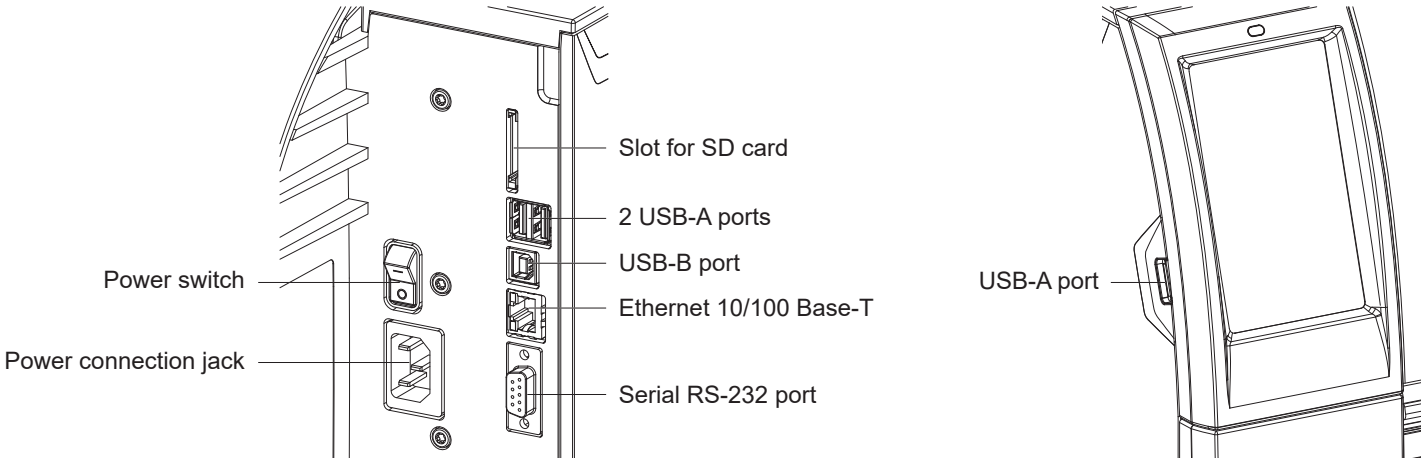

**Printer Overview**

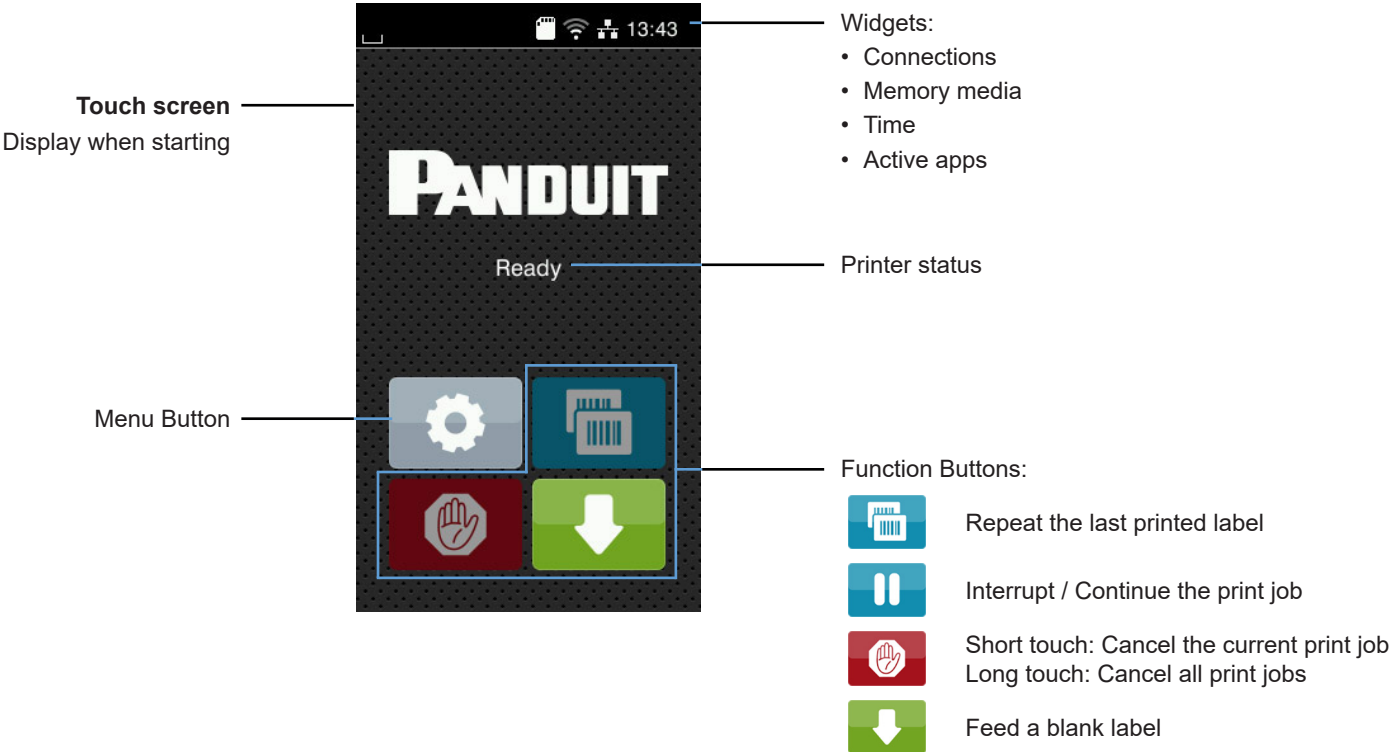
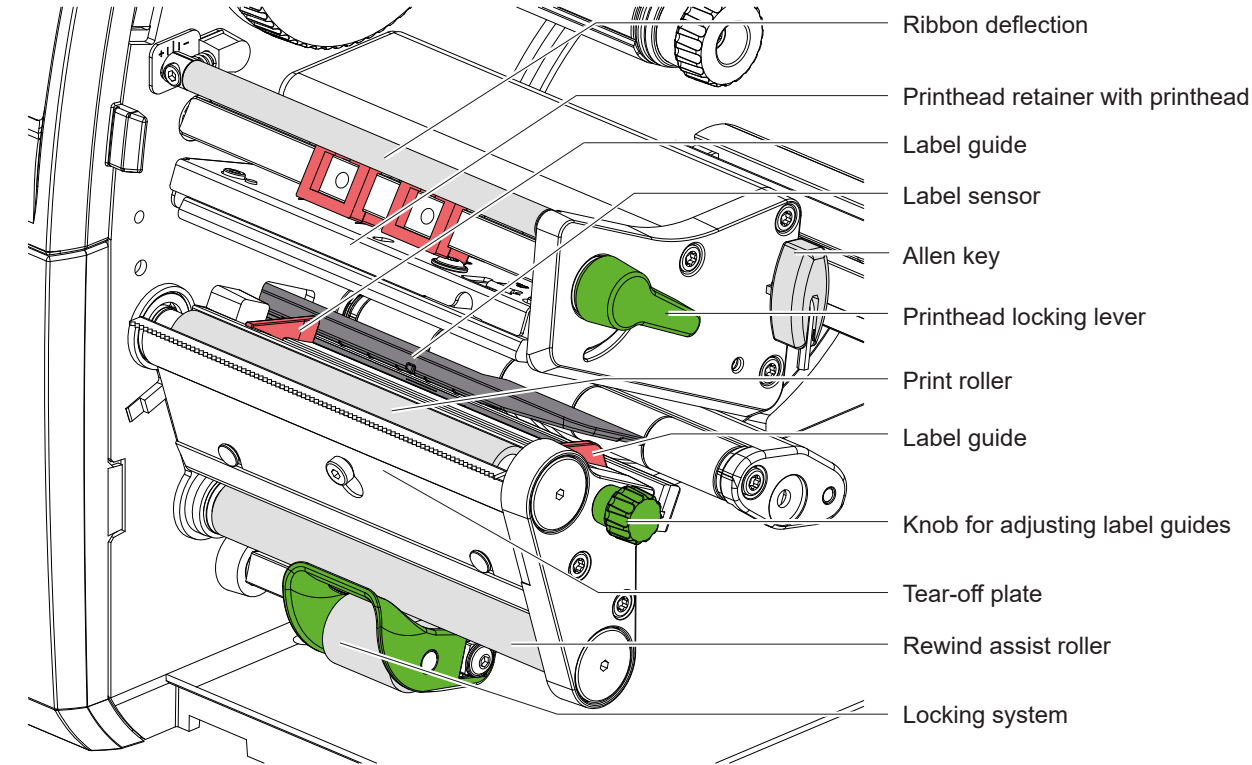
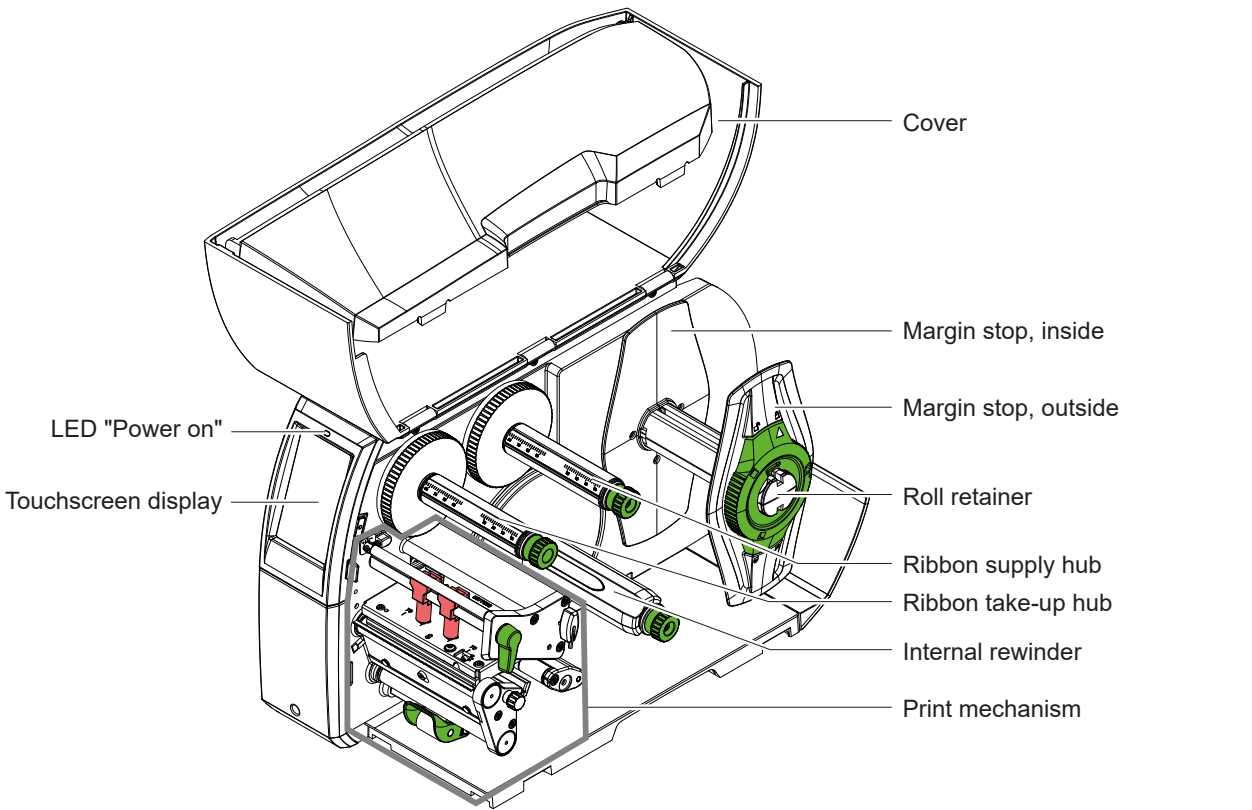
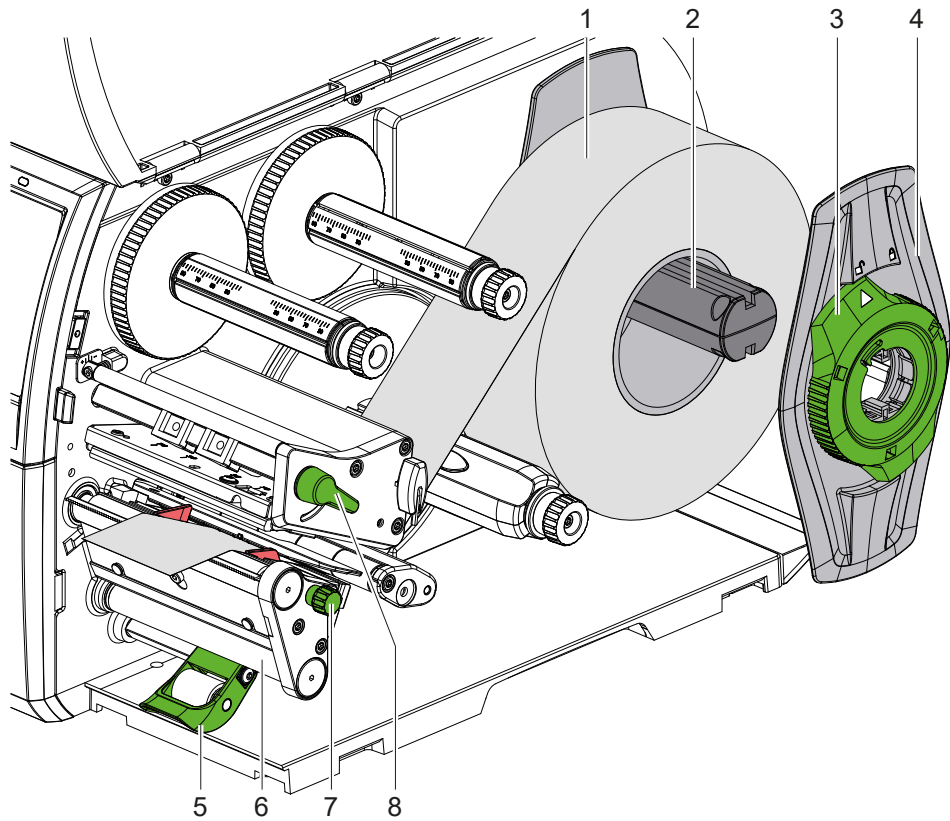

- USB-A ports can be used for:
- Keyboard
  - Scanner
  - USB memory stick
  - USB WiFi stick
  - Service key

**Loading label material**



1. Turn ring (3) at the margin stop (4) counterclockwise, so that the arrow points to the symbol .
2. Remove the margin stop (4) from the roll retainer (2).
3. Turn lever (8) counterclockwise to lift the printhead.
4. Load label roll (1) on the roll retainer (2) in such a way that the labels can be inserted into the printhead in the right position. The printing side of the labels must be visible from above.

5. Re-mount the margin stop (4) onto the roll retainer (2). Push the margin stop (4) to the roll (1) until the roll touches both margin stops and a clear resistance is encountered.
6. Turn ring (3) clockwise, so that the arrow points to the symbol .
7. Guide the label material through the printer.
8. Move guides against the edges of the material by turning the knob (7).
9. Lift the pinch roller (5) off the rewind assist roller (6).

**Setting the Label Sensor**

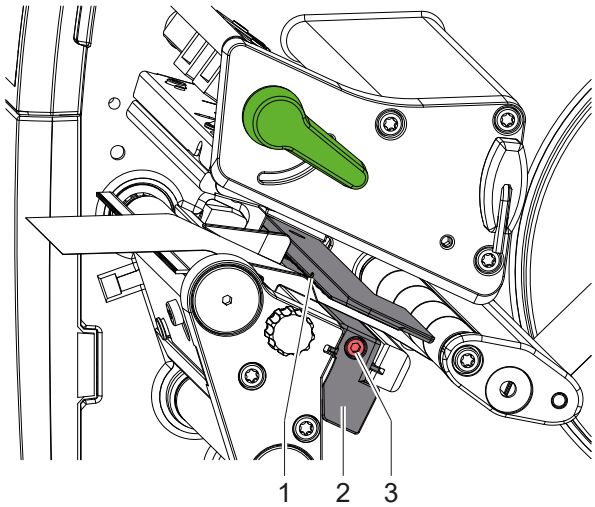

1. Loosen screw (3).
2. Position label sensor with tab (2) in such a way that the sensor (1) can detect the label gap.
3. Align label sensor using the tab (2) with the front edge of the label in the direction of paper flow.
4. Tighten screw (3).

**Loading Transfer Ribbon**

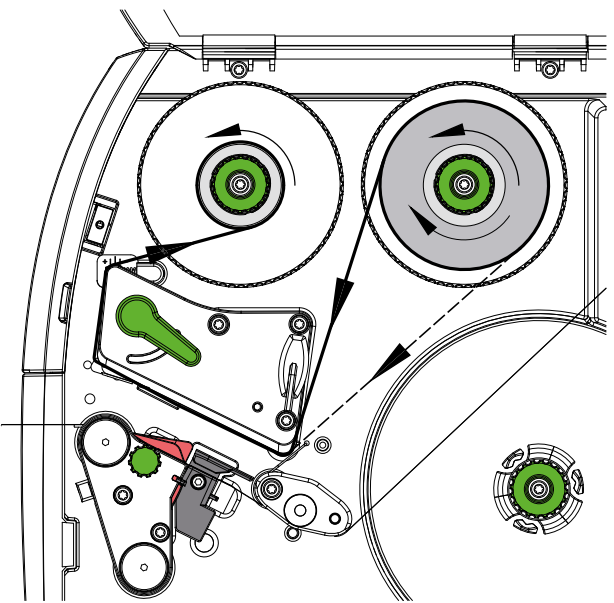
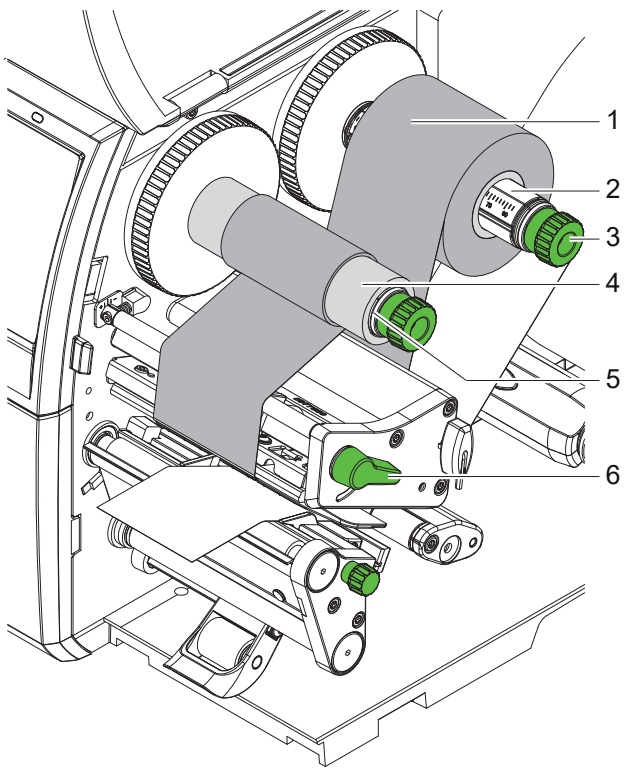

Transfer ribbon feed path

1. Turn lever (6) counterclockwise to lift the printhead.
2. Slide ribbon roll (1) onto the ribbon supply hub (2) so that the color coating of the ribbon faces downward when being unwound.
3. Center the ribbon roll.
4. Hold ribbon roll (1) firmly and turn knob on ribbon supply hub (3) counterclockwise until the ribbon roll is secured.
5. Slide suitable ribbon core (4) onto the ribbon take-up hub (5) and secure.
6. Guide ribbon through the print unit.
7. Secure starting end of ribbon to the ribbon core (4) with adhesive tape. Ensure counterclockwise rotation direction of the ribbon take-up hub here.
8. Turn ribbon take-up hub (5) counterclockwise to smooth out the feed path of the ribbon.
9. Turn lever (6) clockwise to lock the printhead.